

- Notes:
1. Coordinates are in terms of New Zealand Transverse Mercator 2000 (NZTM).
 2. All seaward boundaries follow Mean Low Water Springs but cross the mouths of all rivers, streams, inlets and estuaries except where shown otherwise.
 3. Where a boundary is shown along a river or road it follows the middle line of the physical river or legal road unless otherwise shown.

Land District: Wellington

WELLINGTON CITY TAKAPŪ/NORTHERN WARD

TERRITORIAL AUTHORITY: Wellington City
 Compiled by Jacobs New Zealand Limited
 Scale 1:60,000 at A3 Date August 2019

LG-047-2019-W-2
Sheet 1 of 2

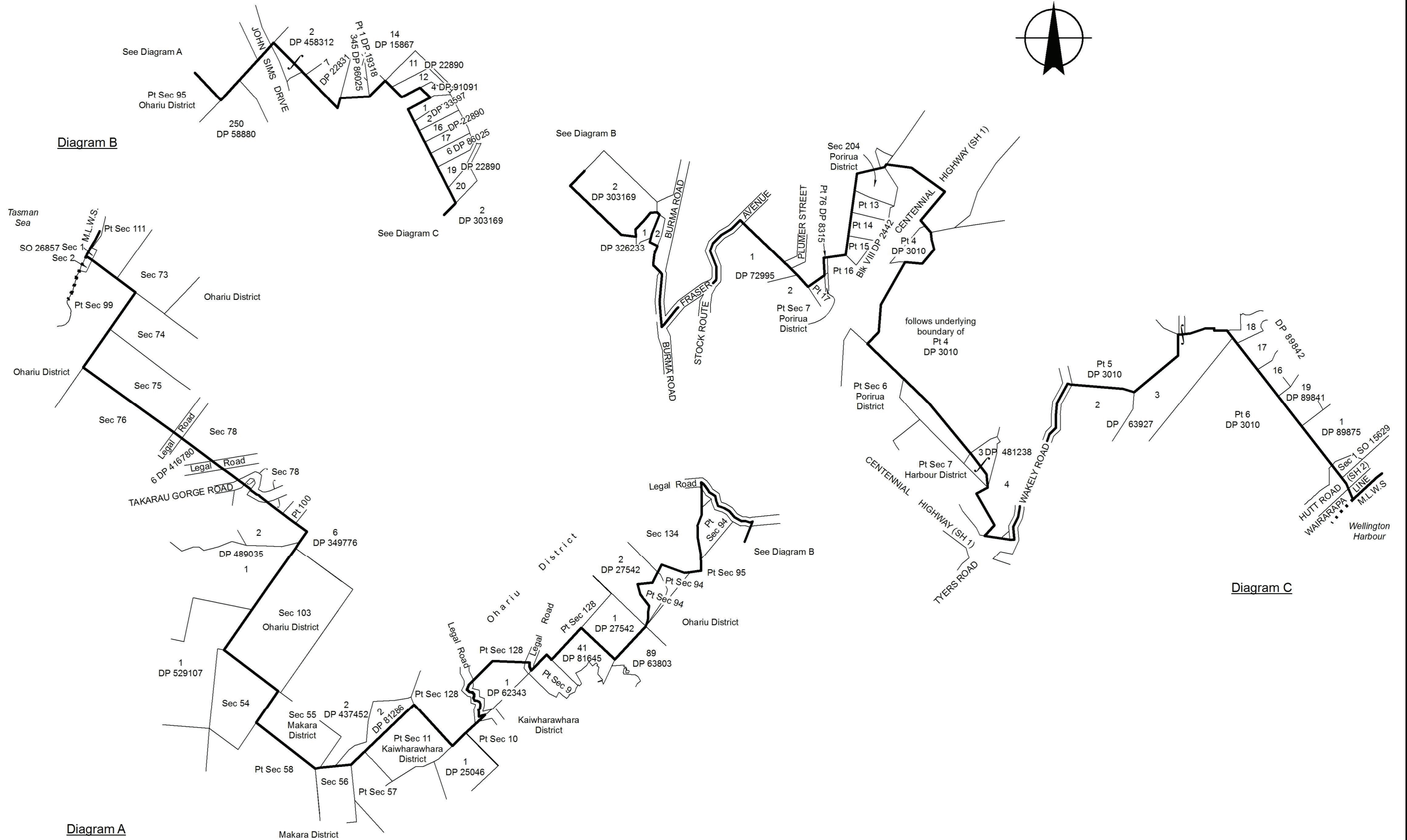
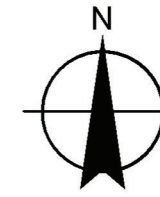

Diagram B

Diagram A

Diagram C

Land District: Wellington

WELLINGTON CITY TAKAPŪ/NORTHERN WARD

TERRITORIAL AUTHORITY: Wellington City
 Compiled by Jacobs New Zealand Limited
 Not to scale Date August 2019

LG-047-2019-W-2
 Sheet 2 of 2