

**PORIRUA CITY
LG-044-2012-W-1**



Notes:

1. Coordinates are in terms of New Zealand Transverse Mercator 2000 (NZTM).
2. Where a boundary is shown along a river or road it follows the middle line of the physical river or legal road unless otherwise shown.

**TAWA
COMMUNITY**

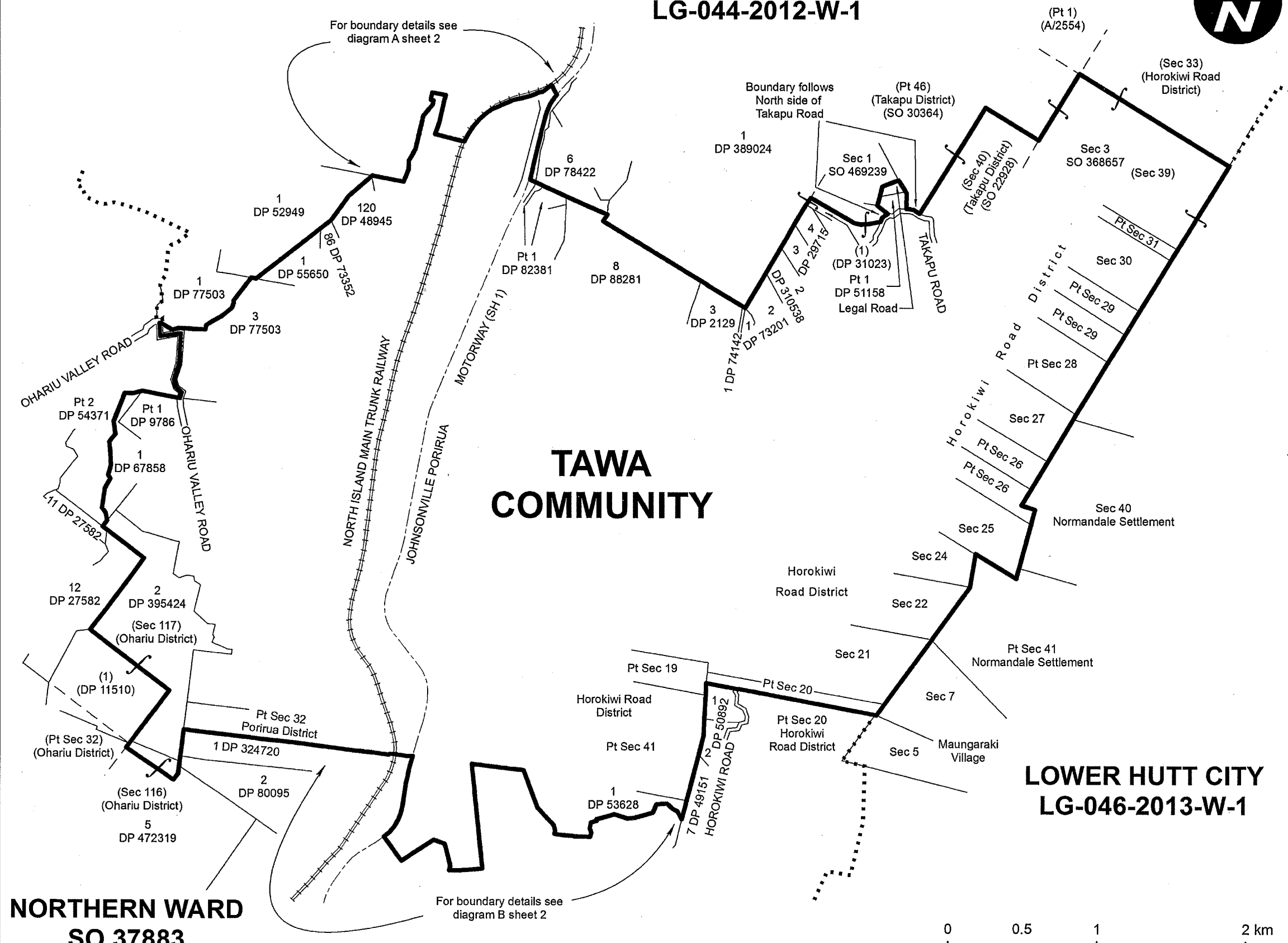

**NORTHERN WARD
SO 37883**

**LOWER HUTT CITY
LG-046-2013-W-1**

Land District: Wellington

**WELLINGTON CITY
TAWA COMMUNITY**

TERRITORIAL AUTHORITY: Wellington City
Compiled by Jacobs New Zealand Limited
Scale 1:27,500 at A3 Date: November 2015

LG-047-2015-Com-1
Sheet 1 of 2

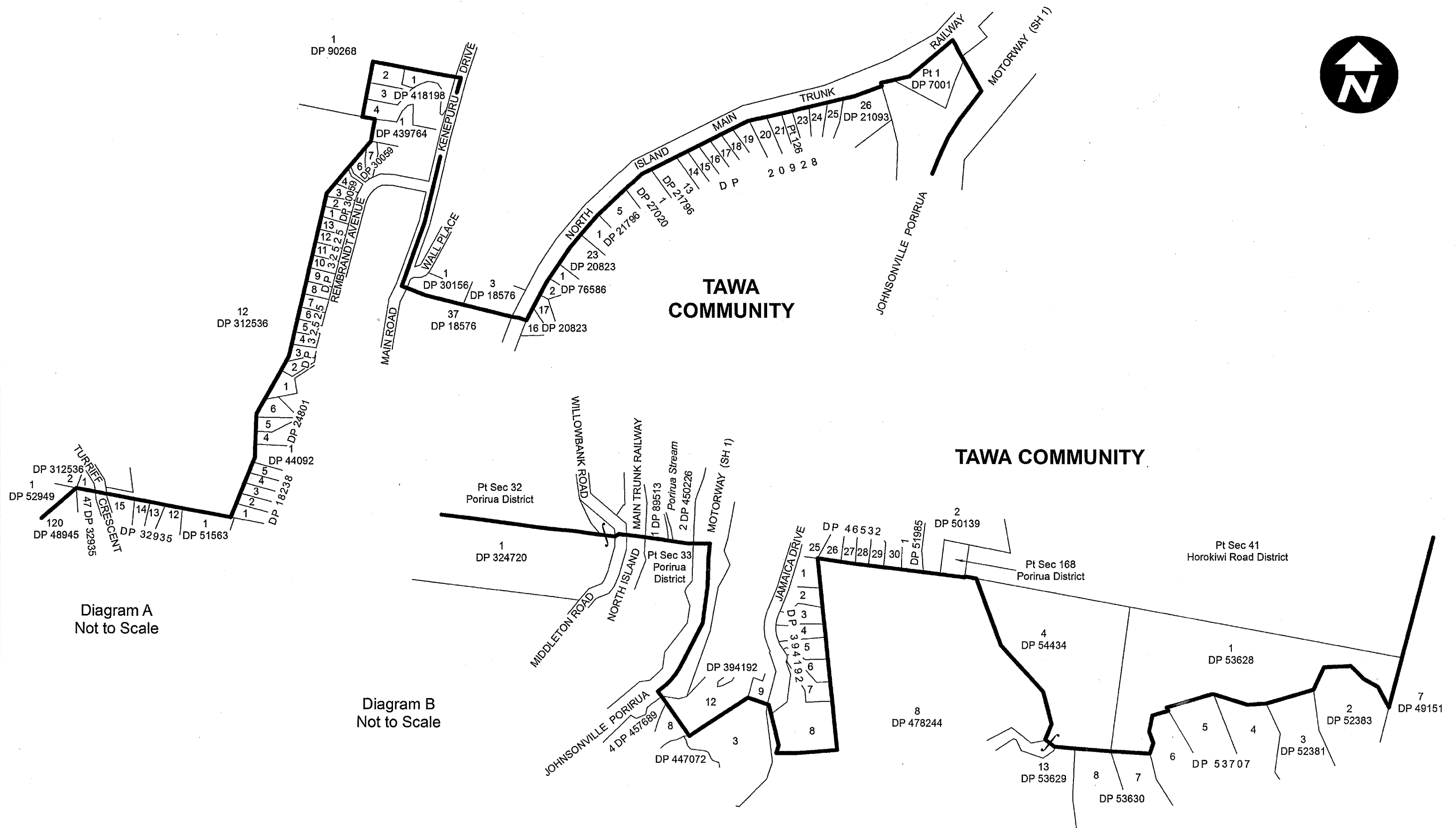

Diagram A
Not to Scale

Diagram B
Not to Scale

I certify that the plan numbered LG-047-2015-Com-1 renders the boundaries capable of identification for the purposes of section 19Y(3)(b) of the Local Electoral Act 2001.

A Nicoll 1 / 12 / 2015

Alasdair Nicoll

Technical Advisor-Survey, Land Information New Zealand

Pursuant to a delegation from the Surveyor-General under section 8 of the Cadastral Survey Act 2002.

I certify that the boundaries shown on the plan numbered LG-047-2015-Com-1 are the same as the boundaries determined by the Local Government Commission on 25 September 2015 pursuant to section 19JA of the Local Electoral Act 2001.

The plan LG-047-2015-Com-1 replaces the following existing plan: SO 37411.

[signed] 

20 10 2015
Donald Riezebos
Principal Advisor
Local Government Commission