

Approvals
 NOTE: Where a boundary is shown along a river or road it follows the middle line of the physical river or legal road unless otherwise shown.
 For full description of adjoining sections refer to plans shown.

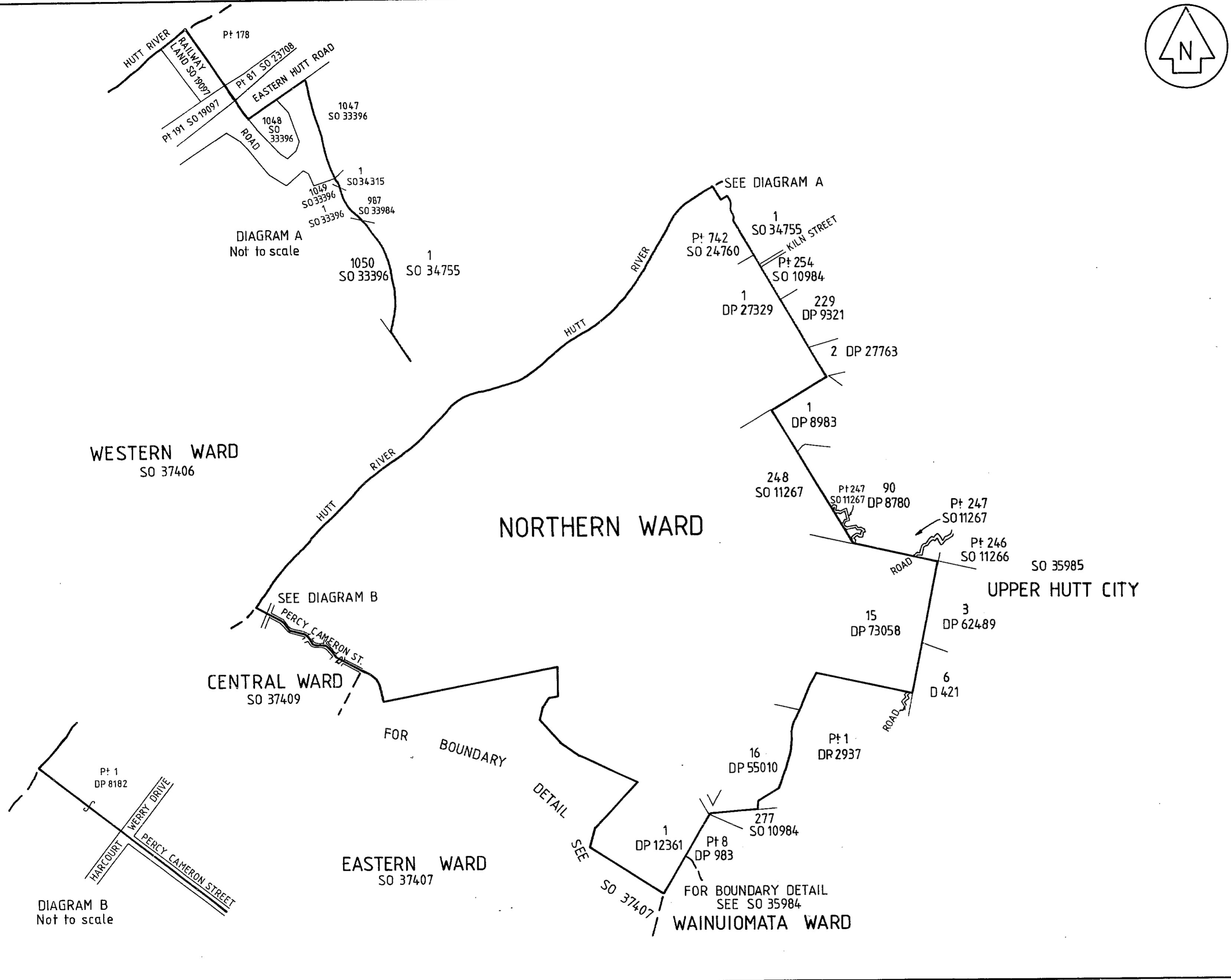

For earlier Ward plans of Northern Ward see SO 35980.

Total Area

Comprised in

I,
 Registered Surveyor and holder of an annual practising certificate (or who may act as a registered surveyor pursuant to section 25 of the Survey Act 1986) hereby certify that this plan has been made from surveys executed by me or under my directions, that both plan and survey are correct and have been made in accordance with the Survey Regulations 1972 or any regulations made in substitution thereof.
 Dated at this day
 of 19 Signature

Field Book p. Traverse Book p.

Reference Plans

Examined Correct

I certify that for the purposes of Section 101M (3) (b) Local Government Act 1974, this plan renders the boundaries of the Northern Ward capable of identification.

28/3/1995
 Chief Surveyor

File 6500-05-C/3546
 Received
 Instructions 672899
SO 37405

LAND DISTRICT Wellington
 Survey Blk. & Dist.
 NZMS 261 Sheet R.27 Record Map No.

NORTHERN WARD

TERRITORIAL AUTHORITY LOWER HUTT CITY
 Surveyed by Dept. of Survey & Land Info.
 Scale 1:25000 Date MARCH 1995