

- Notes:
1. Coordinates are in terms of New Zealand Transverse Mercator 2000 (NZTM).
 2. The seaward boundary of the Wards follow Mean Low Water Springs but cross the mouths of all rivers, streams, inlets and estuaries except where shown otherwise.
 3. All adjacent islands and islets are included in the Wards.
 4. Where a boundary is shown along a river or road it follows the middle line of the river or legal road unless otherwise shown.

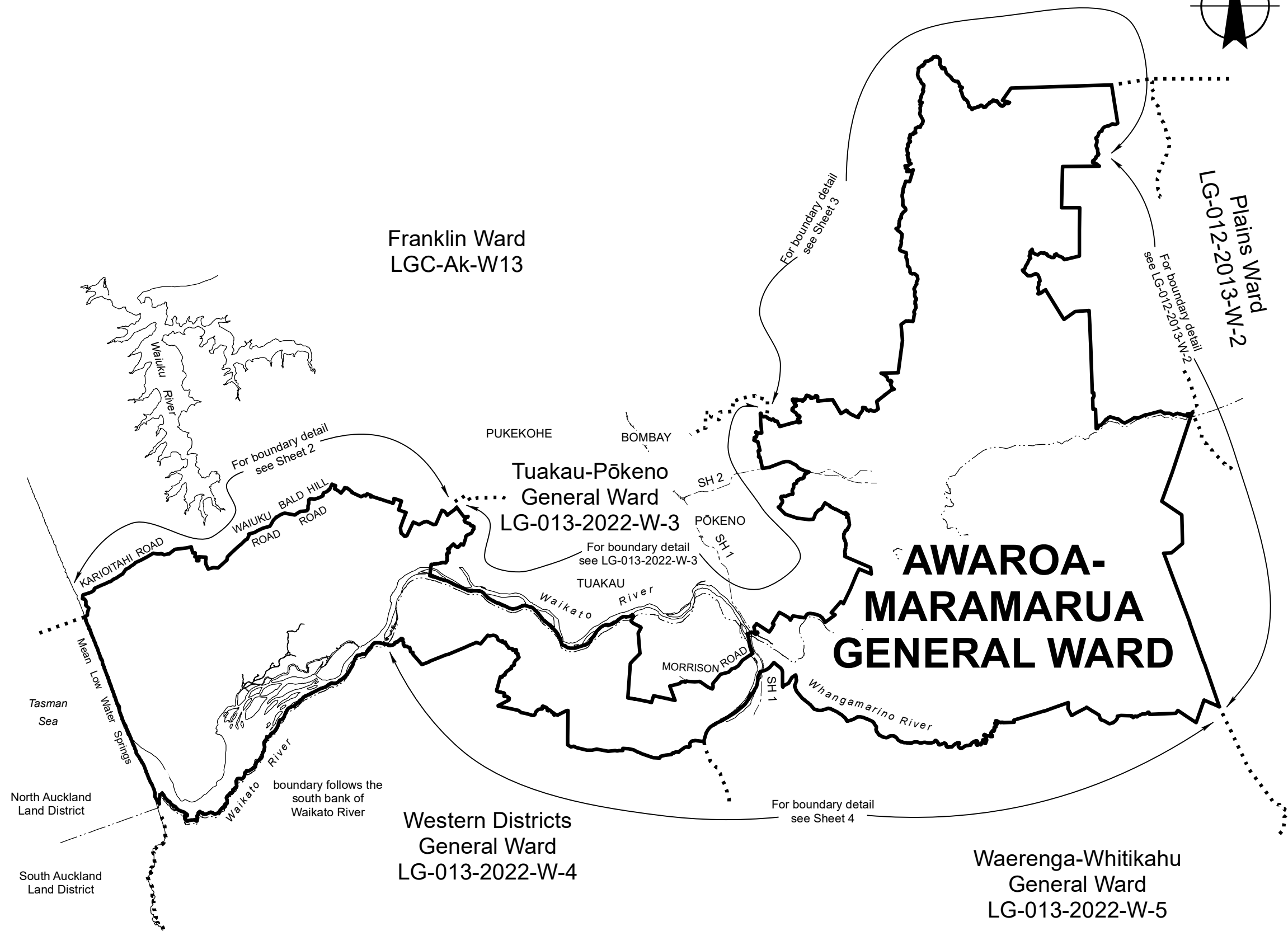

Land District: North Auckland
and South Auckland

WAIKATO DISTRICT
AWAROA-MARAMARUA GENERAL WARD

TERRITORIAL AUTHORITY: Waikato District
Compiled by Jacobs New Zealand Limited
Scale 1:225,000 at A3 Date: June 2022

LG-013-2022-W-2
Sheet 1 of 4

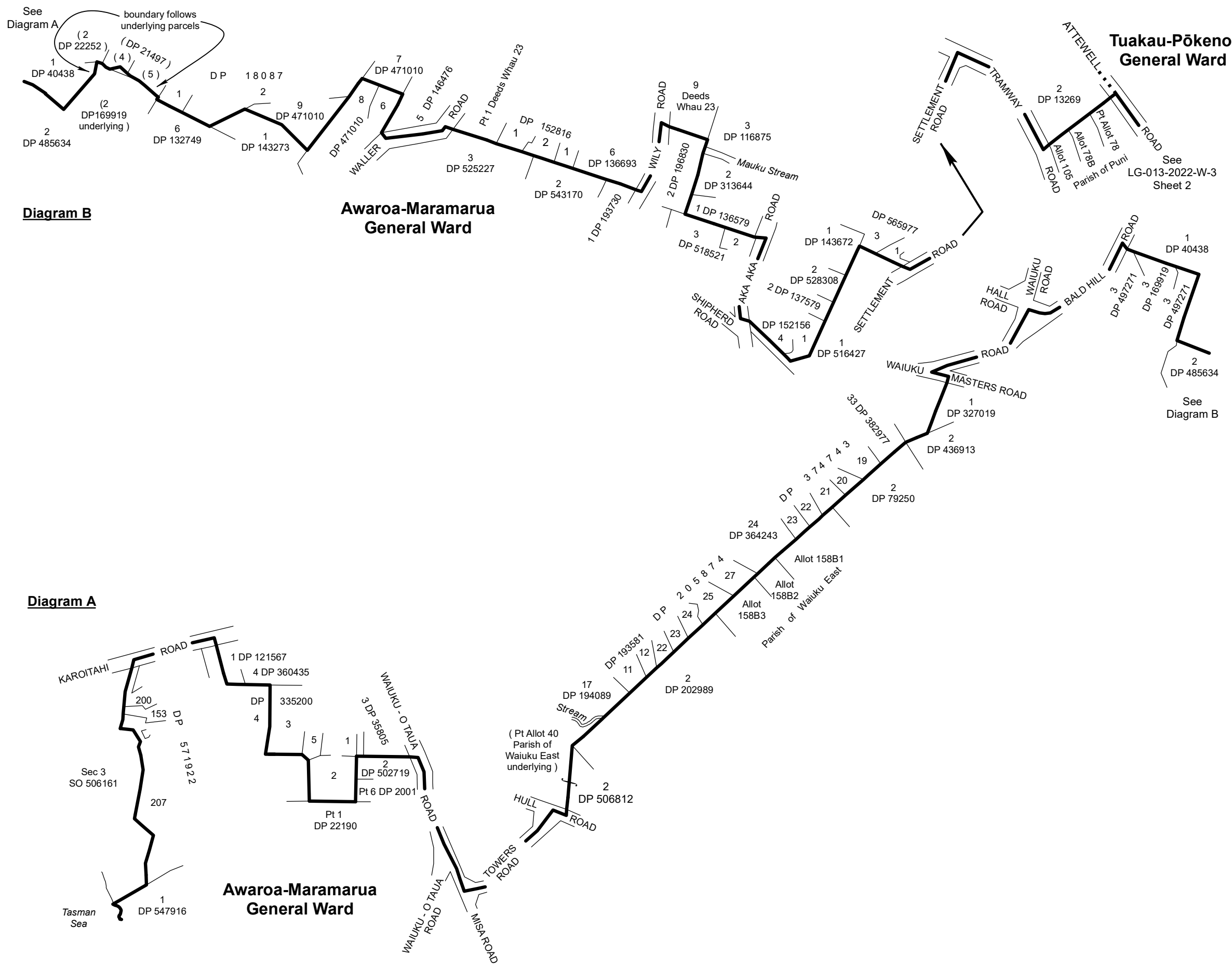
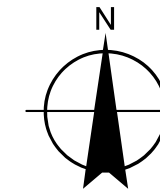

Diagram B

Diagram A

**Awaroa-Maramarua
General Ward**

**Tuakau-Pōkeno
General Ward**

**Awaroa-Maramarua
General Ward**

Land District: North Auckland
and South Auckland

WAIKATO DISTRICT AWAROA-MARAMARUA GENERAL WARD

TERRITORIAL AUTHORITY: Waikato District
Compiled by Jacobs New Zealand Limited
Not to Scale Date: June 2022

LG-013-2022-W-2
Sheet 2 of 4

File IZ049800

Notes:

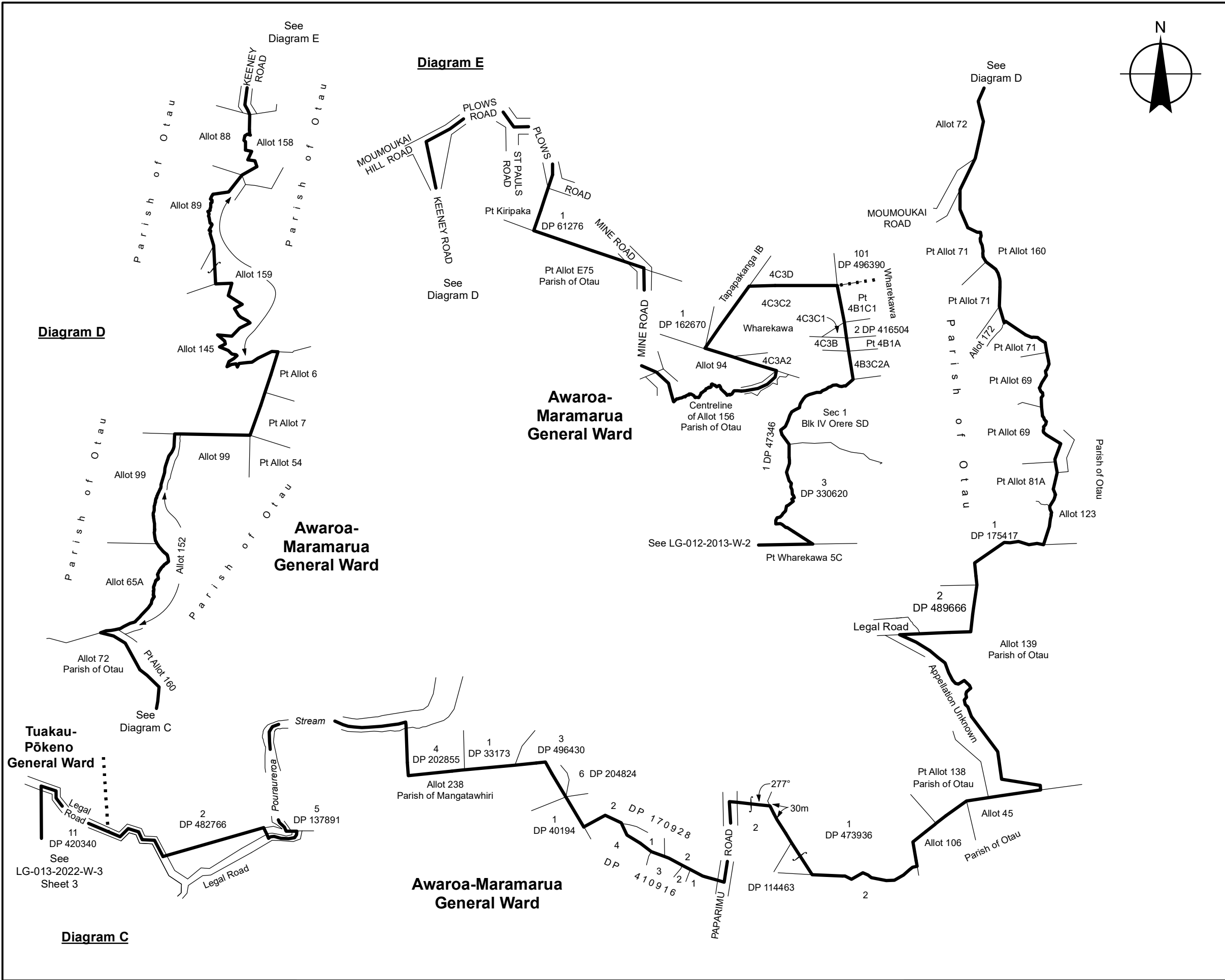
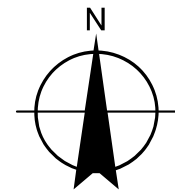

Land District: North Auckland and South Auckland

WAIKATO DISTRICT AWAROA-MARAMARUA GENERAL WARD

TERRITORIAL AUTHORITY: Waikato District
Compiled by Jacobs New Zealand Limited
Not to Scale Date: June 2022

LG-013-2022-W-2
Sheet 3 of 4

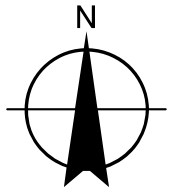
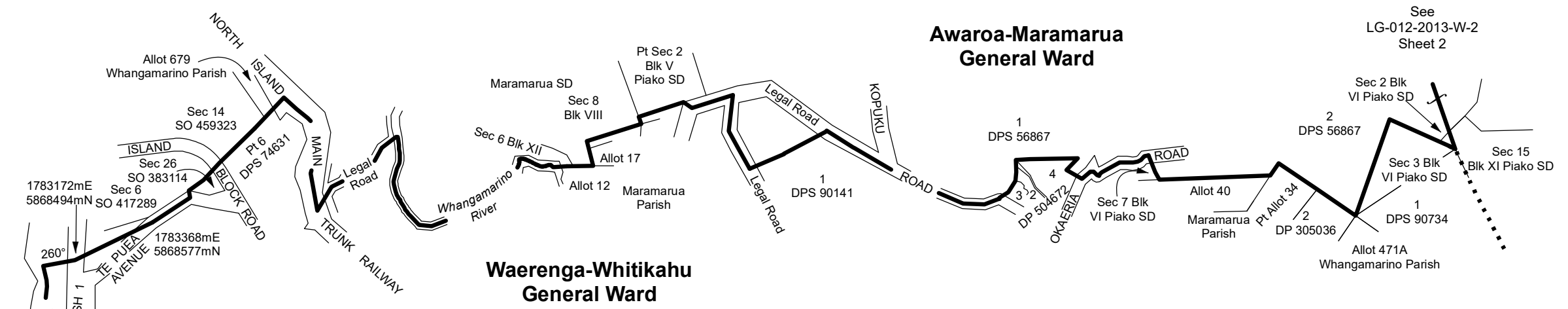

Diagram F



See Diagram G

See LG-012-2013-W-2 Sheet 2

Awaroa-Maramarua General Ward

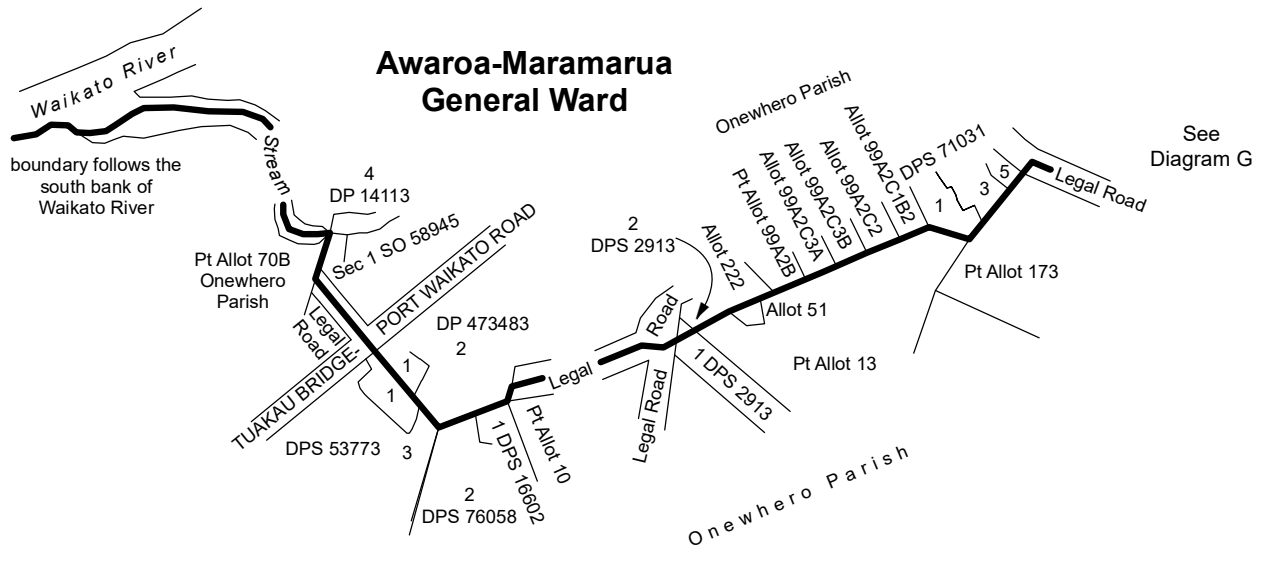

Diagram H

Western Districts General Ward

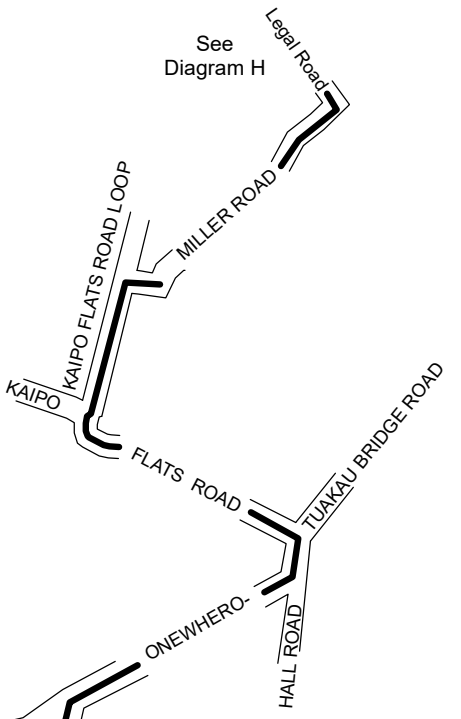
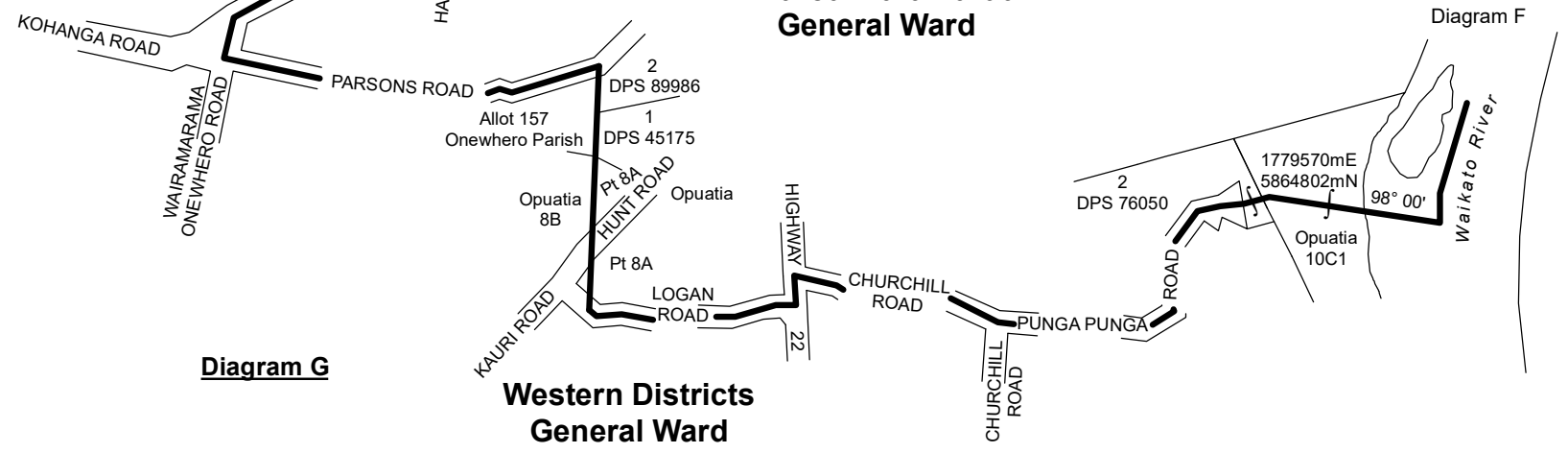

Diagram G

Awaroa-Maramarua General Ward



Western Districts General Ward

See Diagram F

Land District: North Auckland and South Auckland

**WAIKATO DISTRICT
AWAROA-MARAMARUA GENERAL WARD**

TERRITORIAL AUTHORITY: Waikato District
Compiled by Jacobs New Zealand Limited
Not to Scale Date: June 2022

LG-013-2022-W-2
Sheet 4 of 4