

SO 427008 (Title Plan)

Cpy - 01/01, Pgs - 001, 12/03/10, 10

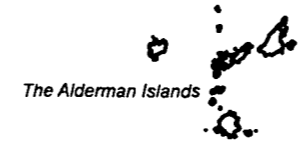

DocID: 212547563



TAIRUA-PAUANUI COMMUNITY

MERCURY BAY WARD
SO 424737

THAMES WARD
SO 60947 SA

WHANGAMATA COMMUNITY
SO 427009

HAURAKI DISTRICT
SO 57978 SA

Descriptive Plan

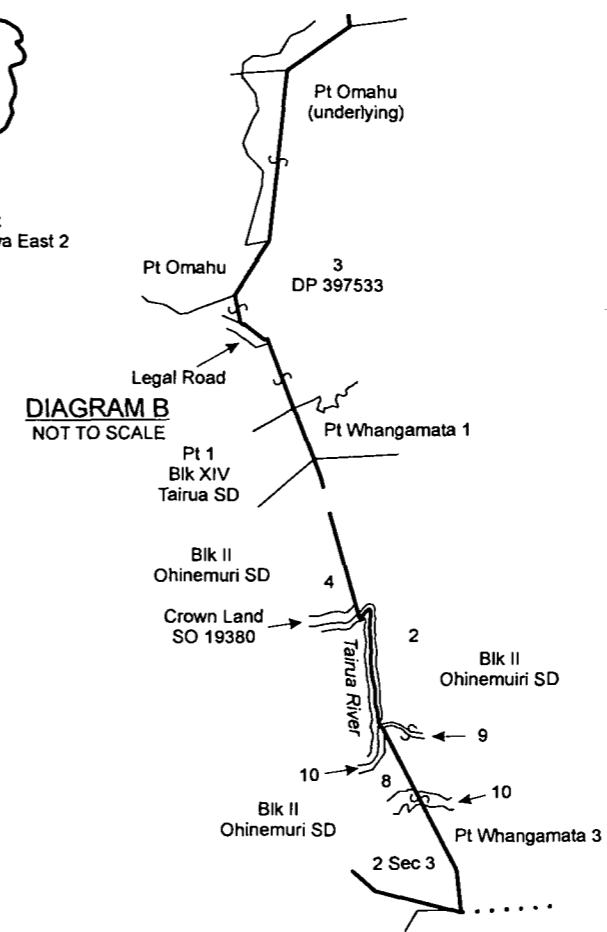
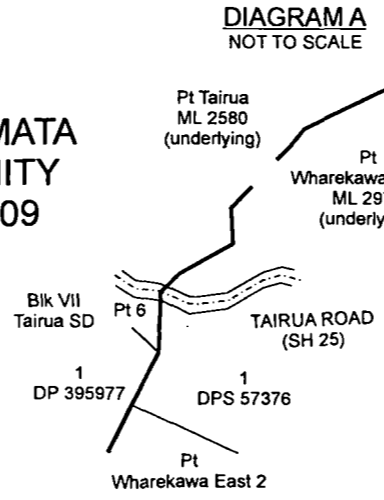
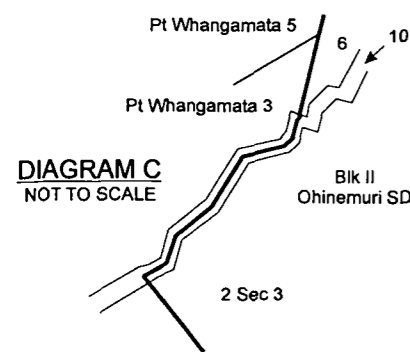

Land District : North Auckland
South Auckland

TAIRUA-PAUANUI COMMUNITY

Territorial Authority: Thames-Coromandel District
Compiled by Sinclair Knight Merz Ltd
Scale 1:150000 Date December 2009

Approvals
Where a boundary is shown along a river or road it follows the middle line of the physical river or legal road unless otherwise shown.
Where a boundary is shown along a railway it follows the middle line of the cadastral railway unless otherwise shown.
All seaward boundaries follow Mean High Water Mark but cross the mouths of all rivers, streams, inlets and estuaries unless otherwise shown.
All adjacent islands and islets are included in the Region.
Certified by the Thames-Coromandel District Council that the boundary shown hereon is the same as the boundary defined in the Thames-Coromandel District Council resolution dated 24 June 2009 pursuant to section 19Y(1) Local Electoral Act 2001.
Alan Ball 25.02.10
Thames-Coromandel District Council
I certify that this plan renders the boundary capable of identification under section 19Y(3)(b) Local Electoral Act 2001.
[Signature] 12.03.2010
for Surveyor General

Total Area _____

Comprised in: _____

I, _____, being a person entitled to practise as a licensed cadastral surveyor, certify that -

(a) The Surveys to which this dataset relates are accurate, and were undertaken by me or under my direction in accordance with the Cadastral Survey Act 2002 and the Surveyor-General's Rules for Cadastral Survey 2002/2.

(b) This dataset is accurate, and has been created in accordance with that Act and those Rules

Field Book _____ p. Traverse Book _____ p.

Reference Plans _____

Examined _____ Correct _____

Approved as to Gazettal Purposes by Land Information NZ

Deposited this _____ day of _____

_____ for Registrar-General of Land

File AE03802 Received Instructions: **SO 427008**