

Notes:

1. Coordinates are in terms of New Zealand Transverse Mercator 2000 (NZTM).
2. Where a boundary is shown along a river or road it follows the middle line of the physical river or legal road unless otherwise shown.
3. Where a boundary is shown along a railway it follows the middle line of the cadastral railway unless otherwise shown.

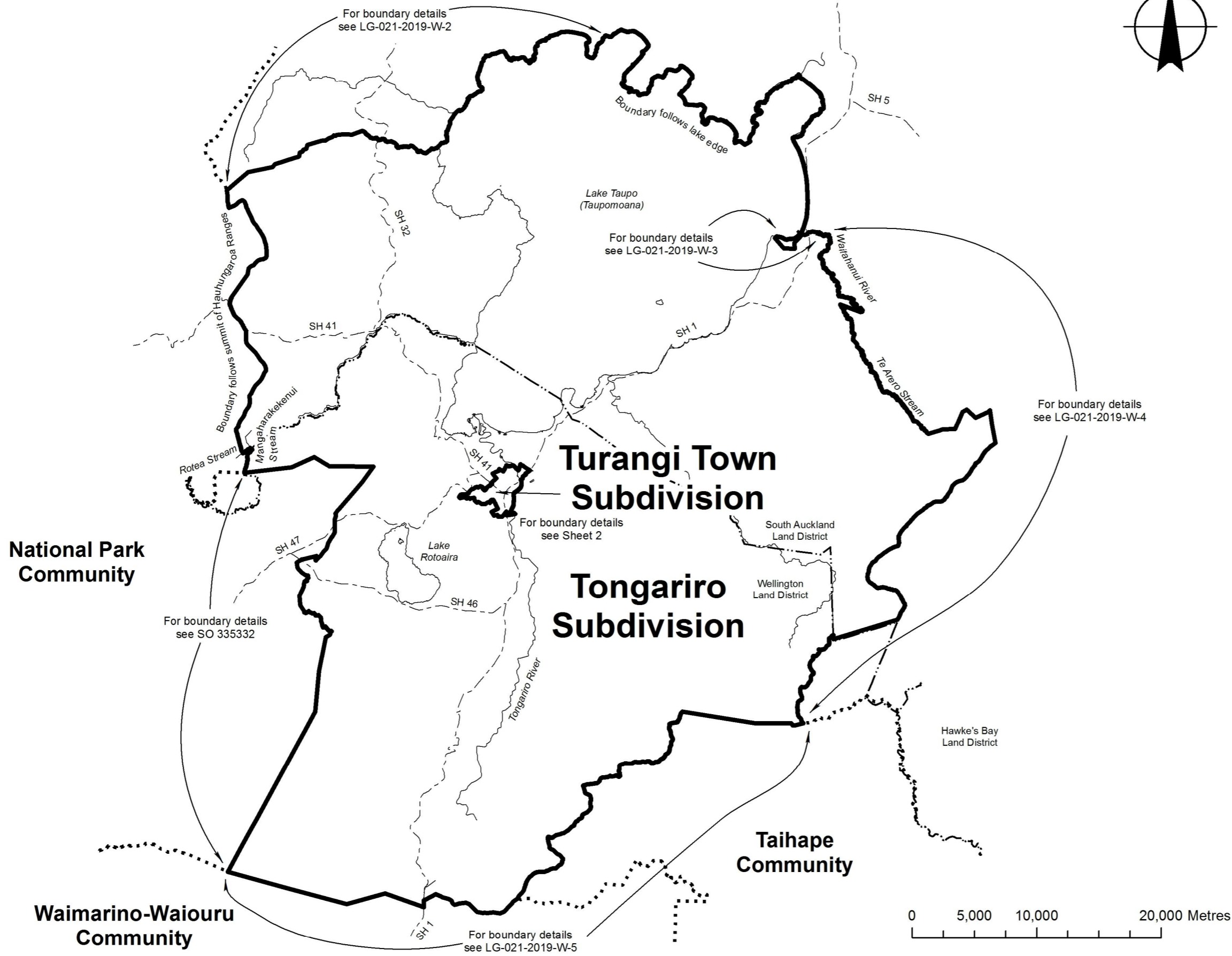

Land District: South Auckland,  
Hawke's Bay and Wellington

File IZ049800

# TAUPO DISTRICT

## TURANGI TOWN AND TONGARIRO SUBDIVISIONS

TERRITORIAL AUTHORITY: Taupo District  
Compiled by Jacobs New Zealand Limited  
Scale 1:325,000 at A3 Date: April 2019

**LG-021-2019-S-1**  
Sheet 1 of 2

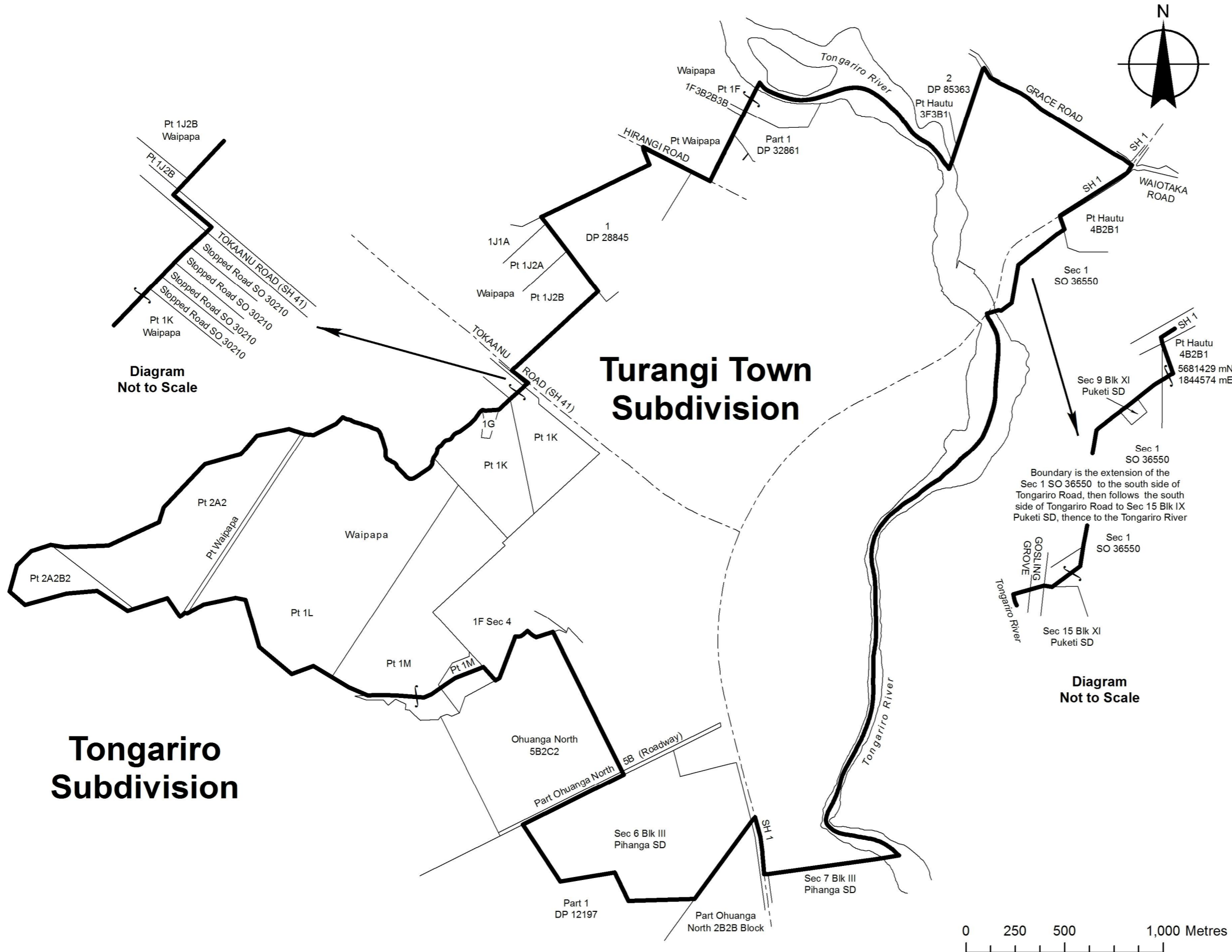

- Notes:
1. Coordinates are in terms of New Zealand Transverse Mercator 2000 (NZTM).
  2. Where a boundary is shown along a river or road it follows the middle line of the physical river or legal road unless otherwise shown.
  3. Where a boundary is shown along a railway it follows the middle line of the cadastral railway unless otherwise shown.

Diagram Not to Scale

Diagram Not to Scale

Boundary is the extension of the Sec 1 SO 36550 to the south side of Tongariro Road, then follows the south side of Tongariro Road to Sec 15 Blk IX Puketi SD, thence to the Tongariro River

Land District: South Auckland,  
Hawke's Bay and Wellington

**TAUPO DISTRICT**  
**TURANGI TOWN AND TONGARIRO SUBDIVISIONS**

TERRITORIAL AUTHORITY: Taupo District  
Compiled by Jacobs New Zealand Limited  
Scale 1:20,000 at A3 Date: April 2019

**LG-021-2019-S-1**  
Sheet 2 of 2