

KIOKIO / KORAKONUI WARD
SO 59038

SO 59039 (Title Plan)

Copy - 01/01.Pgs - 001.26/08/06.09.24



Doc ID: 51017760

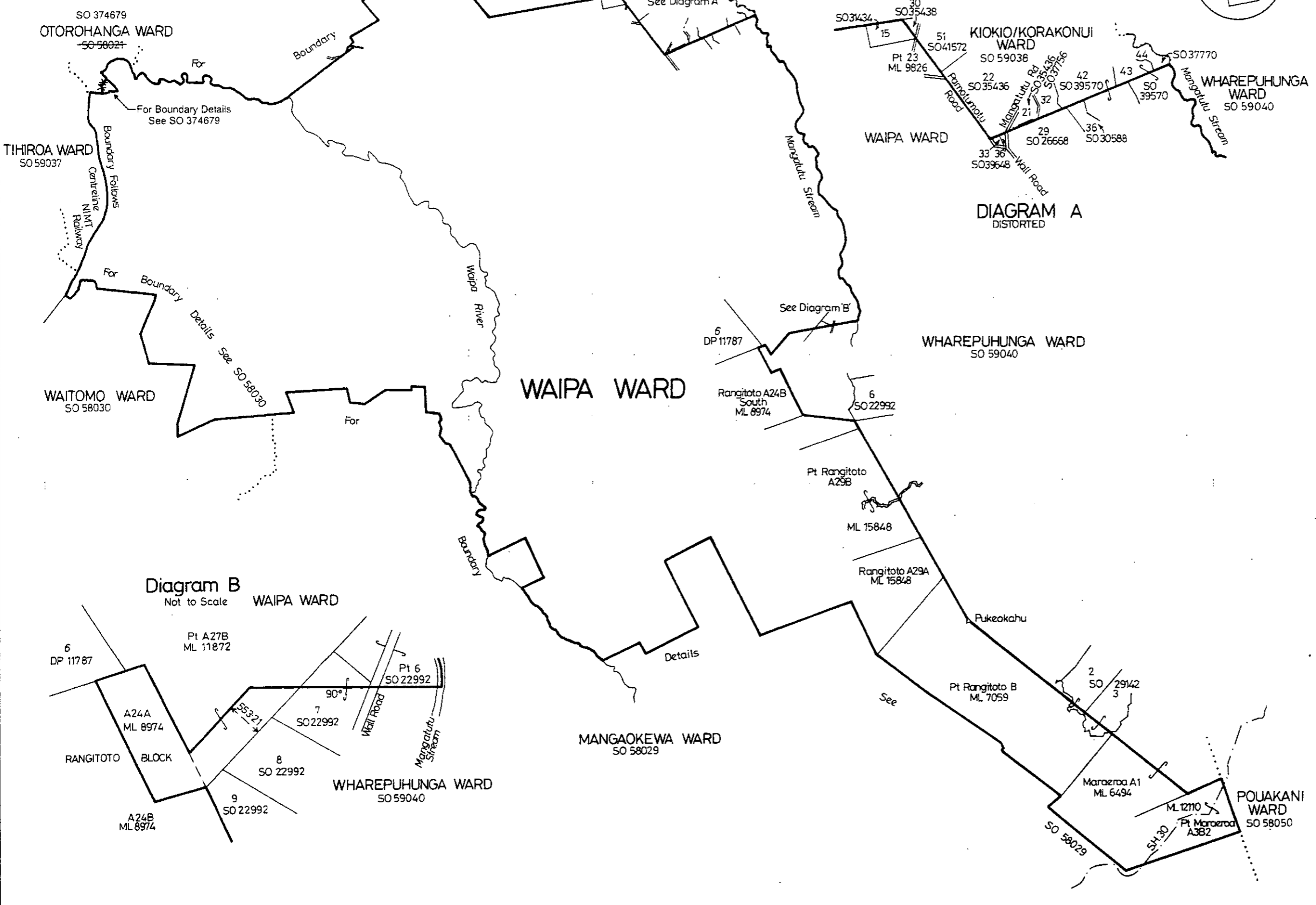
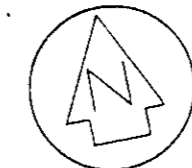
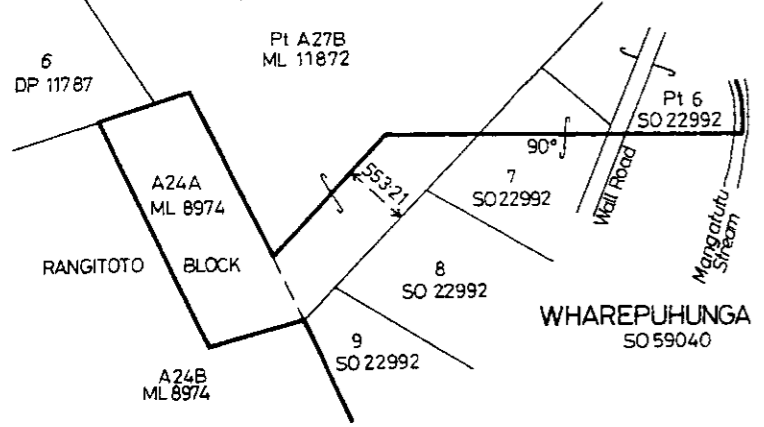

DIAGRAM A
DISTORTED

Diagram B
Not to Scale
WAIPA WARD



Approvals

NOTE:-
Where a boundary is shown along a river or road it follows the middle line of the physical river or legal road unless otherwise shown.

Amended as per the Otorohanga District Council resolution dated 2 May 2006 pursuant to section 19Y(1) Local Electoral Act 2001.

[Signature] 14/8/06
Otorohanga District Council

I certify that this plan renders the boundary capable of identification under section 19Y(3)(b) Local Electoral Act 2001.

[Signature] 24/8/2006
Approving Surveyor

Total Area

Comprised in

I, *[Signature]*
Registered Surveyor and holder of an annual practising certificate (or who may act as a registered surveyor pursuant to section 25 of the Survey Act 1986) hereby certify that this plan has been made from surveys executed by me or under my directions, that both plan and survey are correct and have been made in accordance with the Survey Regulations 1972 or any regulations made in substitution thereof.
Dated at this day
of 19..... Signature

Field Book p. Traverse Book p.

Reference Plans

Examined *[Signature]* Correct *[Signature]*

Approved for Gazette Purposes
16/12/01 *[Signature]*
Dep Chief Surveyor

Deposited this day of 19.....

District Land Registrar

LAND DISTRICT SOUTH AUCKLAND
Survey Blk. & Dist.
NZMS 261 Sheet S16, S17, T17

WAIPA WARD

TERRITORIAL AUTHORITY OTOROHANGA DISTRICT
PREPARED BY: DEPARTMENT OF SURVEY AND LAND INFORMATION
Scale 1:100,000 Date October 1991

File 6500105
Received 19/11/91
Instructions 420424

SO 59039