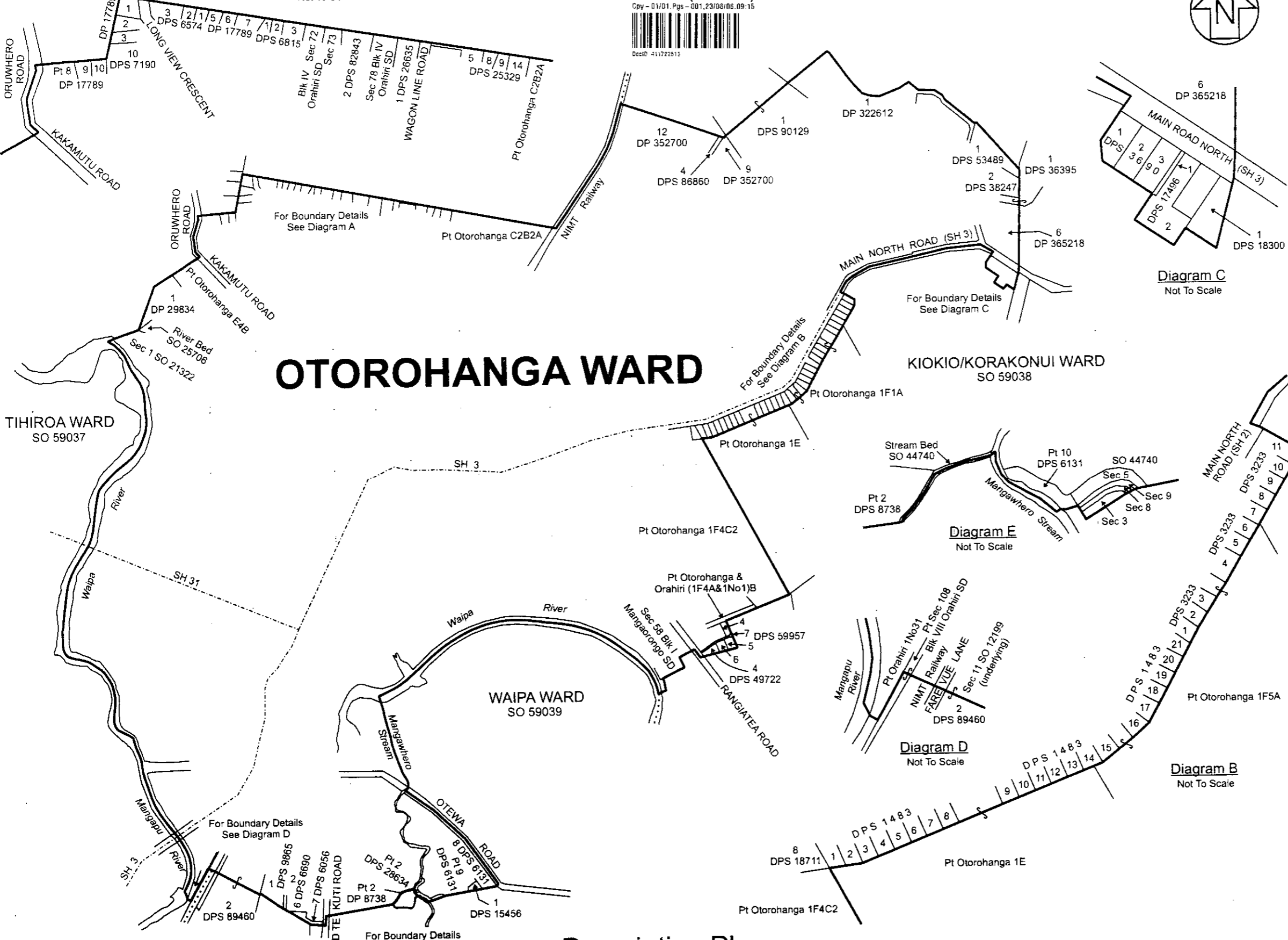

Diagram A
Not To Scale

SO 374679 (Title Plan)



OTOROHANGA WARD

KIOKIO/KORAKONU WARD
SO 59038

TIHIROA WARD
SO 59037

WAIPA WARD
SO 59039

Descriptive Plan

Approvals

Where a boundary is shown along a river or road it follows the middle line of the physical river or legal road unless otherwise shown.

Where a boundary is shown along a railway it follows the middle line of the cadastral railway unless otherwise shown.

Certified by the Otorohanga District Council that the boundary shown hereon is the same as the boundary defined in the Otorohanga District Council resolution dated 2 May 2006 pursuant to section 19Y(1) Local Electoral Act 2001.

[Signature] 14.1.8.06
Otorohanga District Council

I certify that this plan renders the boundary capable of identification under section 19Y(3)(b) Local Electoral Act 2001.

[Signature] 24.8.2006
Approving Surveyor

Total Area
Comprised in:
being a person entitled to practise as a licensed cadastral surveyor, certify that -
(a) The Surveys to which this dataset relates are accurate, and were undertaken by me or under my direction in accordance with the Cadastral Survey Act 2002 and the Surveyor-General's Rules for Cadastral Survey 2002/2:
(b) This dataset is accurate, and has been created in accordance with that Act and those Rules

Field Book - p.	Traverse Book - p.
Reference Plans	
Examined	Correct

Approved as to Gazettal Purposes
by Land Information NZ
24.8.2006

Deposited this... day of.....
..... for Registrar-General of Land
File AE02944
Received 23.8.06
Instructions: **SO 374679**

Land District : South Auckland

OTOROHANGA WARD

TERRITORIAL AUTHORITY: OTOROHANGA DISTRICT
Compiled by Sinclair Knight Merz Ltd
Scale 1:10,000 Date July 2006