

**Bay of Islands-Whangaroa
General Ward
LG-001-2022-W-3**

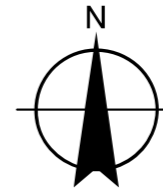

Notes:

1. Coordinates are in terms of New Zealand Transverse Mercator 2000 (NZTM).
2. All seaward boundaries follow Mean Low Water Springs but cross the mouths of all rivers, streams, inlets and estuaries except where shown otherwise.
3. Where a boundary is shown along a river or road it follows the middle line of the physical river or legal road unless otherwise shown.
4. Where a boundary is shown along a railway, it follows the middle line of the cadastral railway unless otherwise shown.

**Kaikohe-Hokianga
General Ward
LG-001-2022-W-4**

**MANGAKAHIA-
MAUNGATAPERE
GENERAL WARD**

**Hikurangi-Coastal
General Ward
LG-002-2019-W-2**

**Whangarei Urban
General Ward
LG-002-2022-W-5**

**Wairoa General Ward
LG-003-2022-W-3**

**Bream Bay
General Ward
LG-002-2022-W-3**

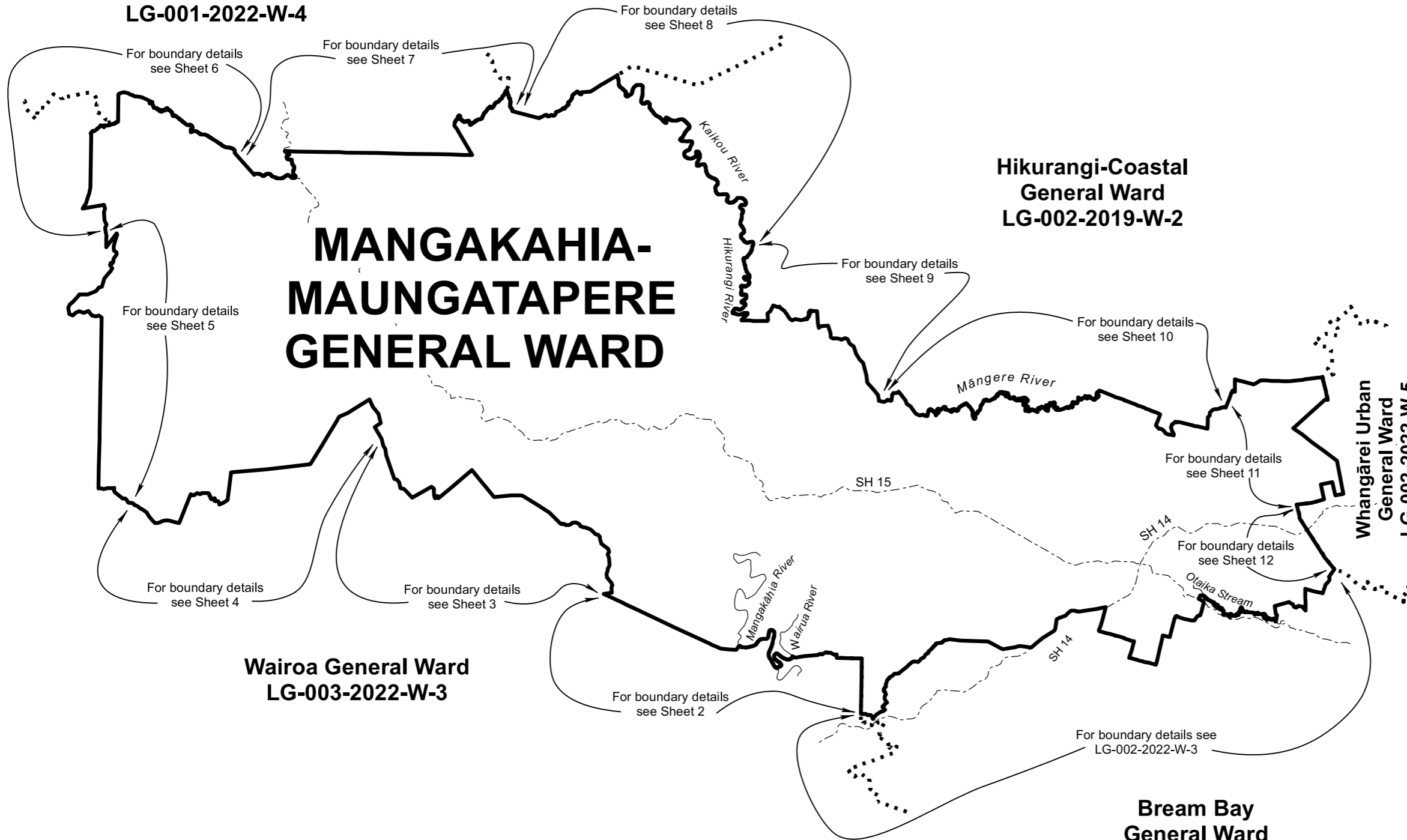

Land District: North Auckland

**WHANGAREI DISTRICT
MANGAKAHIA-MAUNGATAPERE
GENERAL WARD**

TERRITORIAL AUTHORITY: Whangarei District

Compiled by Jacobs New Zealand Limited

Scale 1:175,000 at A3

Date: May 2022

LG-002-2022-W-4

Sheet 1 of 12

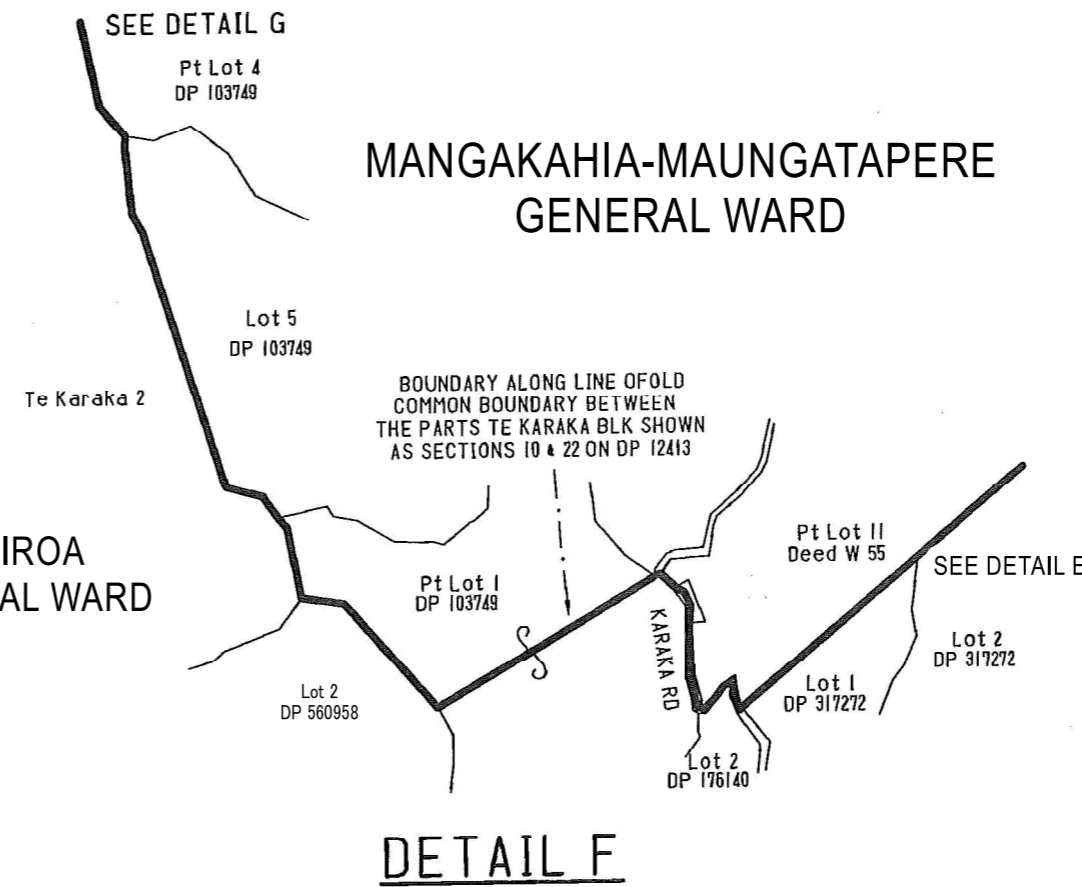
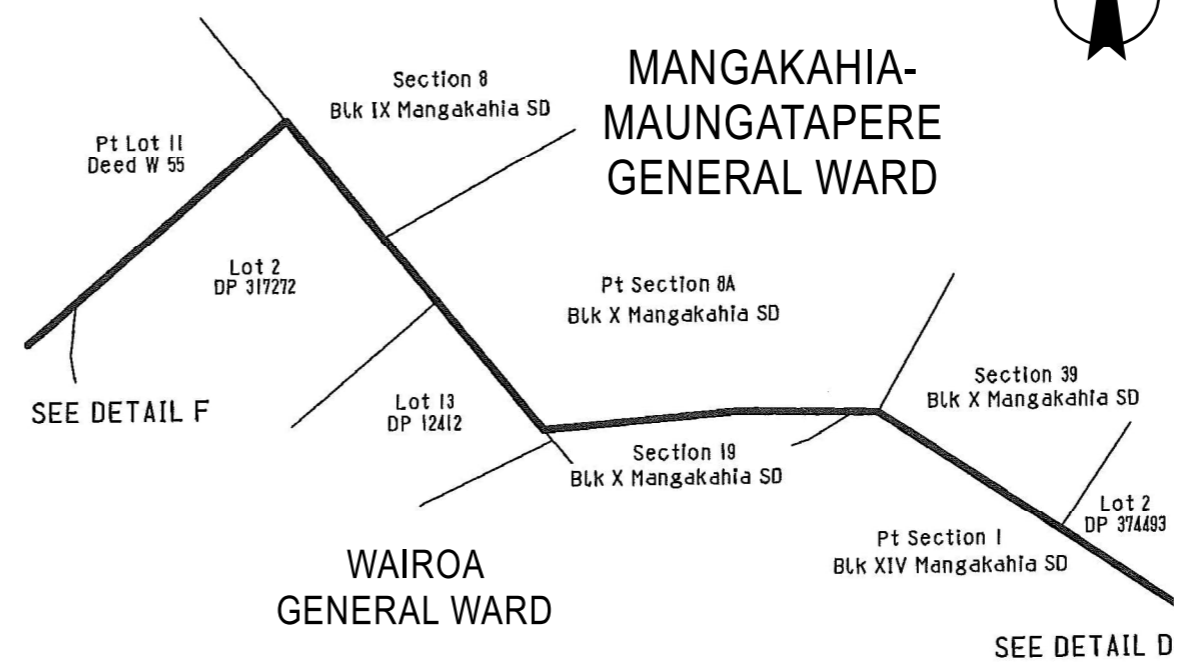
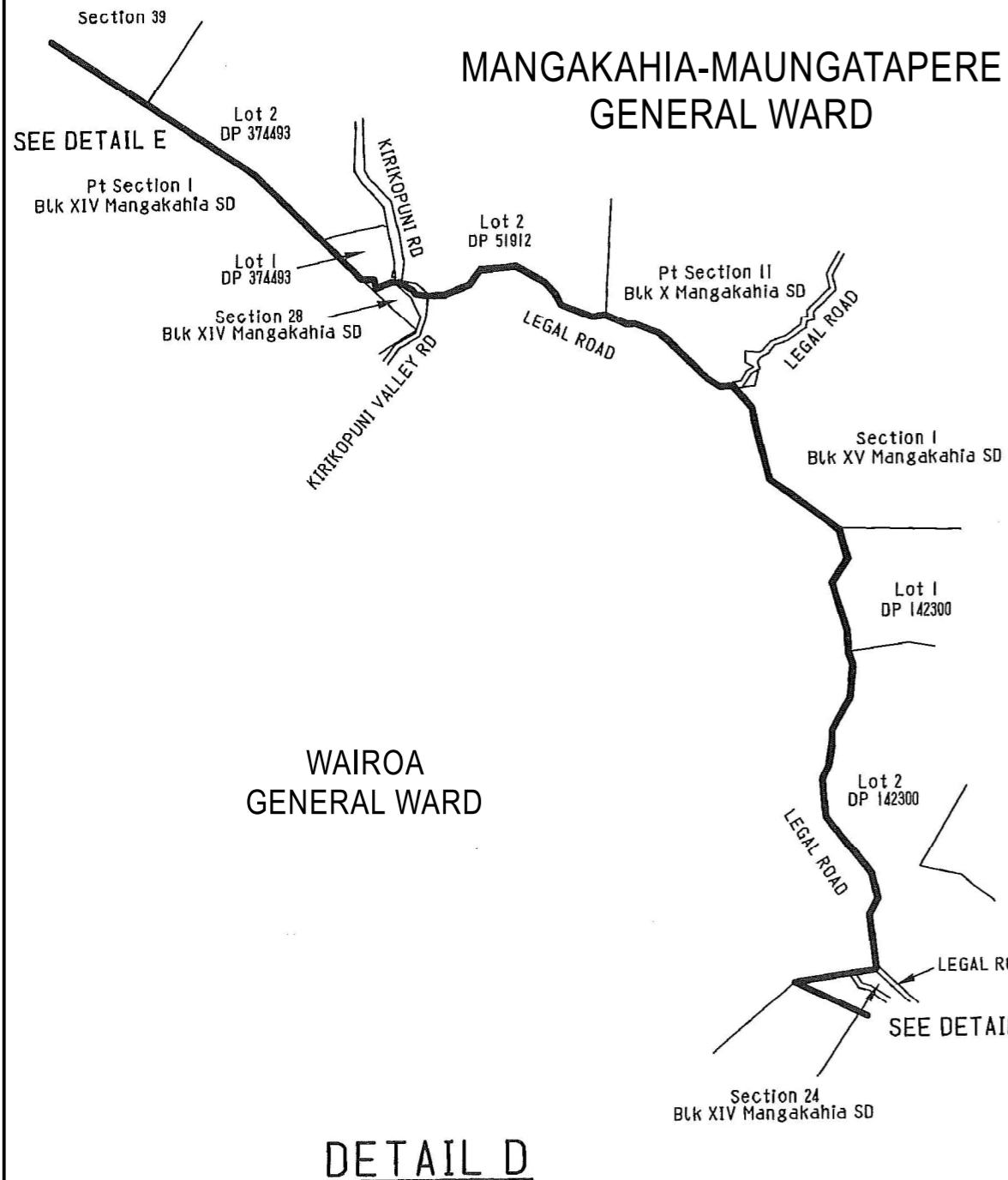
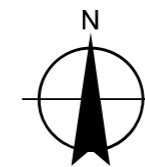

Land District: North Auckland
 File IZ049800

**WHANGAREI DISTRICT
 MANGAKAHIA-MAUNGATAPERE
 GENERAL WARD**

TERRITORIAL AUTHORITY: Whangarei District
 Compiled by Jacobs New Zealand Limited
 Scale 1:25,000 at A3 Date: May 2022

LG-002-2022-W-4
 Sheet 3 of 12

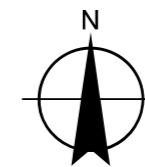

MANGAKAHIA-MAUNGATAPERE GENERAL WARD

MANGAKAHIA-MAUNGATAPERE GENERAL WARD

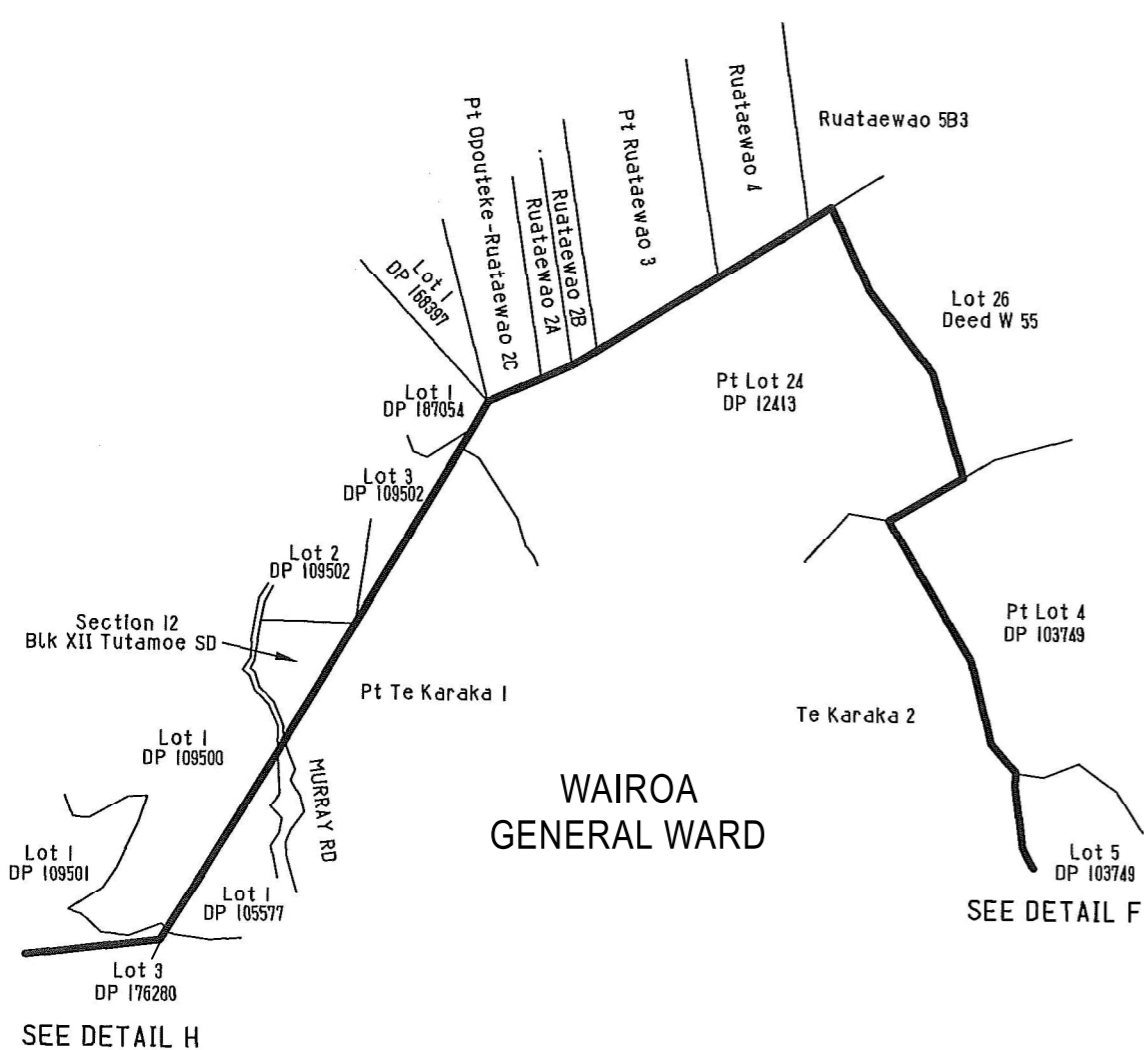

DETAIL G

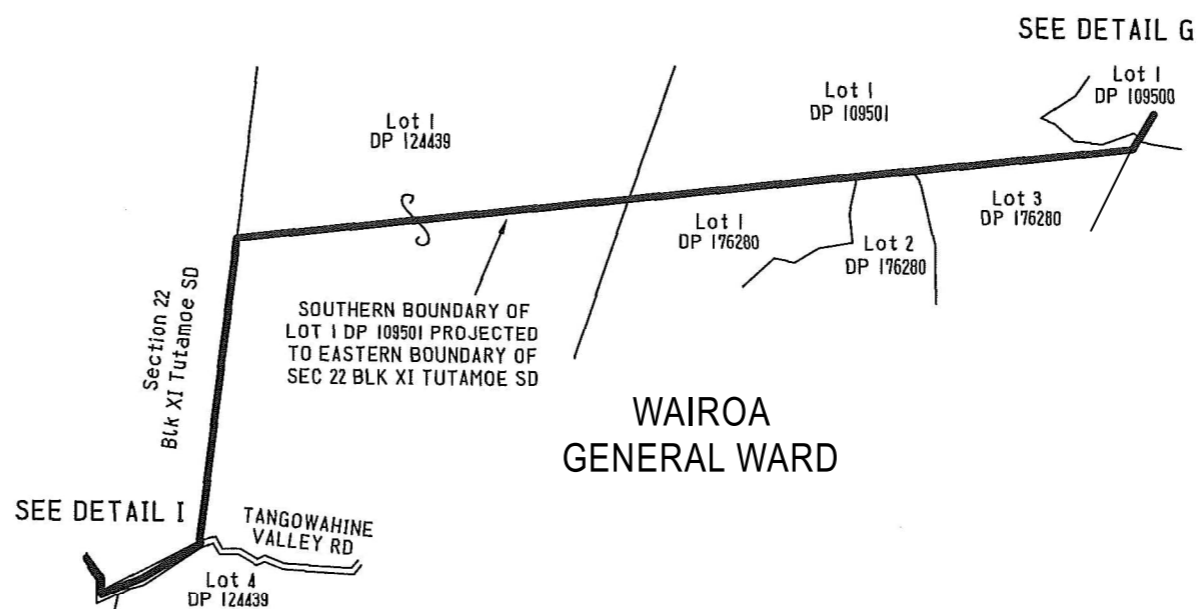

DETAIL H

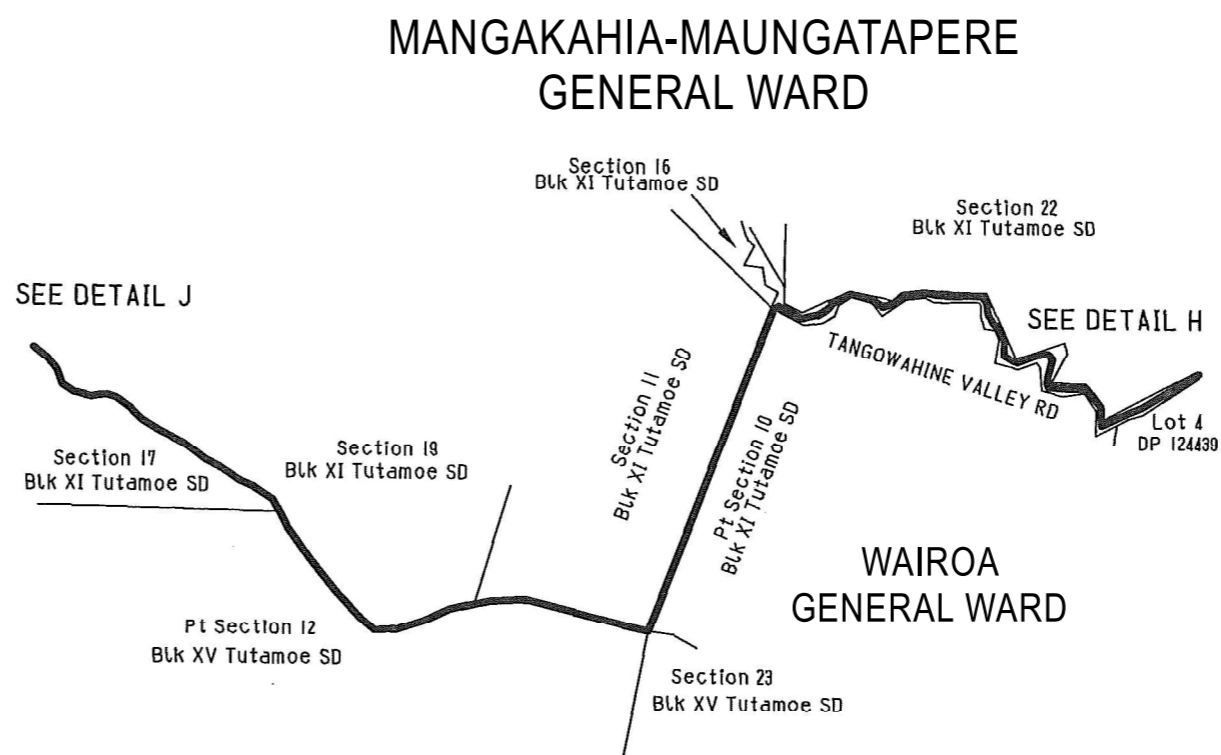

DETAIL I

Land District: North Auckland

WHANGAREI DISTRICT MANGAKAHIA-MAUNGATAPERE GENERAL WARD

TERRITORIAL AUTHORITY: Whangarei District

Compiled by Jacobs New Zealand Limited

Scale 1:25,500 at A3

Date: May 2022

LG-002-2022-W-4

Sheet 4 of 12

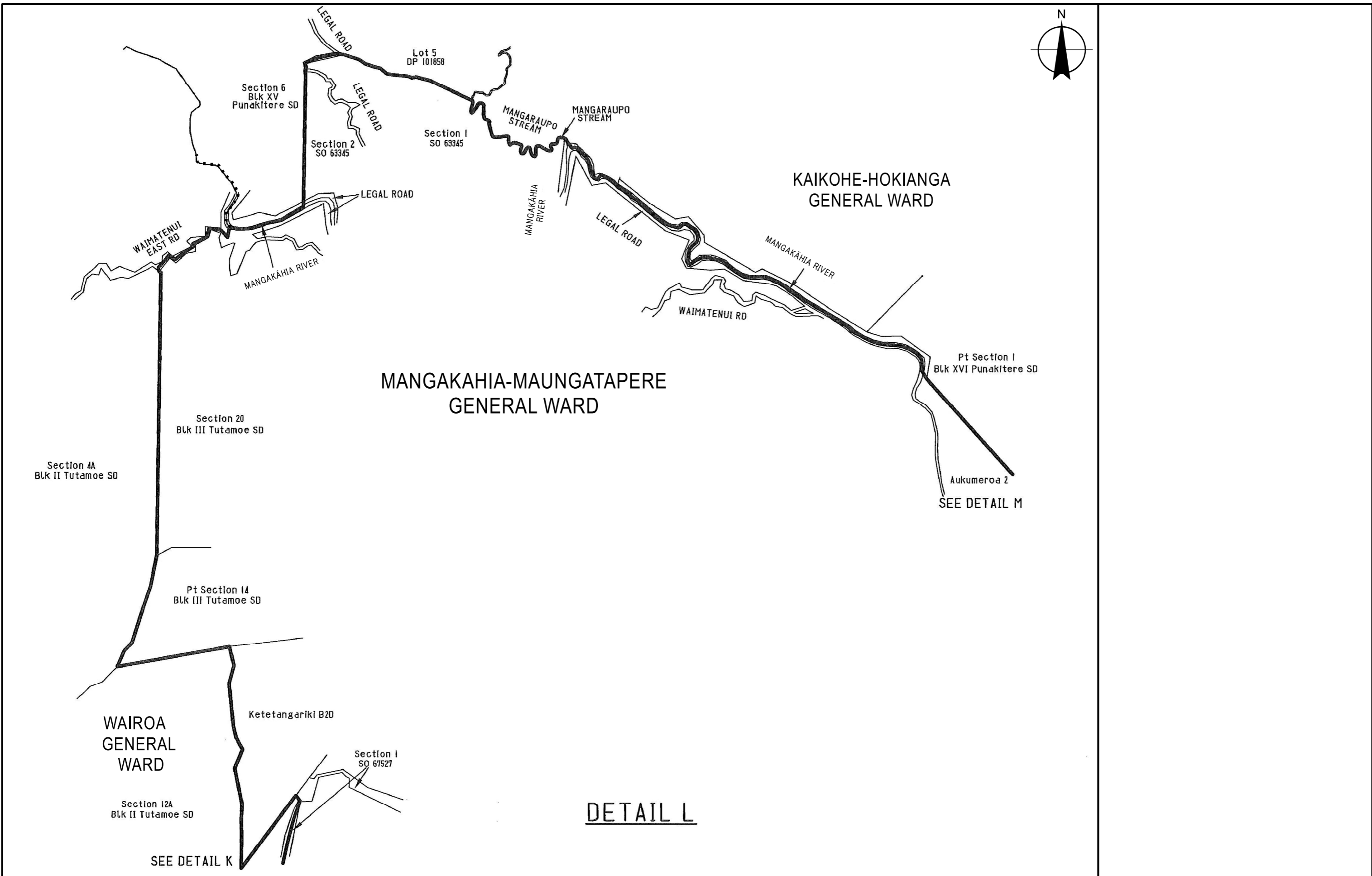

Land District: North Auckland
 File IZ049800

WHANGAREI DISTRICT
MANGAKAHIA-MAUNGATAPERE
GENERAL WARD

TERRITORIAL AUTHORITY: Whangarei District
 Compiled by Jacobs New Zealand Limited
 Scale 1:25,000 at A3 Date: May 2022

LG-002-2022-W-4
 Sheet 6 of 12

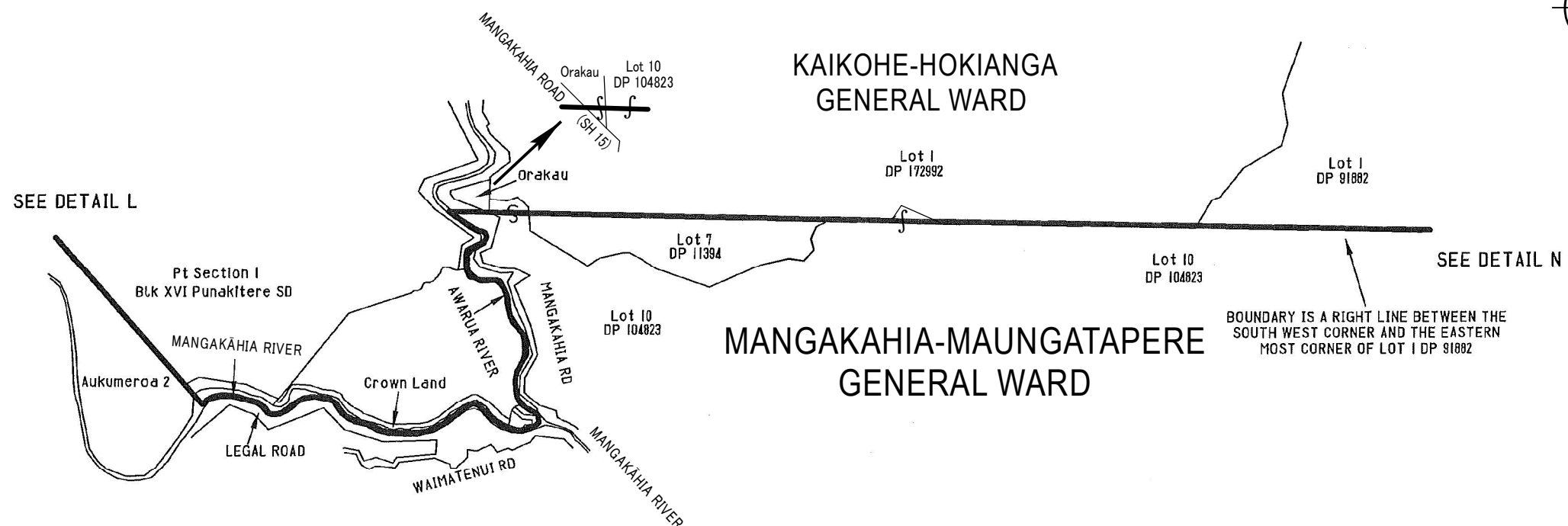
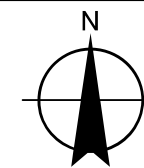

DETAIL M

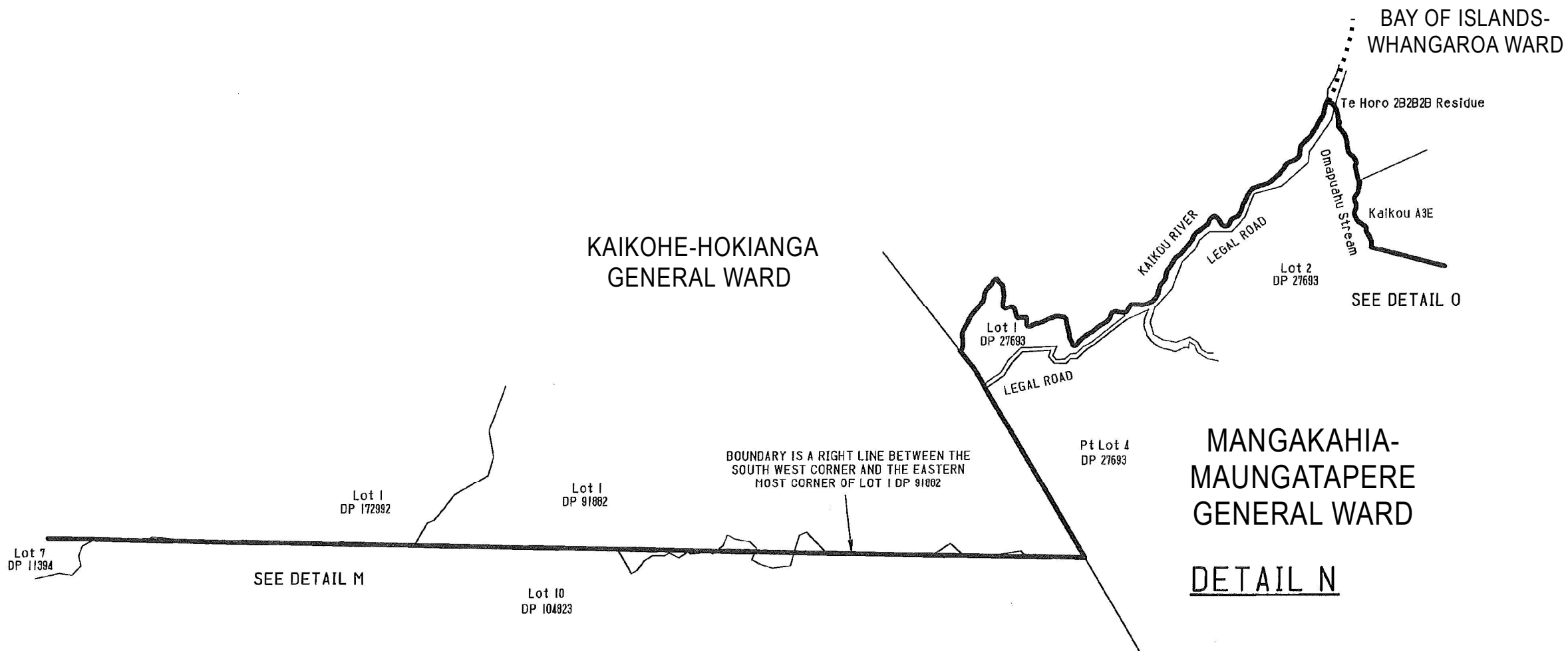

Land District: North Auckland

**WHANGAREI DISTRICT
MANGAKAHIA-MAUNGATAPERE
GENERAL WARD**

TERRITORIAL AUTHORITY: Whangarei District

Compiled by Jacobs New Zealand Limited

Scale 1:27,500 at A3

Date: May 2022

LG-002-2022-W-4

Sheet 7 of 12

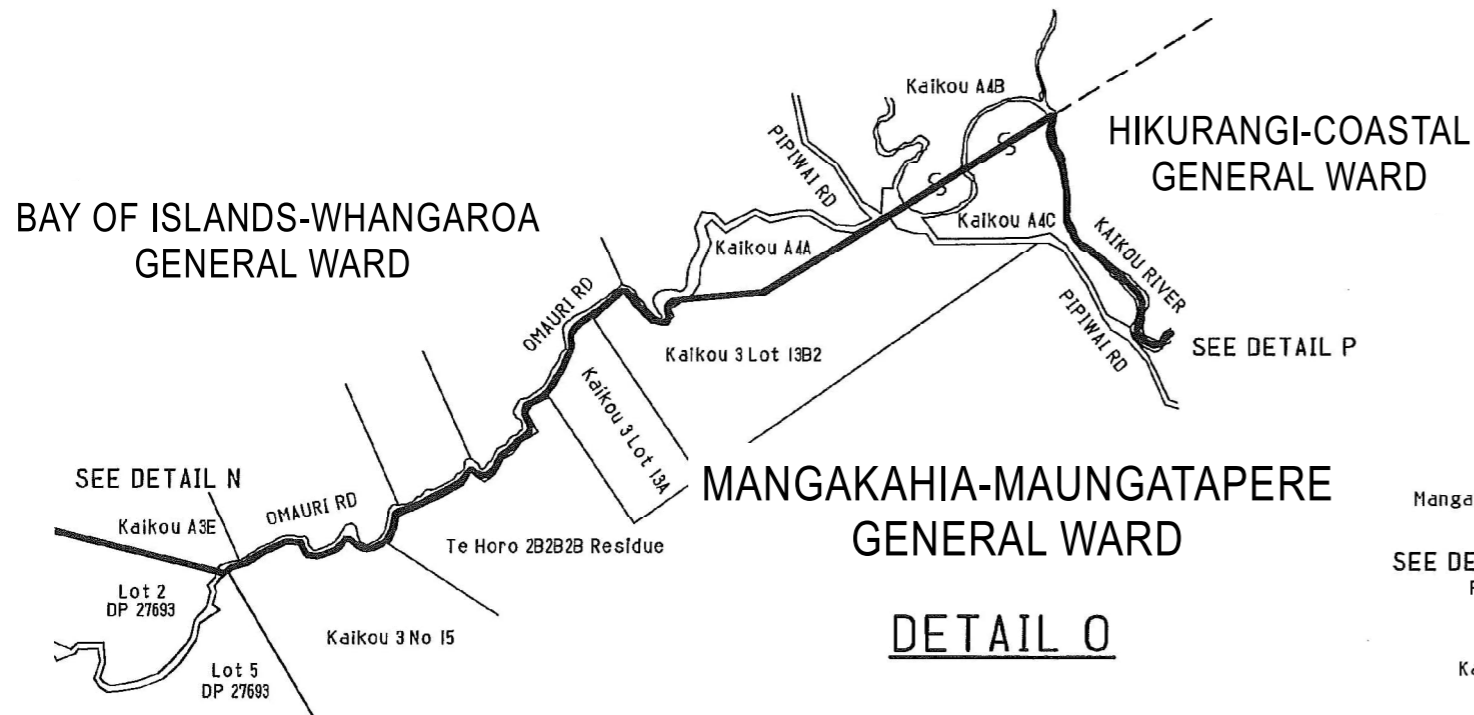
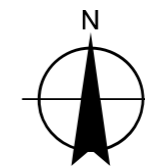

**MANGAKAHIA-MAUNGATAPERE
GENERAL WARD**
DETAIL O

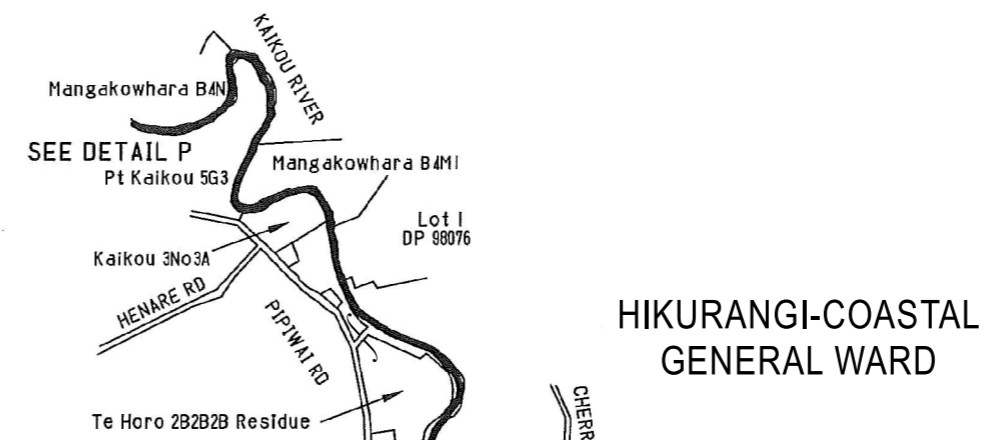

**MANGAKAHIA-
MAUNGATAPERE
GENERAL WARD**
DETAIL Q

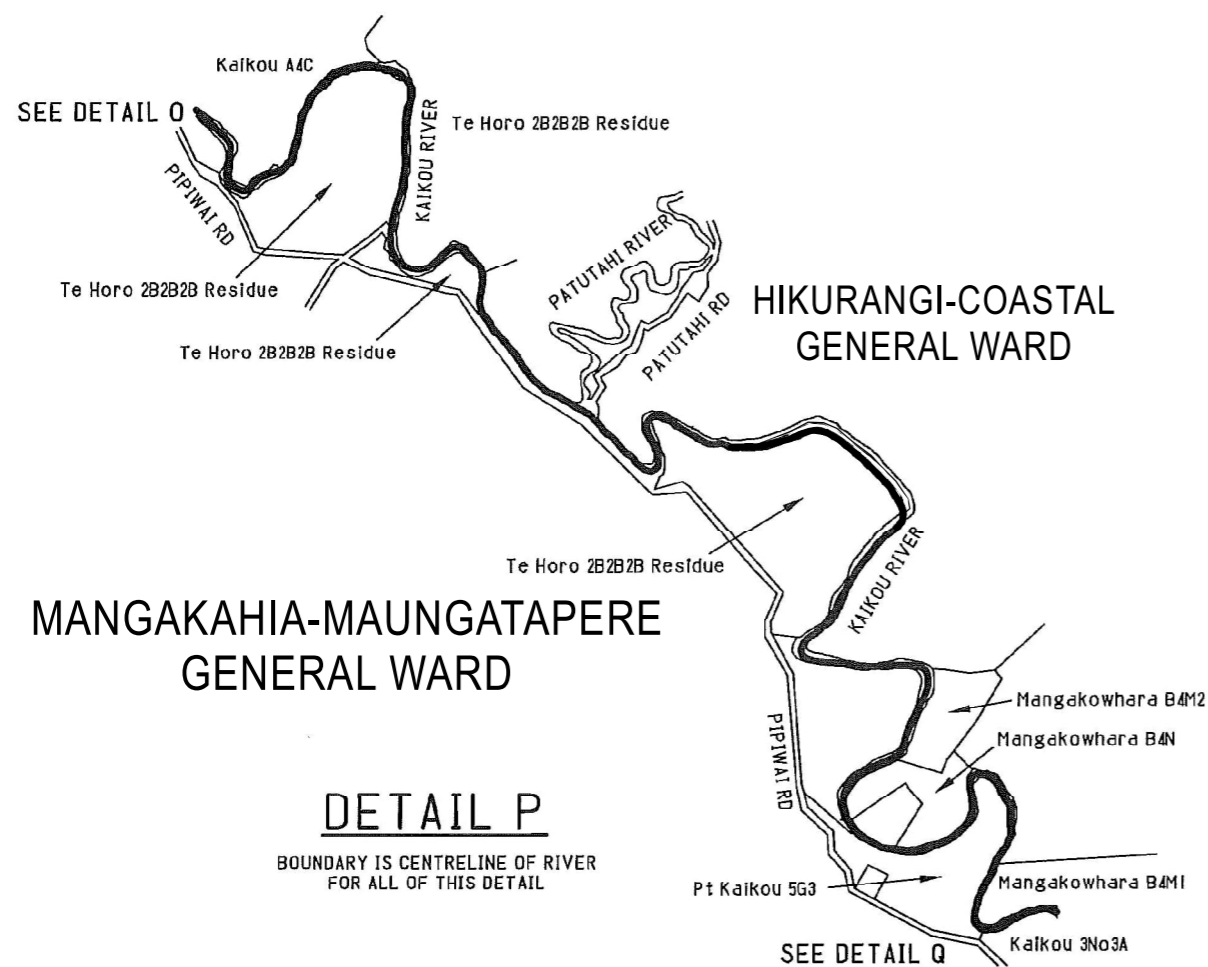

**MANGAKAHIA-MAUNGATAPERE
GENERAL WARD**
DETAIL P
BOUNDARY IS CENTRELINE OF RIVER
FOR ALL OF THIS DETAIL

**BOUNDARY IS THE
CENTRELINE OF
KAIKOU RIVER AND
HIKURANGI RIVERS IN
DETAILS P AND Q**

Land District: North Auckland

**WHANGAREI DISTRICT
MANGAKAHIA-MAUNGATAPERE
GENERAL WARD**

TERRITORIAL AUTHORITY: Whangarei District

Compiled by Jacobs New Zealand Limited

Scale 1:27,500 at A3

Date: May 2022

LG-002-2022-W-4

Sheet 8 of 12

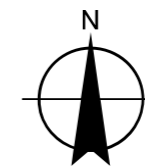

SEE DETAIL Q

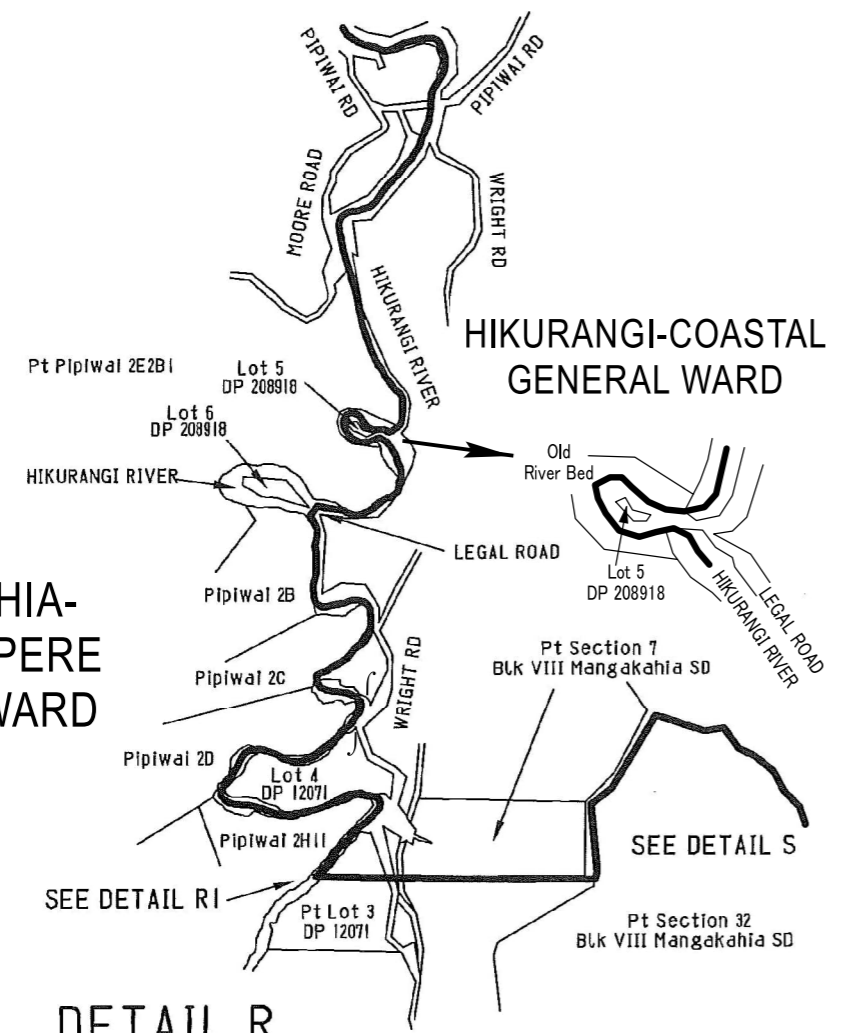

MANGAKAHIA-
MAUNGATAPERE
GENERAL WARD

HIKURANGI-COASTAL
GENERAL WARD

DETAIL R

ON THIS DETAIL BOUNDARY IS CENTRELINE OF RIVER FROM NORTH TO INTERSECTION ON DETAIL RI UNLESS OTHERWISE SHOWN

BOUNDARY IS THE PROJECTION OF THE SOUTHERN BOUNDARY OF PT SEC 7 BLK VIII MANGAKAHIA SD TO THE CENTRELINE OF THE HIKURANGI RIVER

HIKURANGI-COASTAL
GENERAL WARD

DETAIL RI
ENLARGED

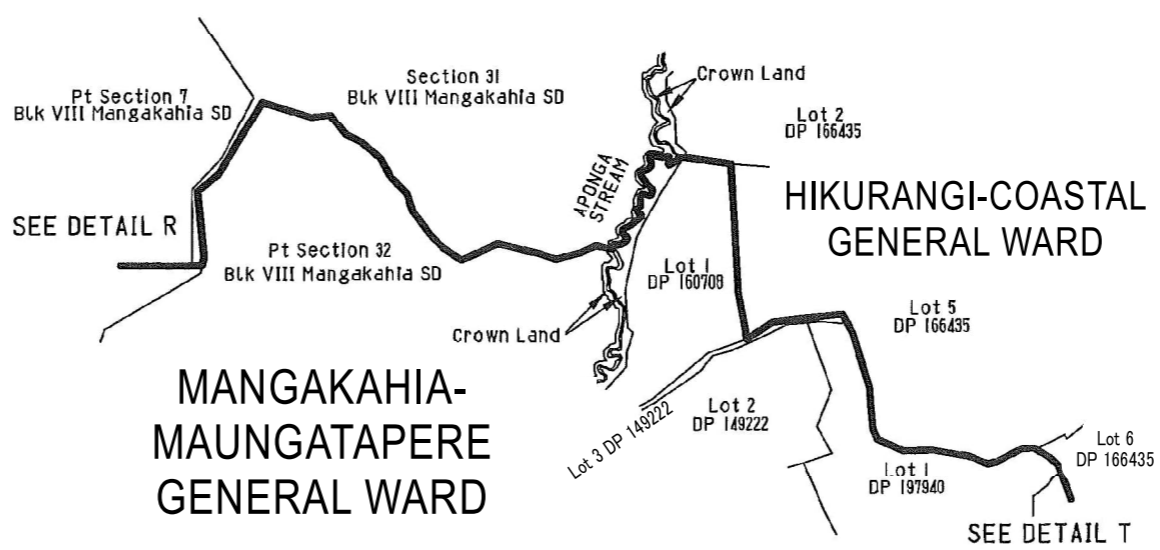

MANGAKAHIA-
MAUNGATAPERE
GENERAL WARD

HIKURANGI-COASTAL
GENERAL WARD

DETAIL S

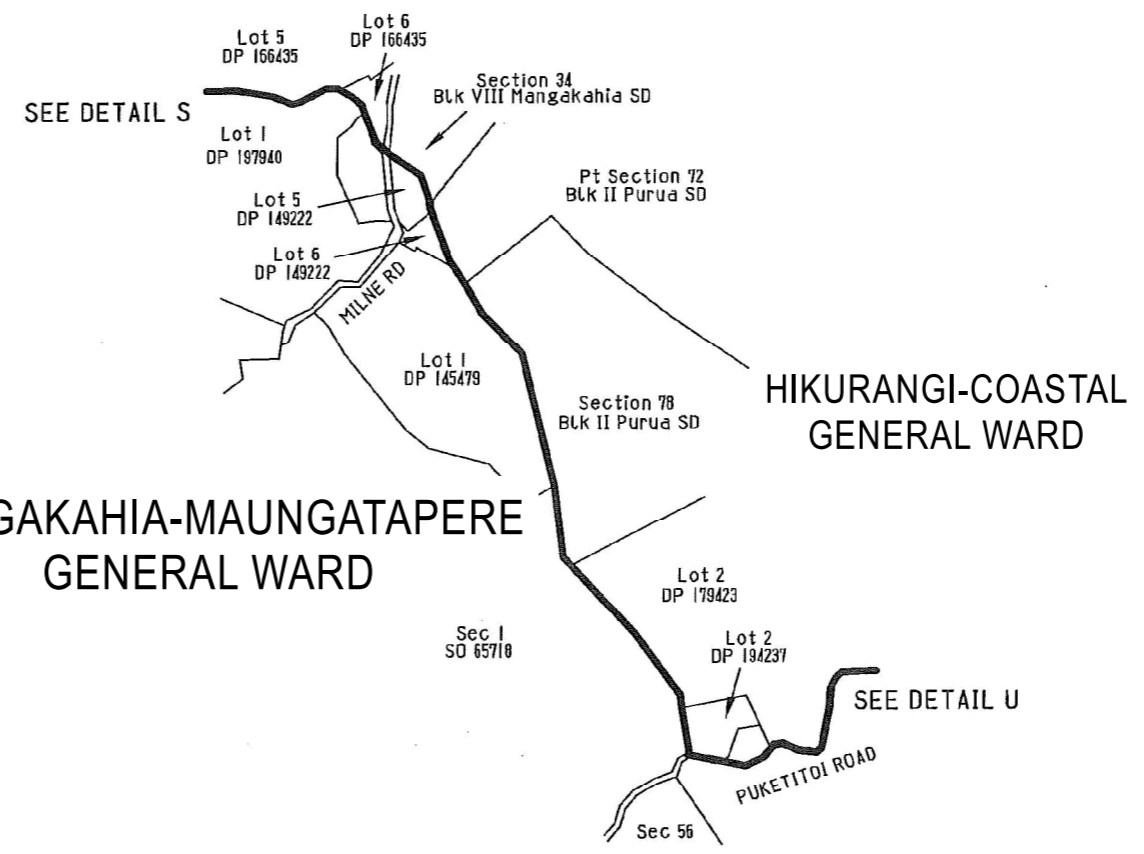

MANGAKAHIA-MAUNGATAPERE
GENERAL WARD

HIKURANGI-COASTAL
GENERAL WARD

DETAIL T

Land District: North Auckland
File IZ049800

**WHANGAREI DISTRICT
MANGAKAHIA-MAUNGATAPERE
GENERAL WARD**

TERRITORIAL AUTHORITY: Whangarei District
Compiled by Jacobs New Zealand Limited
Scale 1:27,500 at A3 Date: May 2022

LG-002-2022-W-4
Sheet 9 of 12

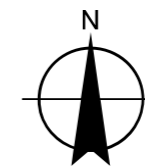

HIKURANGI-COASTAL
GENERAL WARD

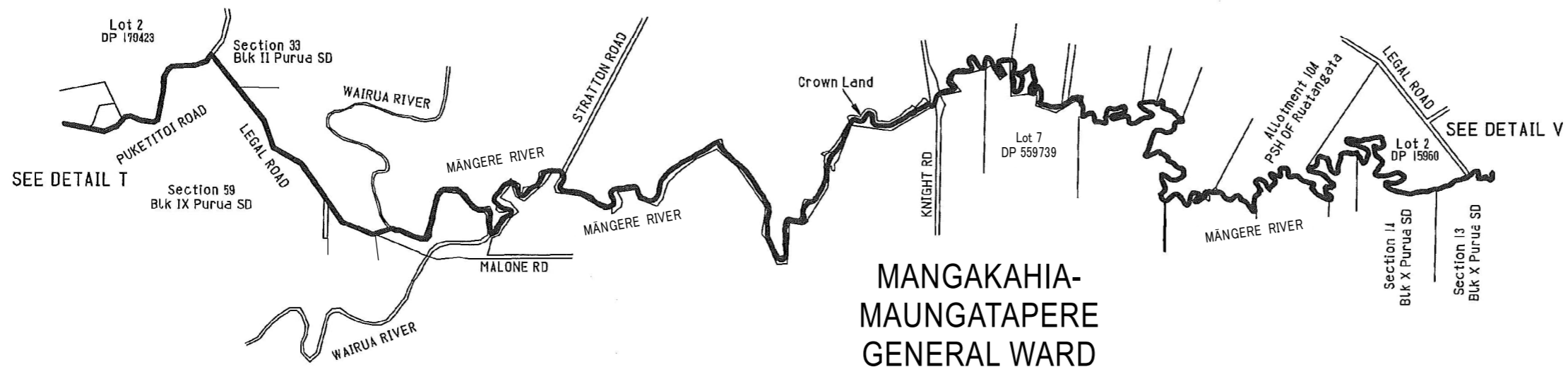

MANGAKAHIA-
MAUNGATAPERE
GENERAL WARD

DETAIL U

HIKURANGI-COASTAL
GENERAL WARD

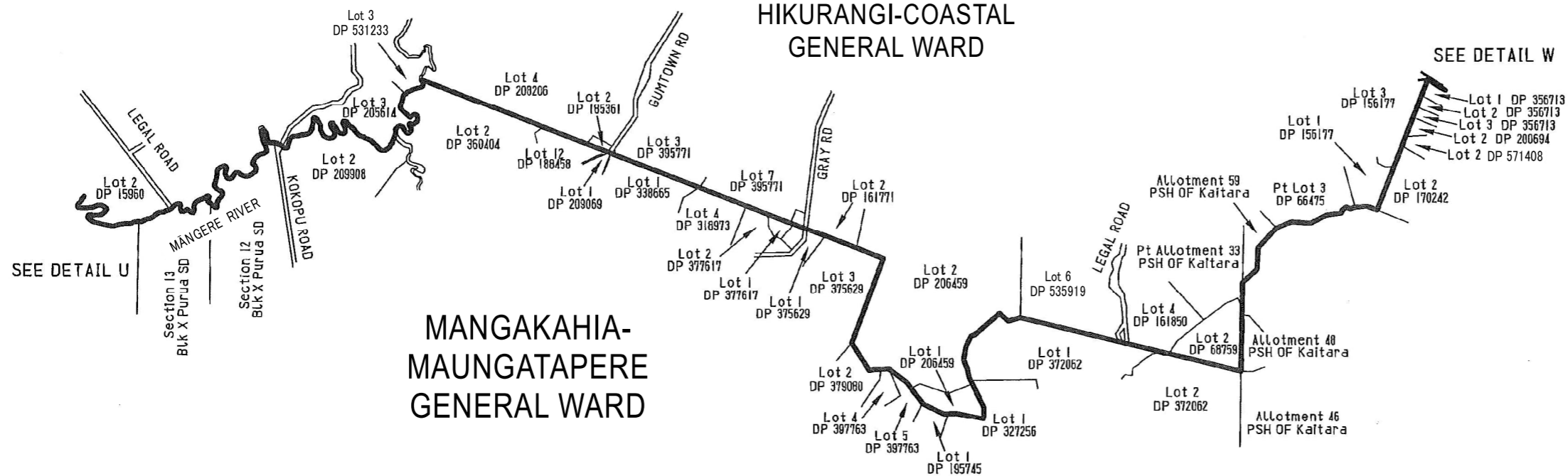

MANGAKAHIA-
MAUNGATAPERE
GENERAL WARD

DETAIL V

Land District: North Auckland

**WHANGAREI DISTRICT
MANGAKAHIA-MAUNGATAPERE
GENERAL WARD**

TERRITORIAL AUTHORITY: Whangarei District

Compiled by Jacobs New Zealand Limited

Scale 1:27,500 at A3

Date: May 2022

LG-002-2022-W-4

Sheet 10 of 12

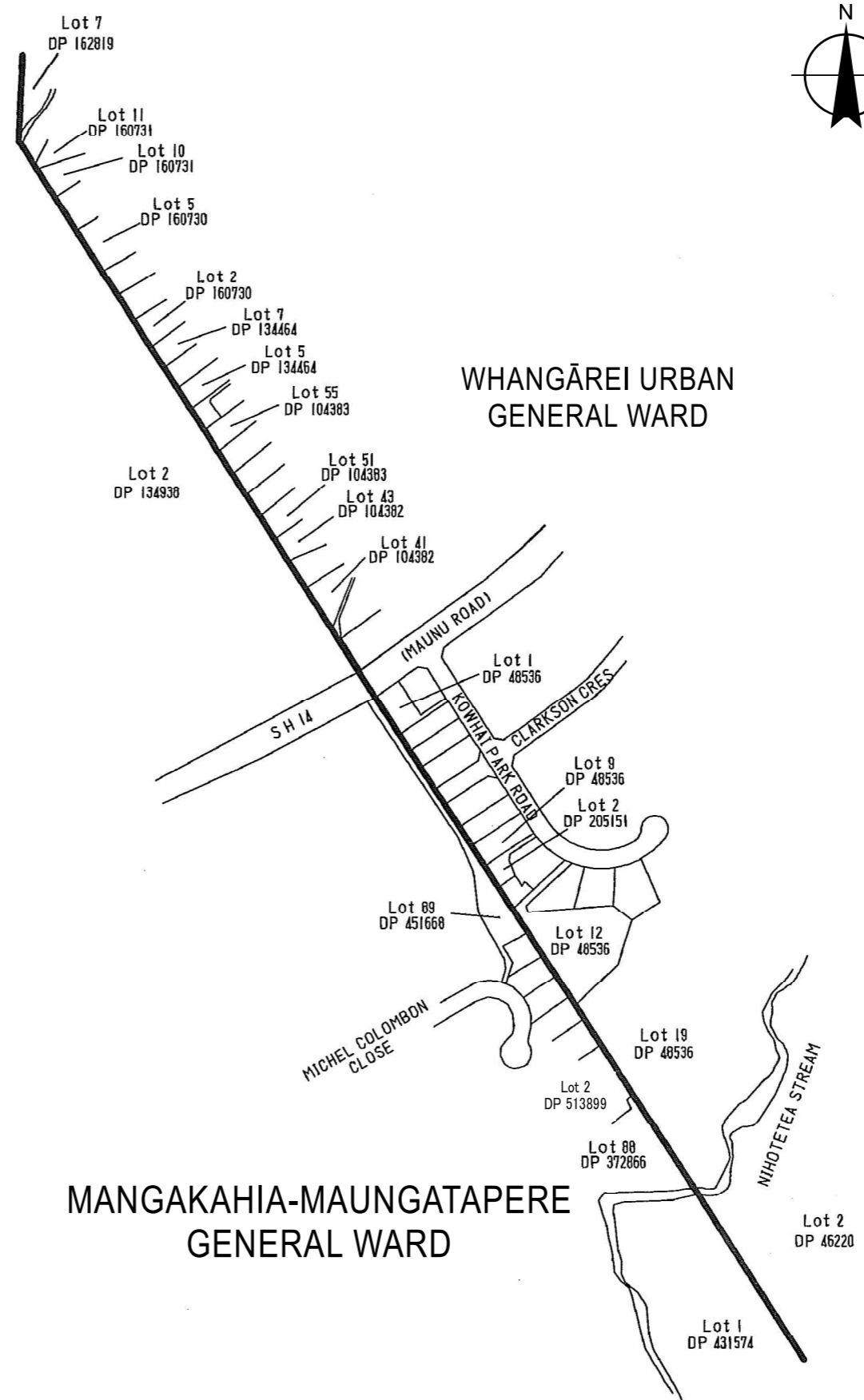
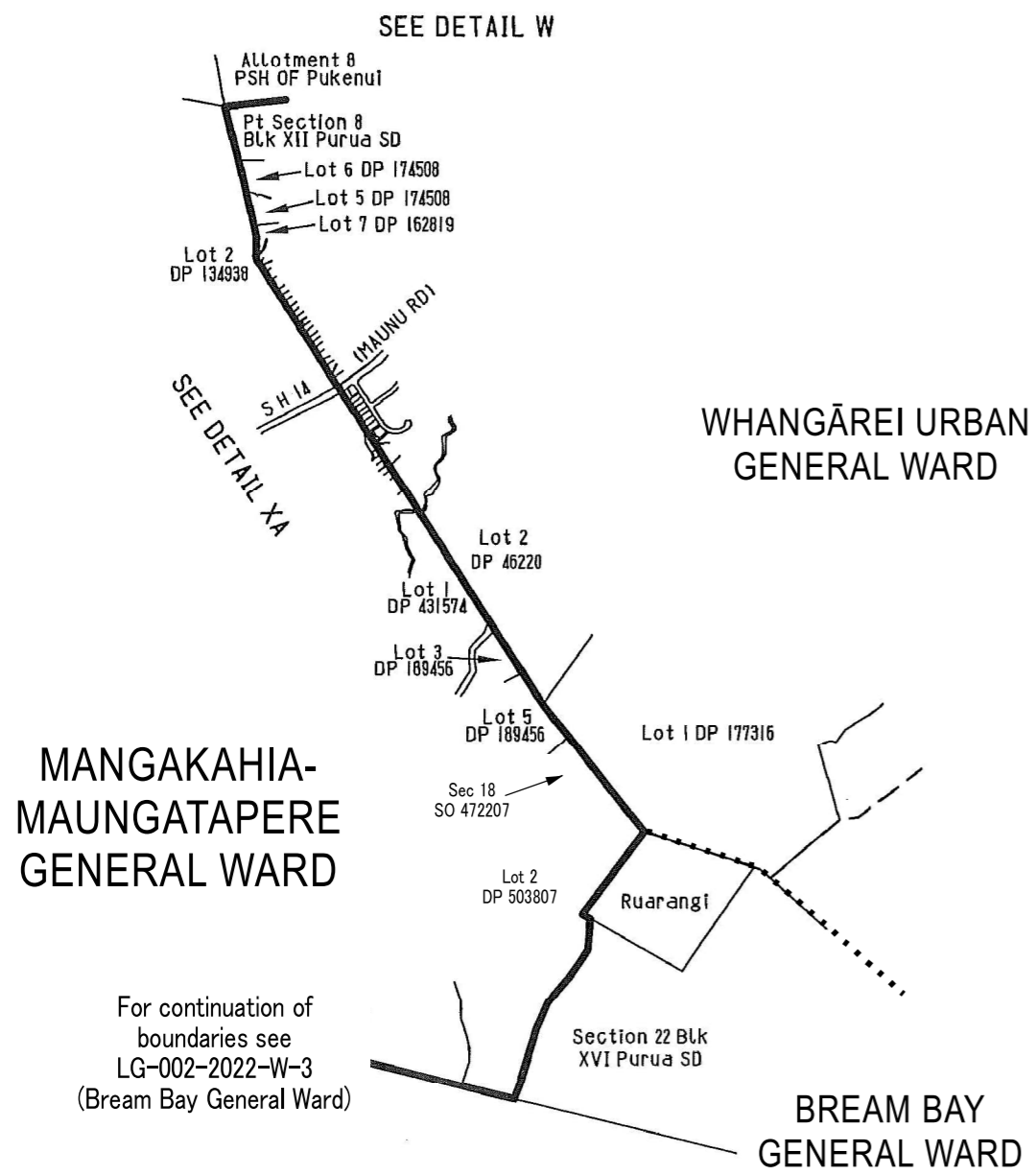
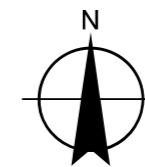

DETAIL X

DETAIL XA

ENLARGED

Land District: North Auckland

File IZ049800

WHANGAREI DISTRICT
MANGAKAHIA-MAUNGATAPERE
GENERAL WARD

TERRITORIAL AUTHORITY: Whangarei District

Compiled by Jacobs New Zealand Limited

Not to scale

Date: May 2022

LG-002-2022-W-4

Sheet 12 of 12