

**Mangakahia-Maungatapere
General Ward
LG-002-2022-W-4**

**Whangārei Urban
General Ward
LG-002-2022-W-5**

**Whangārei Heads
General Ward
LG-002-2012-W-7**

**Wairoa General Ward
LG-003-2022-W-3**

**BREAM BAY
GENERAL WARD**

**Otamatea Ward
LG-003-2019-W-3**

**Kaiwaka-Mangawhai
Ward
LG-003-2019-W-4**

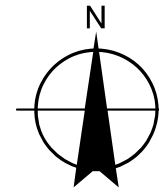

Notes:

1. Coordinates are in terms of New Zealand Transverse Mercator 2000 (NZTM).
2. All seaward boundaries follow Mean Low Water Springs but cross the mouths of all rivers, streams, inlets and estuaries except where shown otherwise.
3. Where a boundary is shown along a river or road it follows the middle line of the physical river or legal road unless otherwise shown.
4. Where a boundary is shown along a railway, it follows the middle line of the cadastral railway unless otherwise shown.
5. All adjacent islands and inlets are included in this ward, including the Hen and Chickens Group.

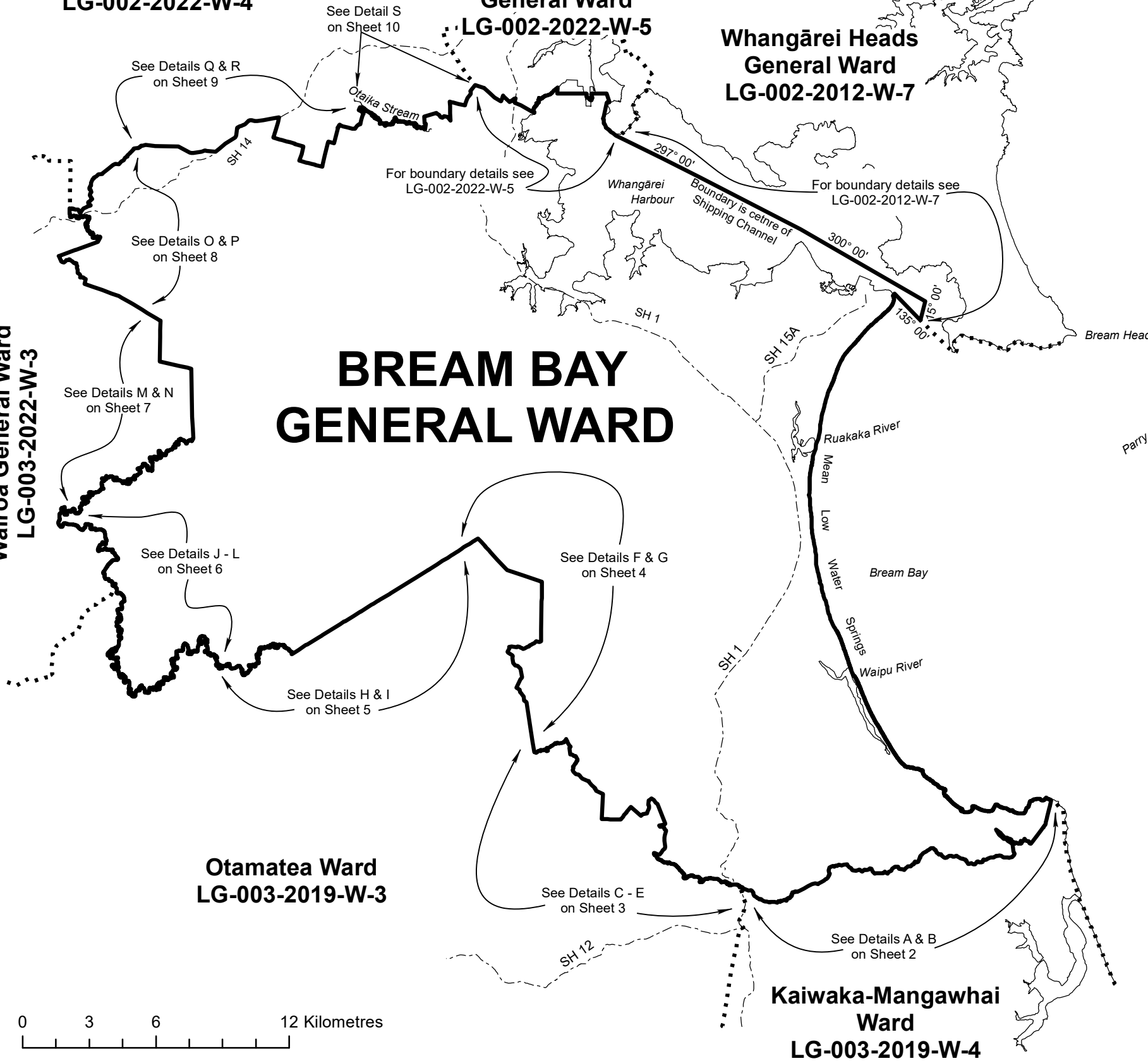

Hen and Chickens Islands
The boundary of each Island is MLWS



● Salt Rock

Pacific
Ocean

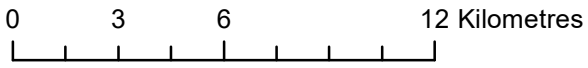

Land District: North Auckland

**WHANGAREI DISTRICT
BREAM BAY GENERAL WARD**

TERRITORIAL AUTHORITY: Whangarei District

Compiled by Jacobs New Zealand Limited

Scale 1:215,000 at A3 Date: May 2022

LG-002-2022-W-3

Sheet 1 of 10

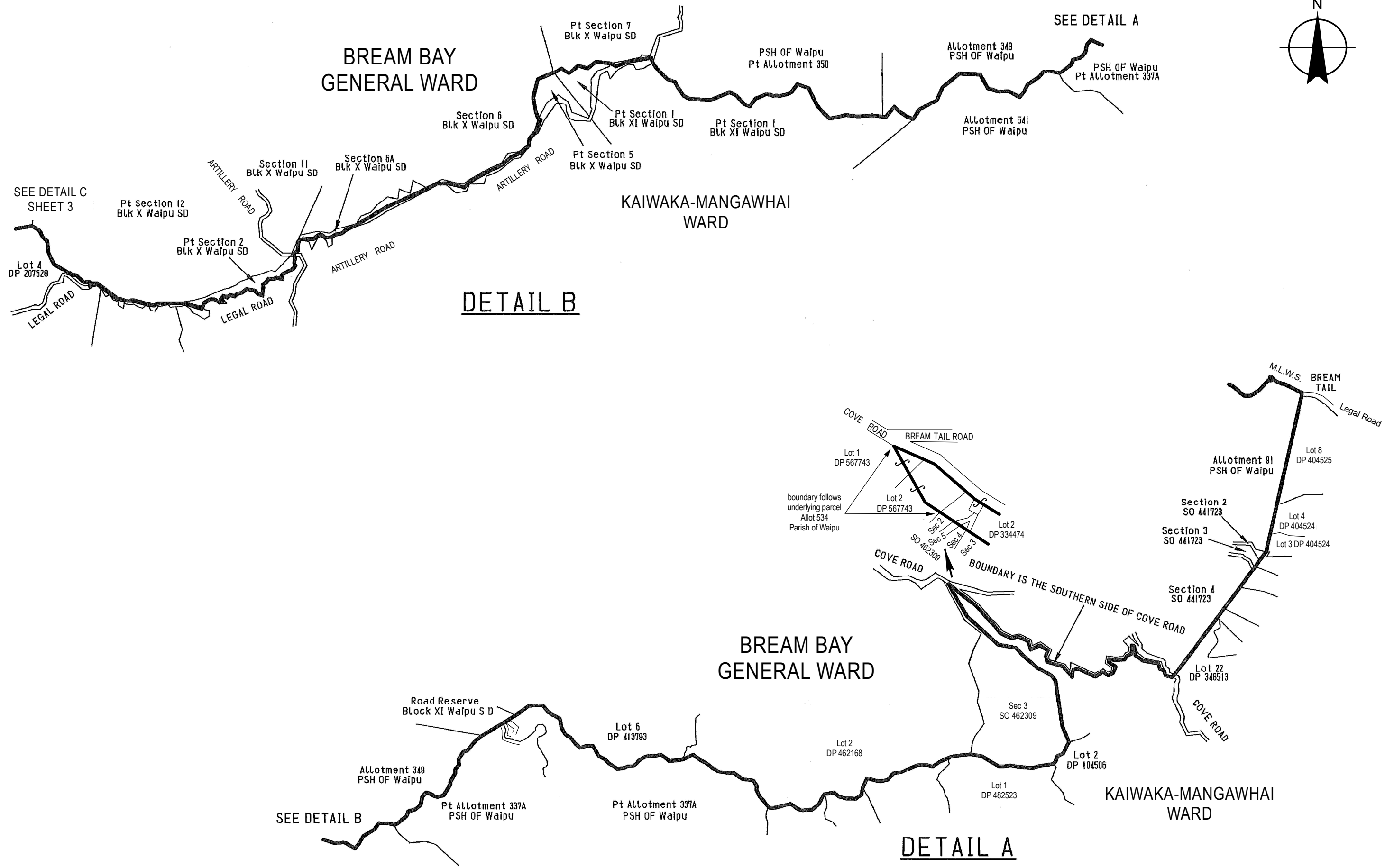
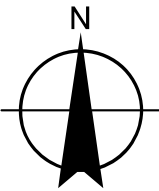

Land District: North Auckland

WHANGAREI DISTRICT BREAM BAY GENERAL WARD

TERRITORIAL AUTHORITY: Whangarei District

Compiled by Jacobs New Zealand Limited

Scale 1:25,000 at A3

Date: May 2022

LG-002-2022-W-3

Sheet 2 of 10

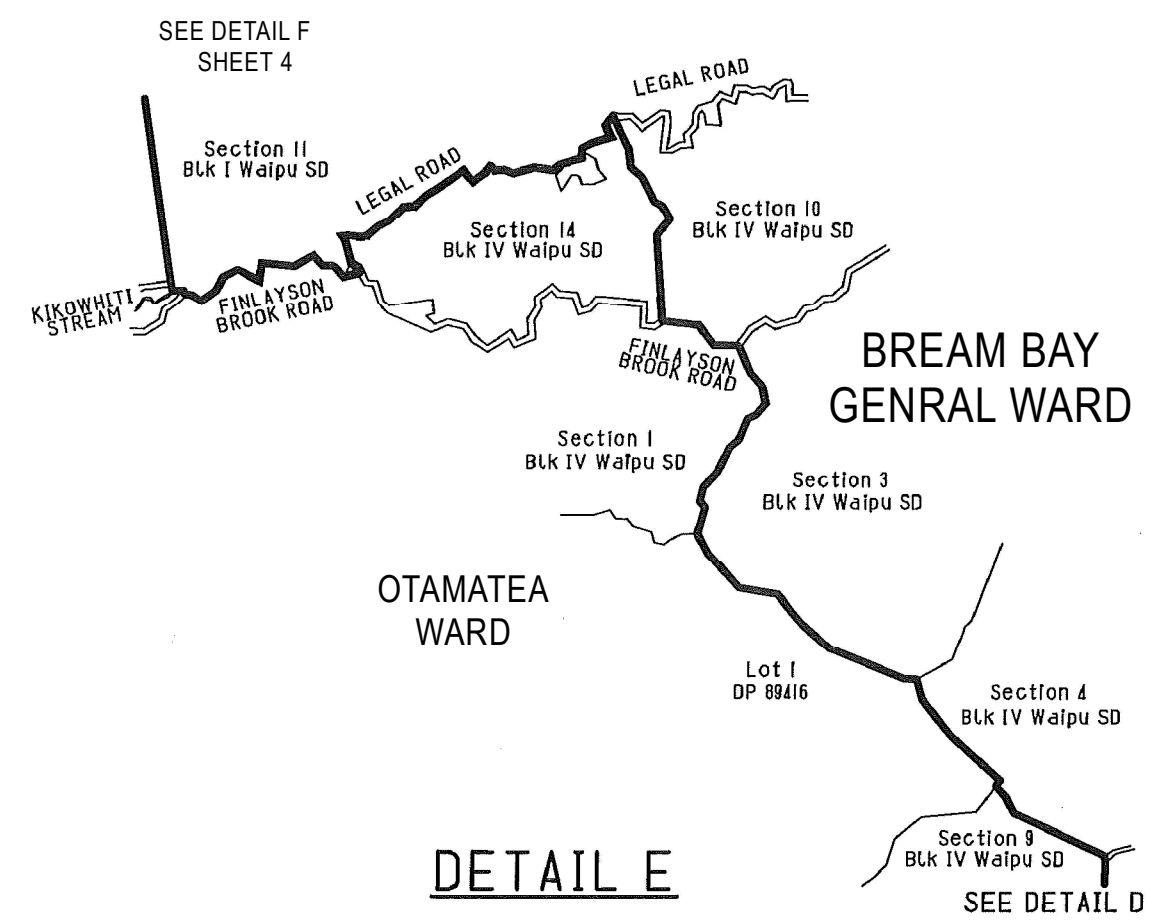
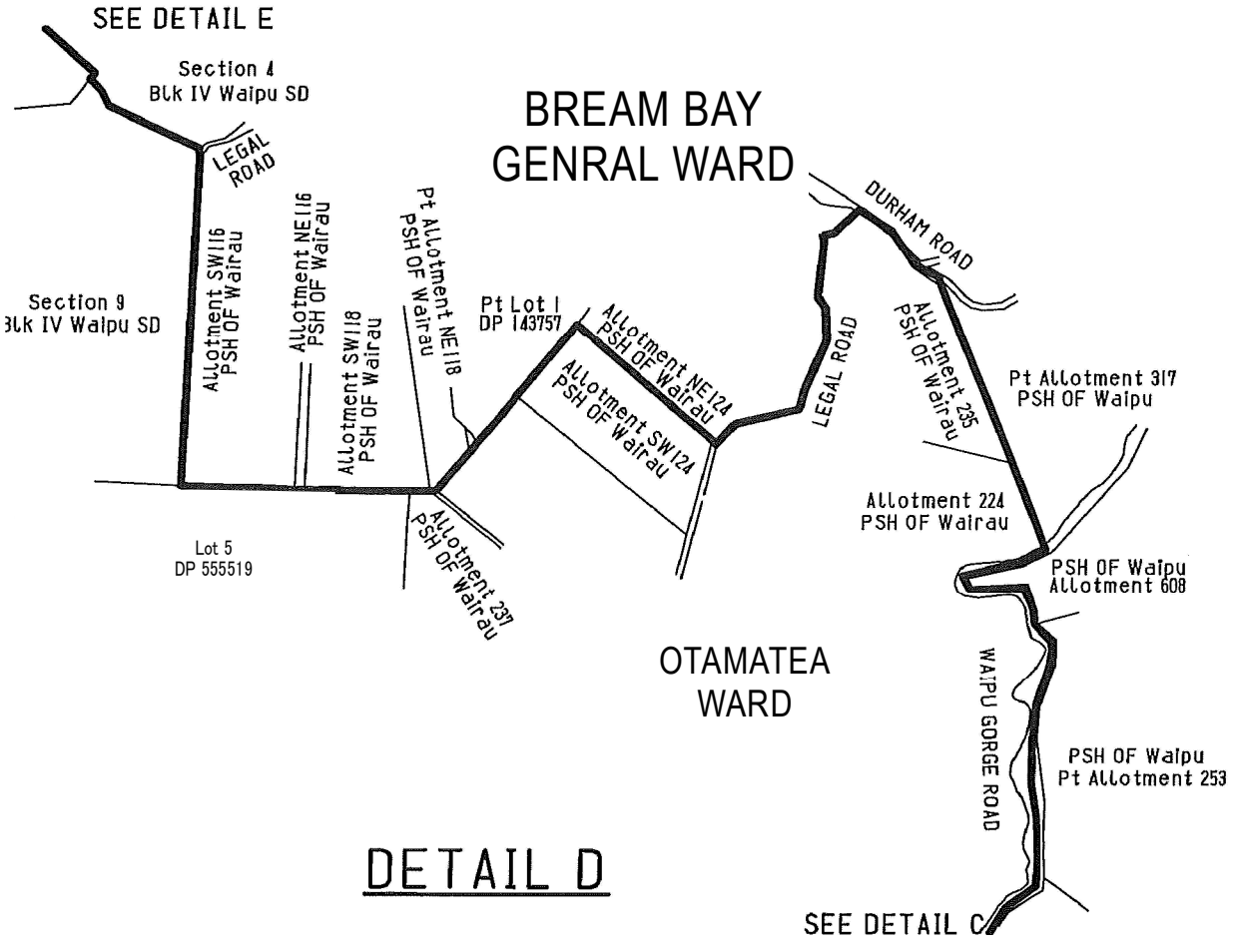
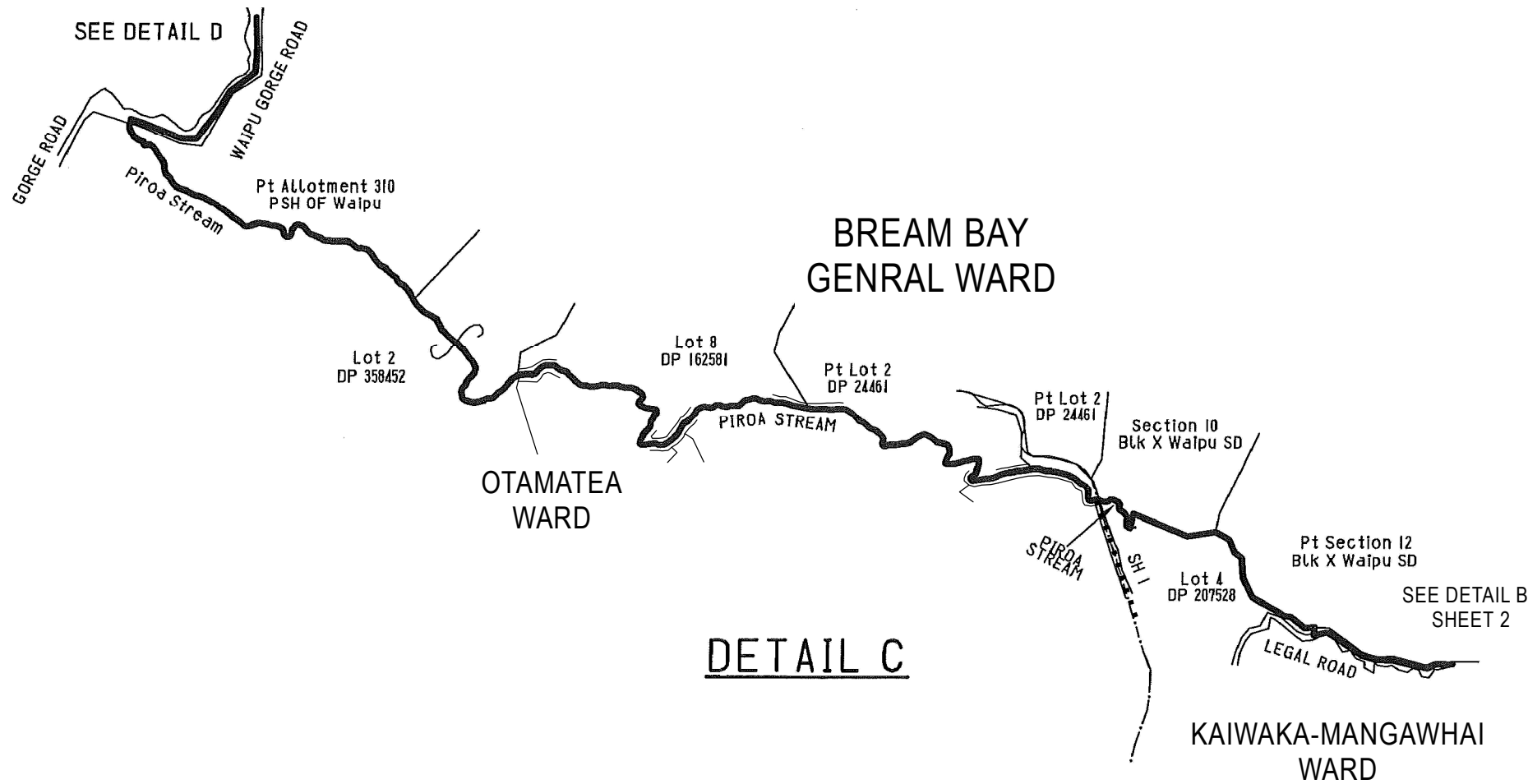
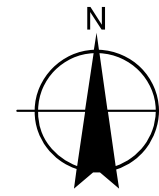

Land District: North Auckland

WHANGAREI DISTRICT BREAM BAY GENERAL WARD

TERRITORIAL AUTHORITY: Whangarei District

Compiled by Jacobs New Zealand Limited

Scale 1:25,000 at A3

Date: May 2022

LG-002-2022-W-3

Sheet 3 of 10

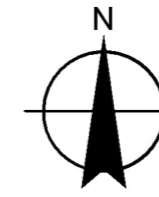

SEE DETAIL G

Pt Lot 2
DP 93017

Allotment 316
PSH OF Waipu

Lot 9
DP 381513

Lot 1
DP 152201

Lot 3
DP 381513

Lot 1
DP 381513

Lot 2
DP 152201

LEGAL ROAD

MILBROOK ROAD

MILBROOK ROAD

LEGAL ROAD

Section 10
Blk I Waipu SD

BREAM BAY
GENRAL WARD

OTAMATEA
WARD

Section 3
Blk I Waipu SD

Crown Land

LEGAL ROAD

LEGAL ROAD

Section 6
Blk I Waipu SD

Allotment 166
PSH OF Māreare-tu

Section 11
Blk I Waipu SD

DETAIL F

SEE DETAIL E
SHEET 3

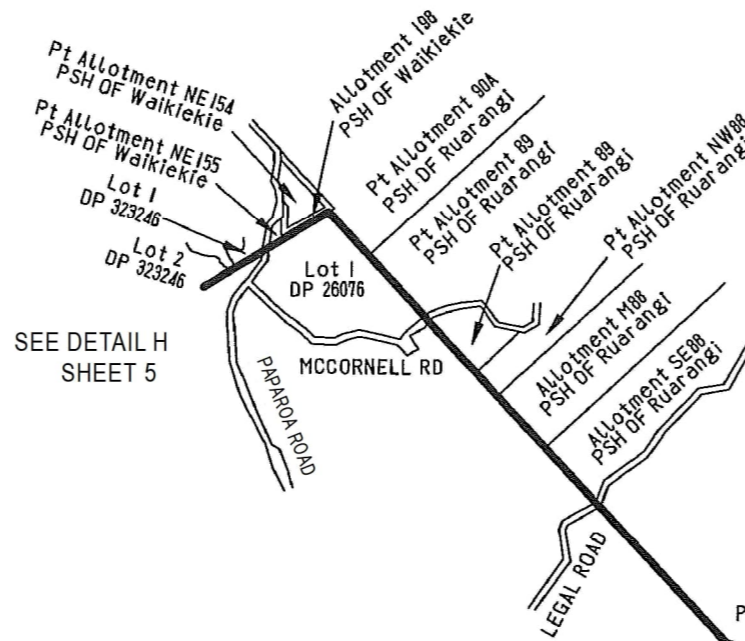

BREAM BAY
GENRAL WARD

OTAMATEA
WARD

Lot 1
DP 86433

Allotment 359
PSH OF Waipu

Pt Lot 2
DP 93017

SEE DETAIL F

DETAIL G

Land District: North Auckland

WHANGAREI DISTRICT BREAM BAY GENERAL WARD

TERRITORIAL AUTHORITY: Whangarei District

Compiled by Jacobs New Zealand Limited

Scale 1:25,000 at A3

Date: May 2022

LG-002-2022-W-3

Sheet 4 of 10

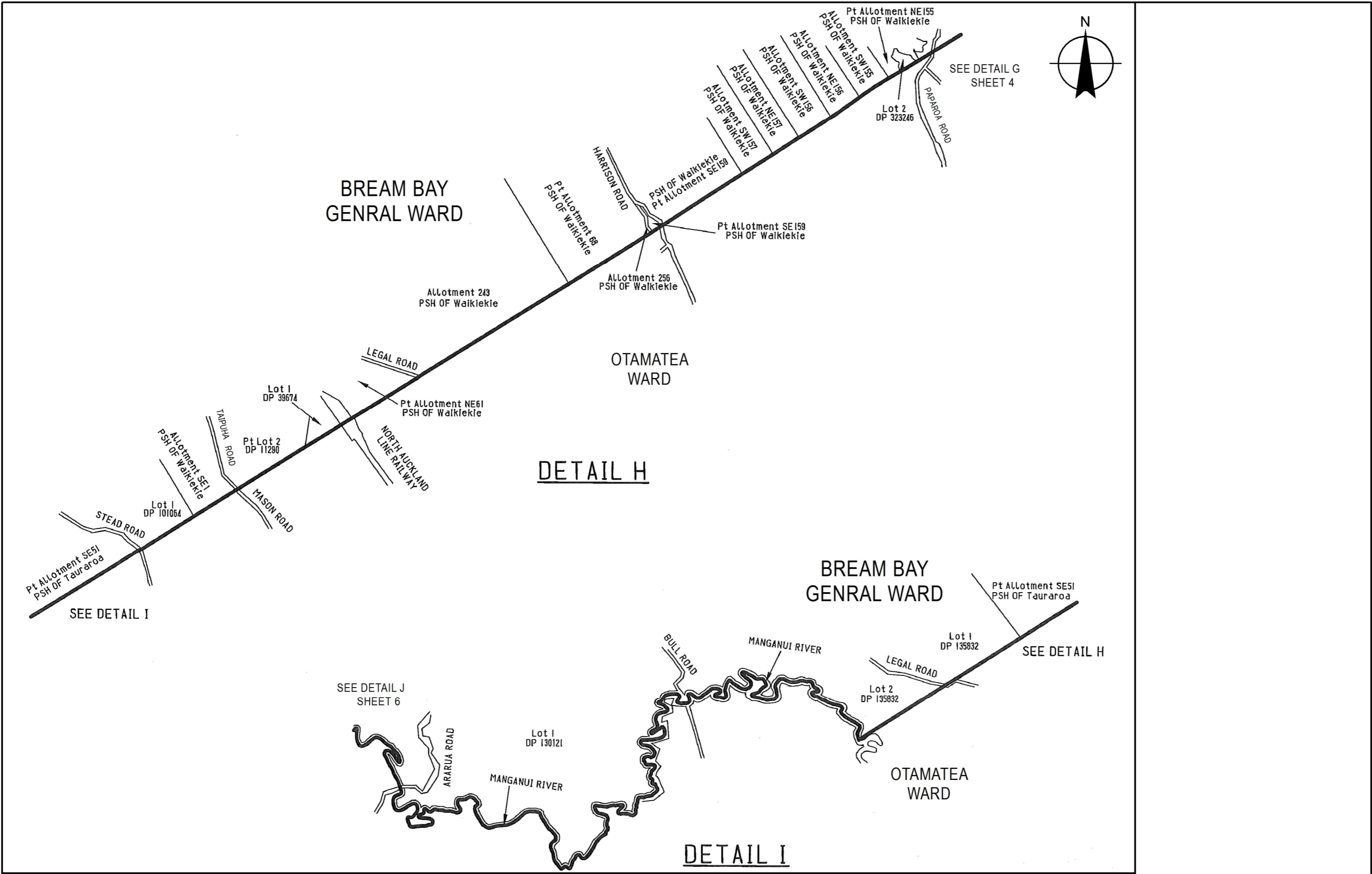

Land District: North Auckland

File IZ049800

WHANGAREI DISTRICT

BREAM BAY GENERAL WARD

TERRITORIAL AUTHORITY: Whangarei District

Compiled by Jacobs New Zealand Limited

Scale 1:25,000 at A3 Date: May 2022

LG-002-2022-W-3

Sheet 5 of 10

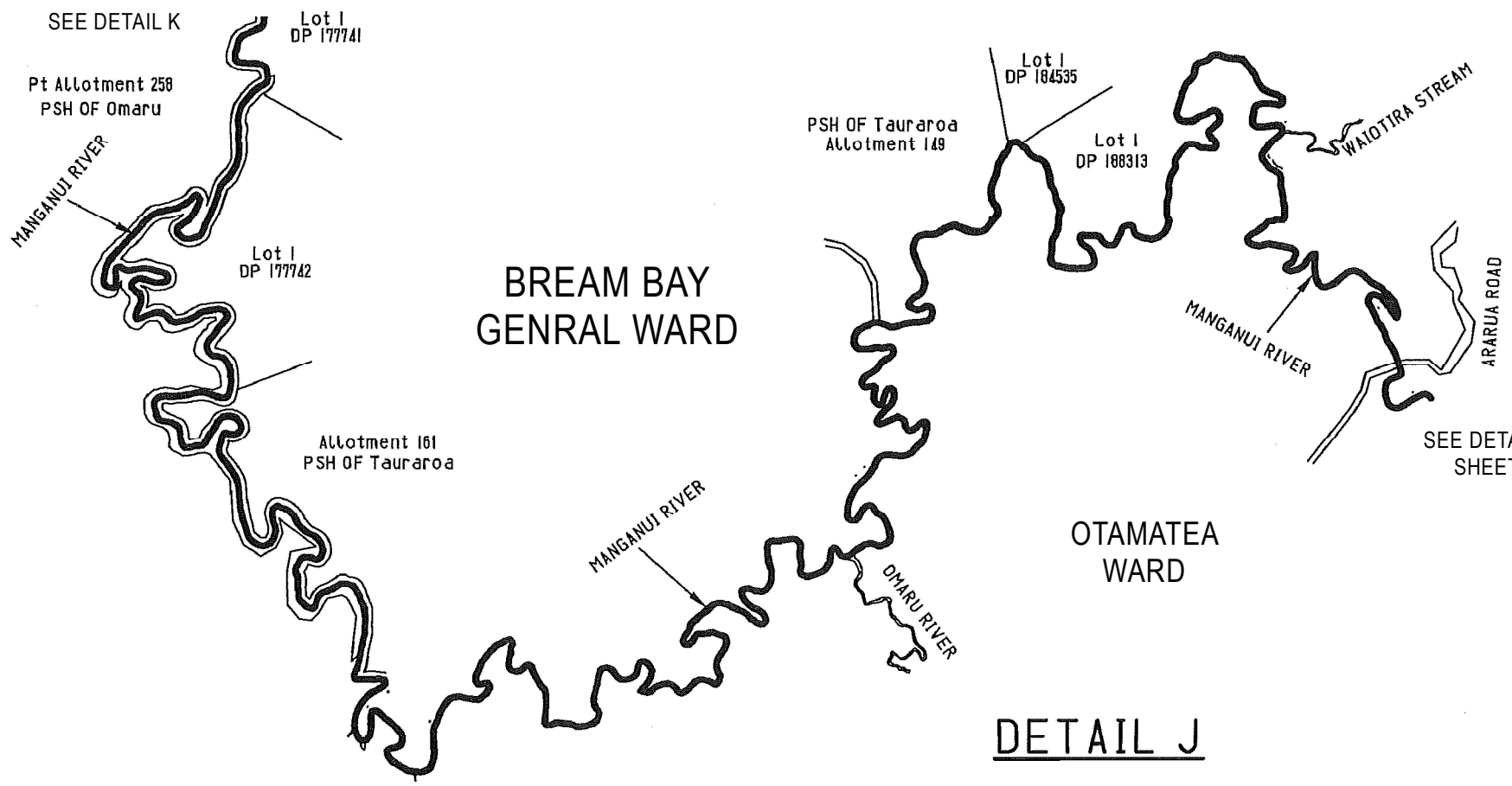
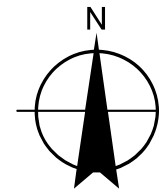

DETAIL J

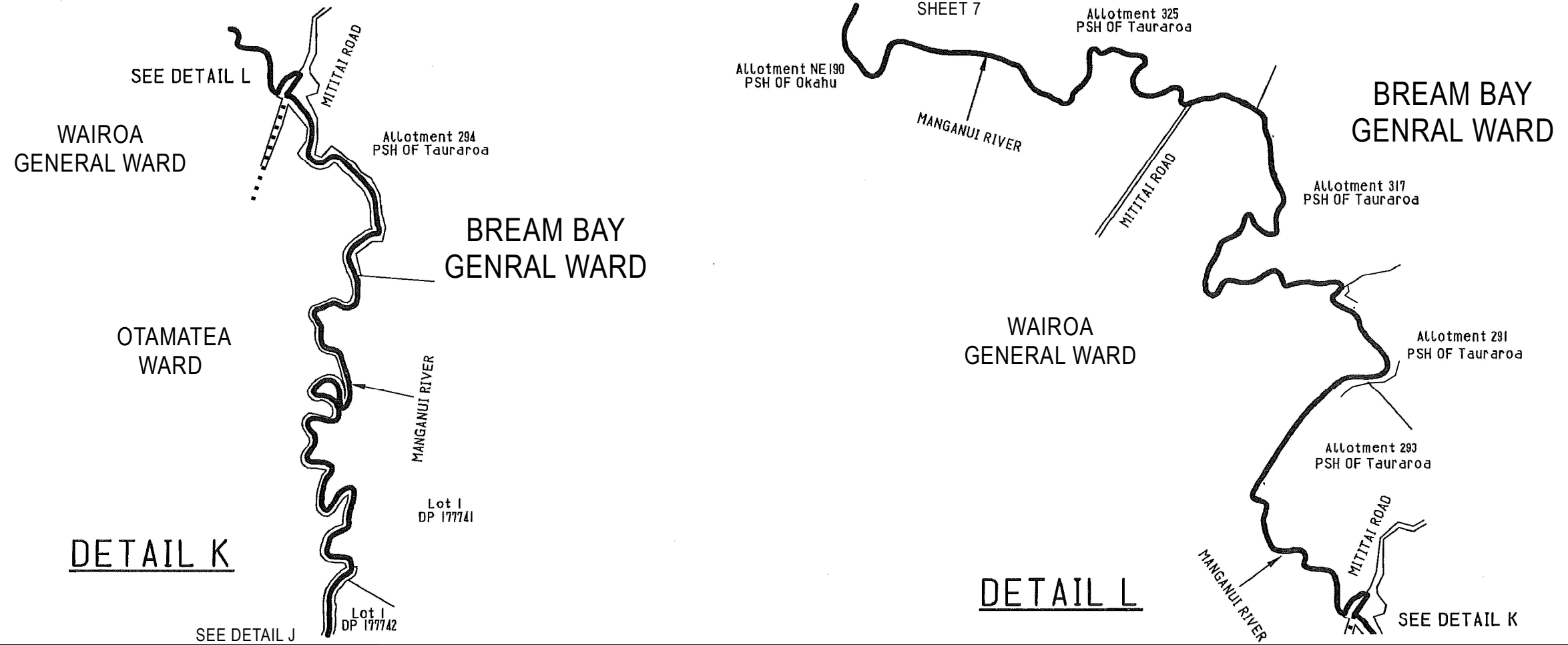

DETAIL K

DETAIL L

Land District: North Auckland

**WHANGAREI DISTRICT
BREAM BAY GENERAL WARD**

TERRITORIAL AUTHORITY: Whangarei District

Compiled by Jacobs New Zealand Limited

Scale 1:25,000 at A3 Date: May 2022

LG-002-2022-W-3

Sheet 6 of 10

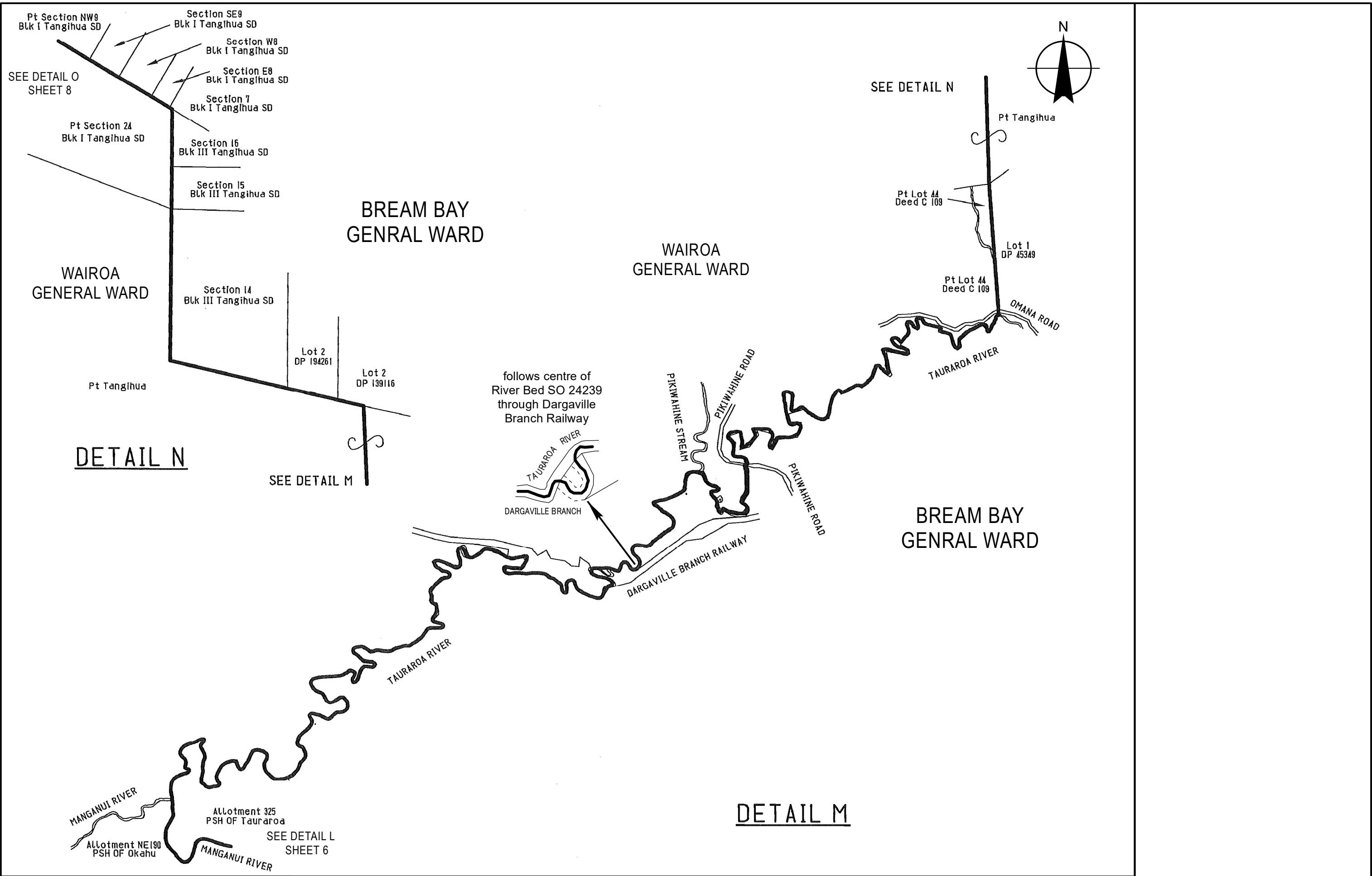

Land District: North Auckland

File IZ049800

WHANGAREI DISTRICT BREAM BAY GENERAL WARD

TERRITORIAL AUTHORITY: Whangarei District
 Compiled by Jacobs New Zealand Limited
 Scale 1:25,000 at A3 Date: May 2022

LG-002-2022-W-3
 Sheet 7 of 10

MANGAKAHIA-
MAUNGATAPERE
GENERAL WARD

WAIROA
GENERAL WARD

SEE DETAIL P

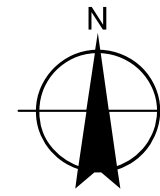

SEE DETAIL Q
SHEET 9

MANGAKAHIA-MAUNGATAPERE
GENERAL WARD

BREAM BAY
GENERAL WARD

SEE DETAIL O

DETAIL P

BREAM BAY
GENERAL WARD

DETAIL O

SEE DETAIL N
SHEET 7

Land District: North Auckland

WHANGAREI DISTRICT BREAM BAY GENERAL WARD

TERRITORIAL AUTHORITY: Whangarei District

Compiled by Jacobs New Zealand Limited

Scale 1:25,000 at A3

Date: May 2022

LG-002-2022-W-3

Sheet 8 of 10

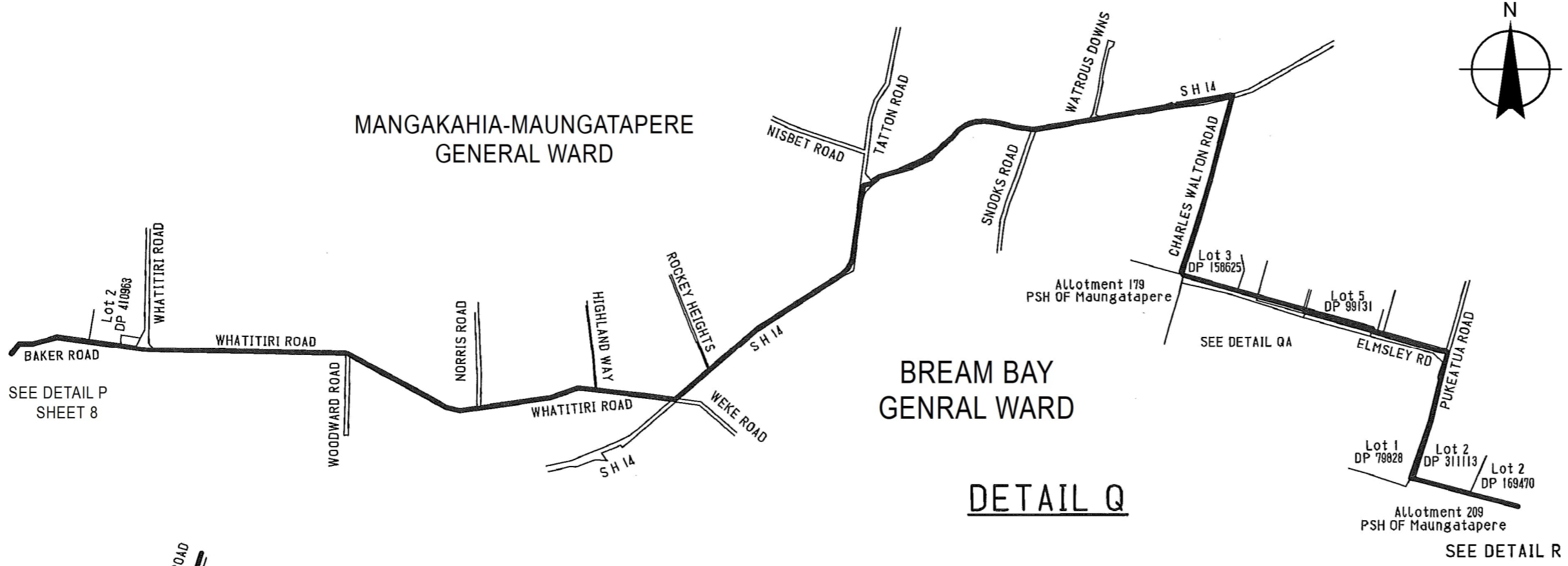

DETAIL Q

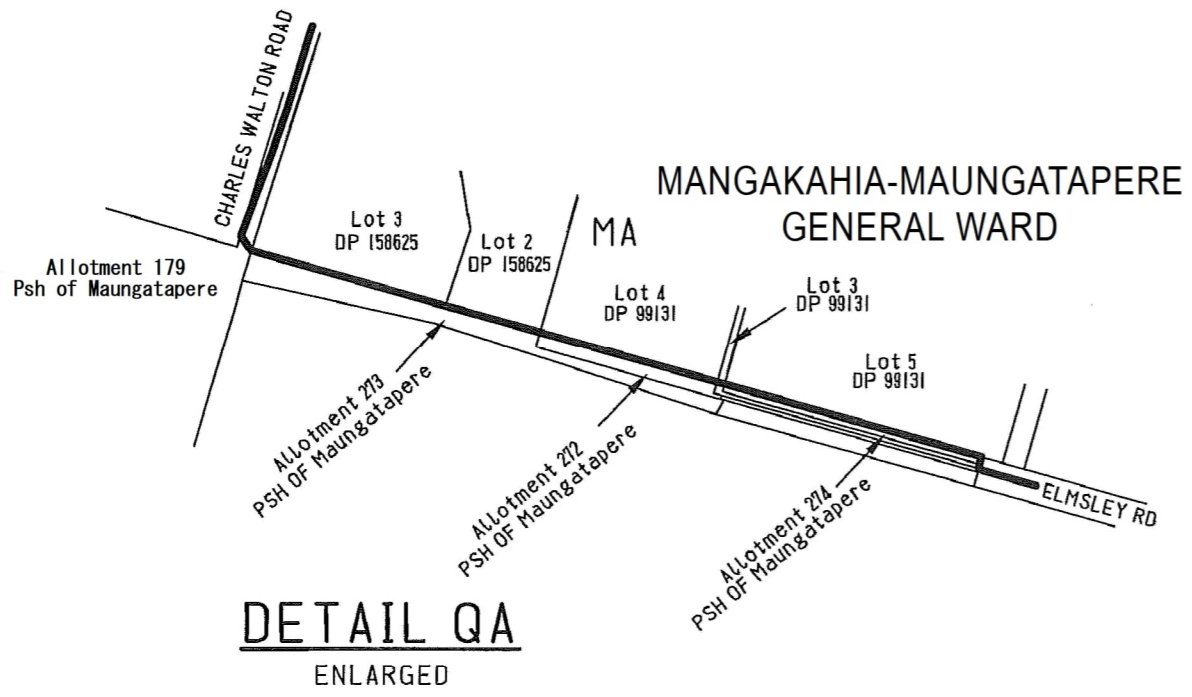

DETAIL QA
ENLARGED

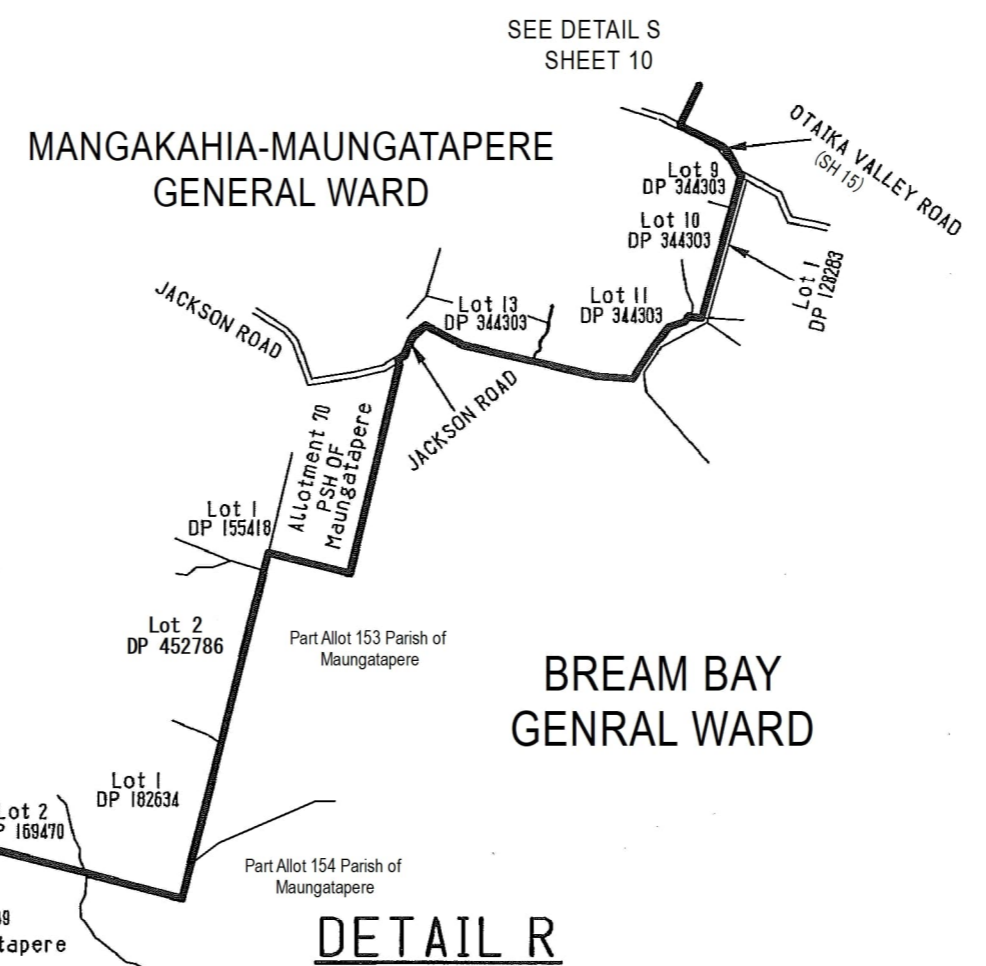

DETAIL R

Land District: North Auckland

File IZ049800

WHANGAREI DISTRICT
BREAM BAY GENERAL WARD

TERRITORIAL AUTHORITY: Whangarei District

Compiled by Jacobs New Zealand Limited

Scale 1:25,000 at A3 Date: May 2022

LG-002-2022-W-3
Sheet 9 of 10

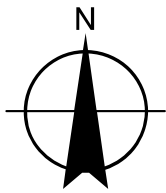

WHANGĀREI URBAN
GENERAL WARD

MANGAKAHIA-MAUNGATAPERE
GENERAL WARD

FOR CONTINUATION
OF BOUNDARIES
SEE
LG-002-2019-W-5

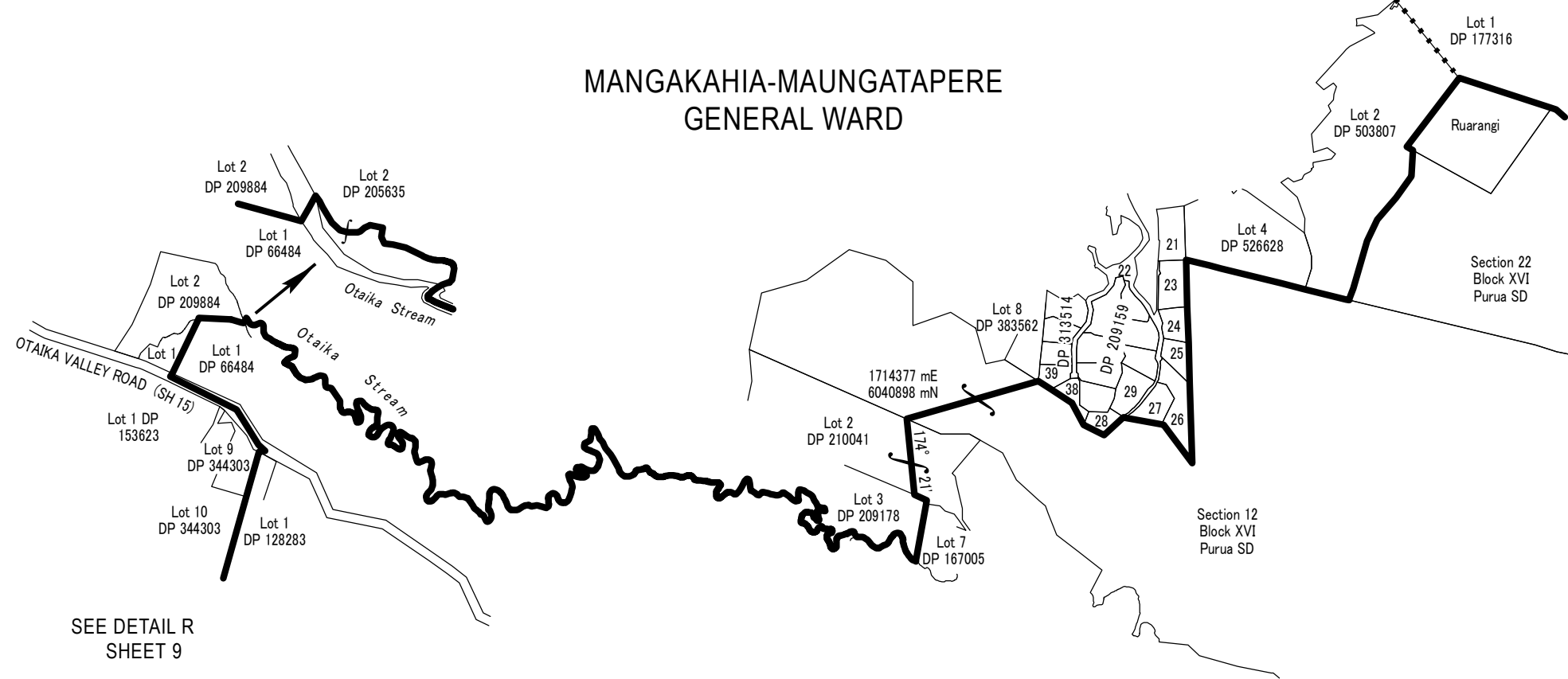

SEE DETAIL R
SHEET 9

DETAIL S

BREAM BAY
GENERAL WARD

Land District: North Auckland

WHANGAREI DISTRICT BREAM BAY GENERAL WARD

TERRITORIAL AUTHORITY: Whangarei District

Compiled by Jacobs New Zealand Limited

Not to scale

Date: May 2022

LG-002-2022-W-3

Sheet 10 of 10