

Far North
General Constituency
LG-01-2022-Con-3

Mid North
General Constituency
LG-01-2022-Con-6

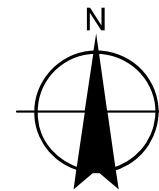

Notes:

1. Coordinates are in terms of New Zealand Transverse Mercator 2000 (NZTM).
2. The seaward boundary is the outer limits of the Territorial Sea as defined by section 3 of the Territorial Sea and Exclusive Economic Zone Act 2001.
3. Where a boundary is shown along a river or road it follows the middle line of the river or legal road unless otherwise shown.

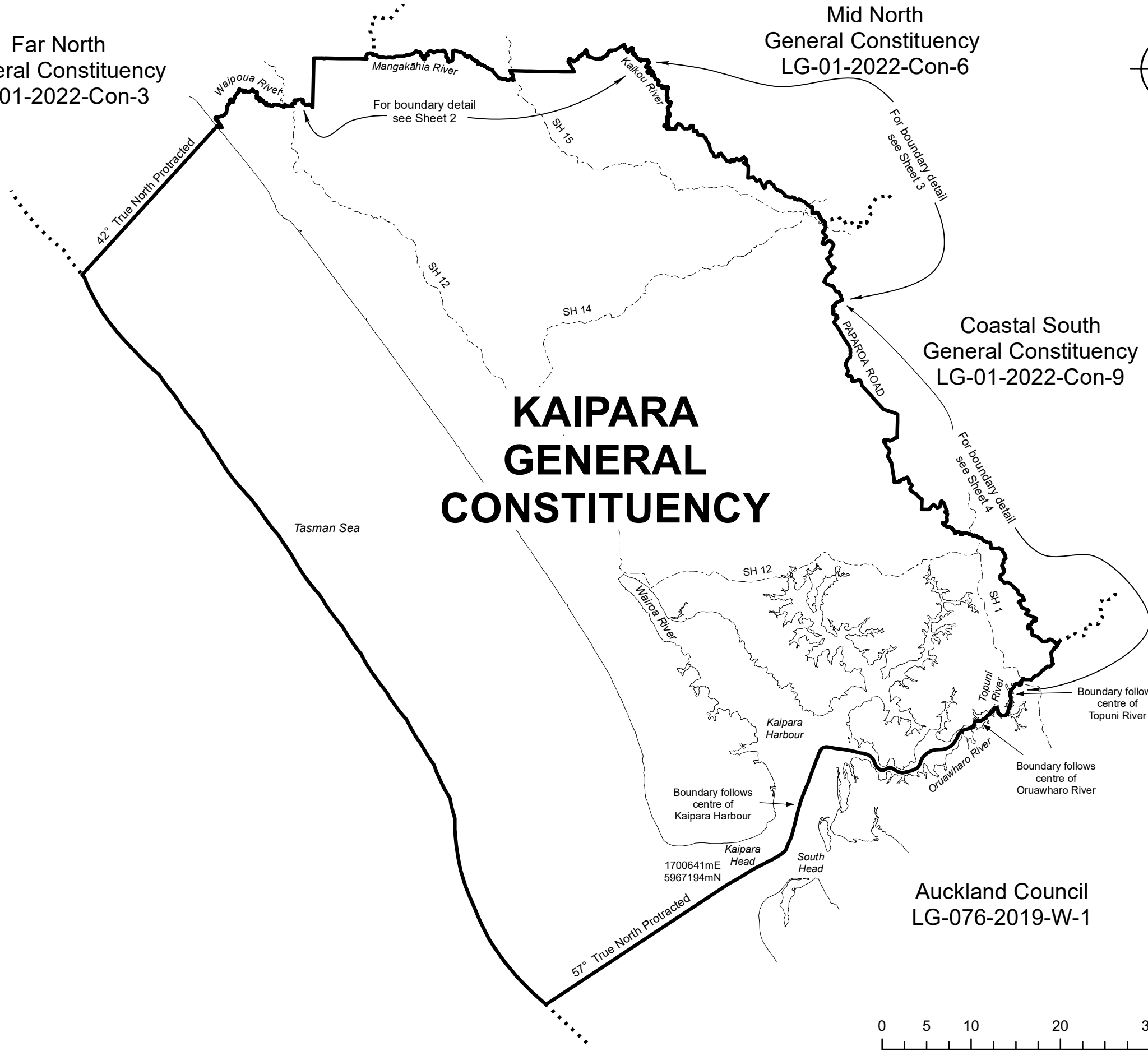

KAIPARA GENERAL CONSTITUENCY

Coastal South
General Constituency
LG-01-2022-Con-9

Auckland Council
LG-076-2019-W-1

Land District: North Auckland

NORTHLAND REGION KAIPARA GENERAL CONSTITUENCY

TERRITORIAL AUTHORITY: Whangarei and Kaipara Districts
Compiled by Jacobs New Zealand Limited
Scale 1:475,000 at A3 Date: July 2022

LG-01-2022-Con-5
Sheet 1 of 4

Notes:

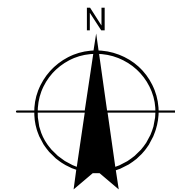

Far North General Constituency

Mid North General Constituency

Kaipara General Constituency

Mid North General Constituency

Kaipara General Constituency

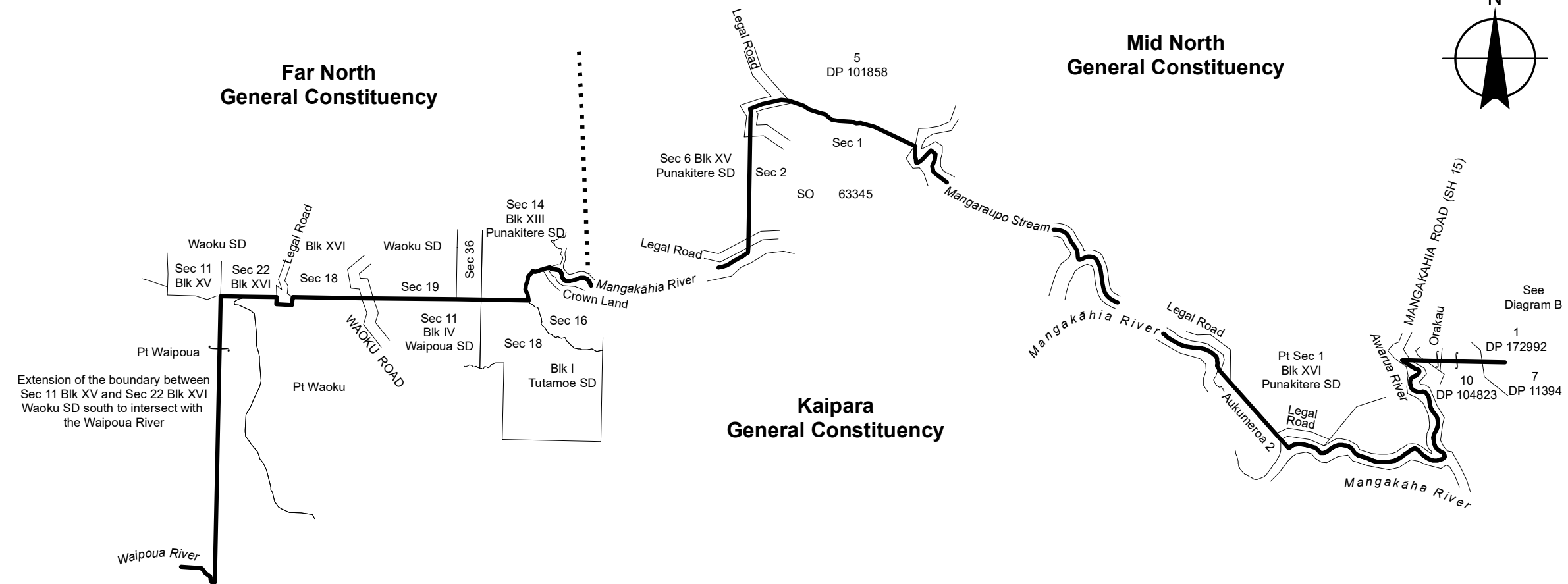

Diagram A

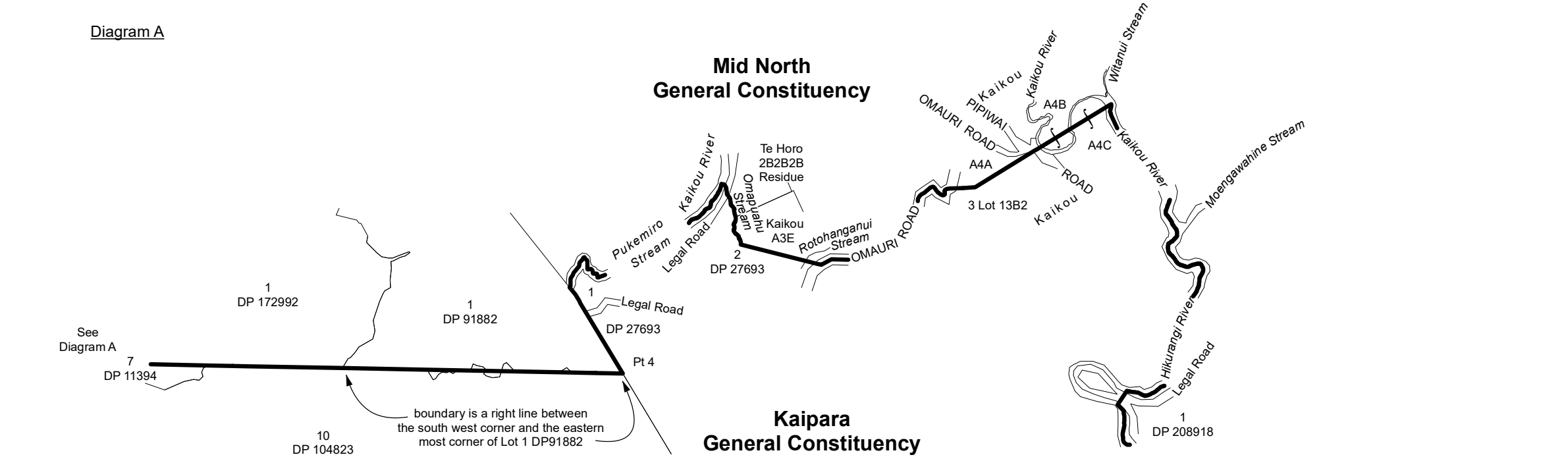

Diagram B

Land District: North Auckland

NORTHLAND REGION KAIPARA GENERAL CONSTITUENCY

TERRITORIAL AUTHORITY: Whangarei and Kaipara Districts
Compiled by Jacobs New Zealand Limited
Not To Scale Date: July 2022

LG-01-2022-Con-5
Sheet 2 of 4

