

Pacific Ocean

# WHANGAROA SUBDIVISION

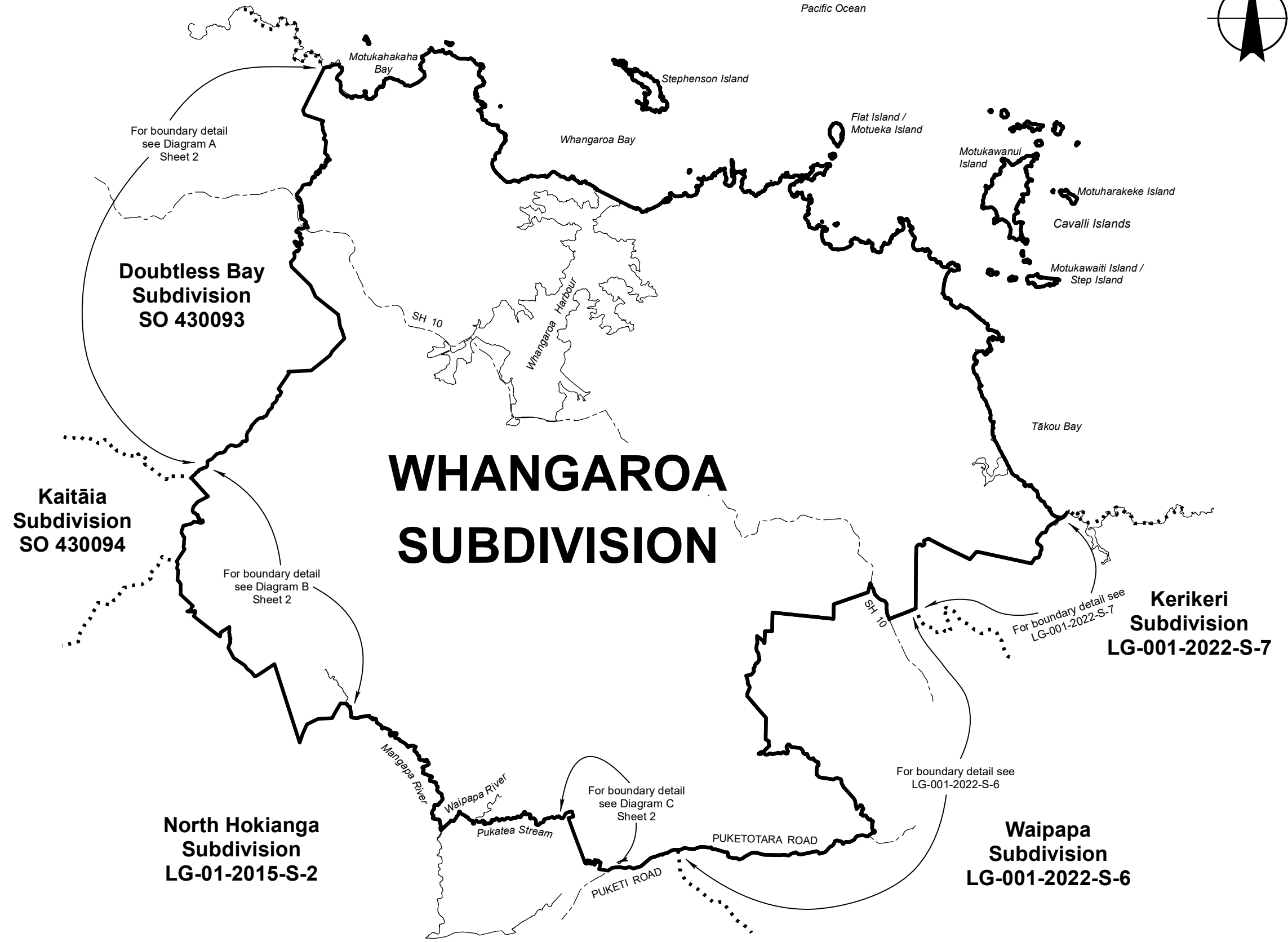

- Notes:
1. Coordinates are in terms of New Zealand Transverse Mercator 2000 (NZTM).
  2. Where a boundary is shown along a river or road it follows the middle line of the physical river or legal road unless otherwise shown.
  3. All seaward boundaries follow mean High Water mark but cross the mouths of all rivers, streams, inlets and estuaries unless otherwise shown.
  4. All adjacent islands and islets are included in the Subdivision.

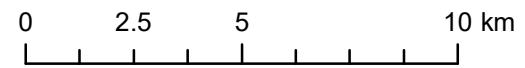

Land District: North Auckland

## FAR NORTH DISTRICT WHANGAROA SUBDIVISION

TERRITORIAL AUTHORITY: Far North District  
 Compiled by Jacobs New Zealand Limited  
 Scale 1:175,000 at A3 Date: August 2022

**LG-001-2022-S-5**  
 Sheet 1 of 2

**Diagram A**  
Not to Scale

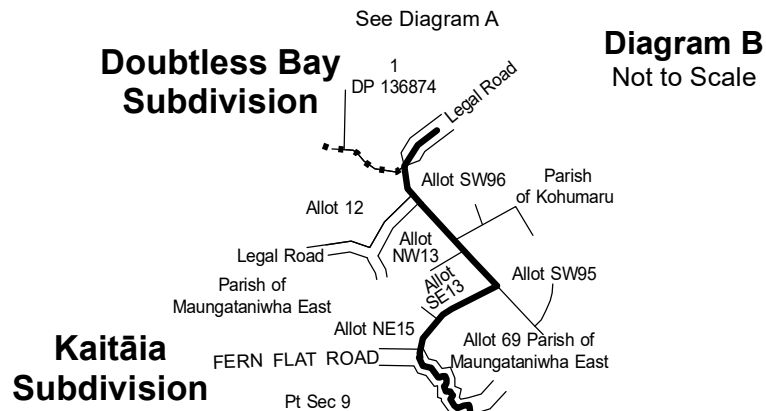
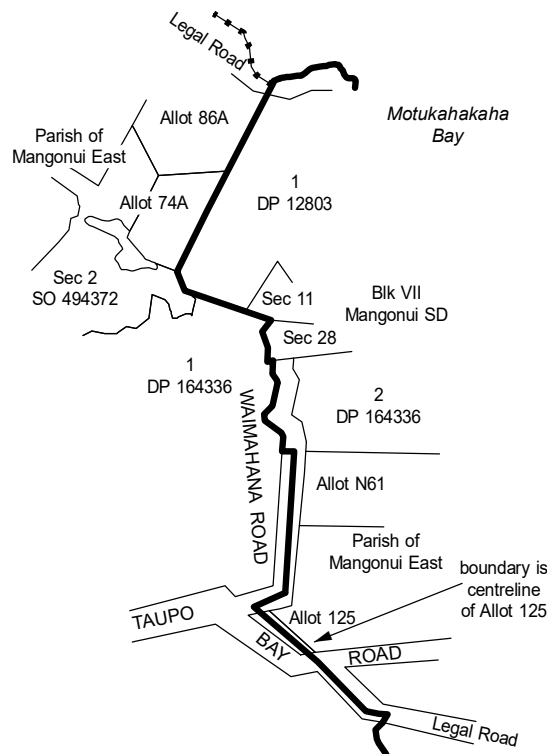

**Diagram B**  
Not to Scale

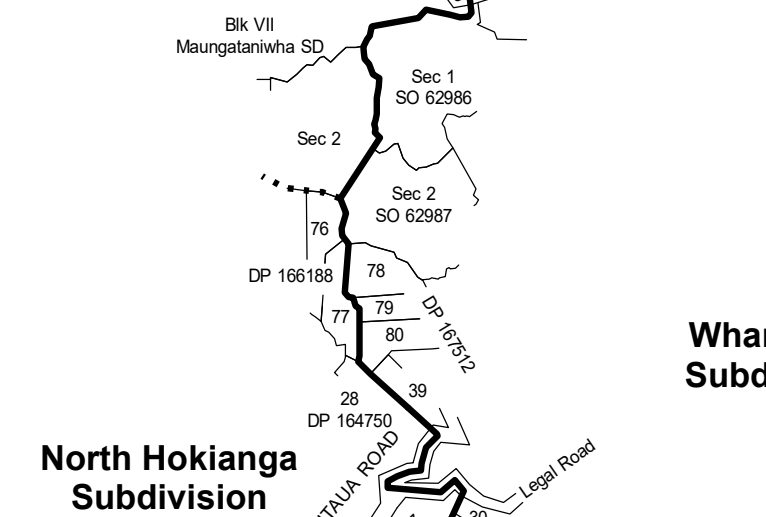
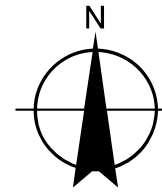

**Whangaroa Subdivision**

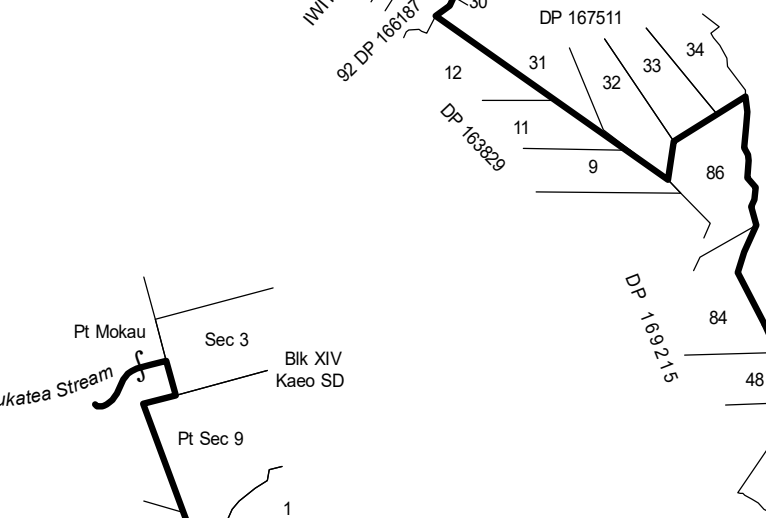

**Whangaroa Subdivision**

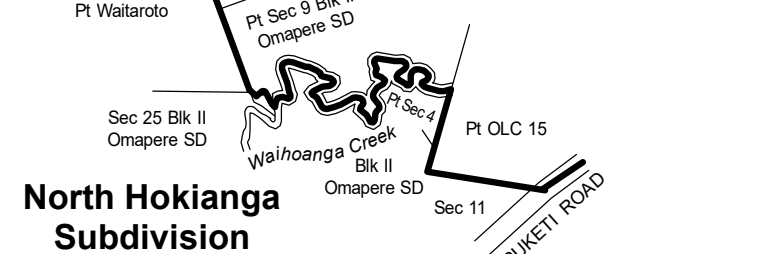

**North Hokianga Subdivision**

**Diagram C**  
Not to Scale

**Doubtless Bay Subdivision**

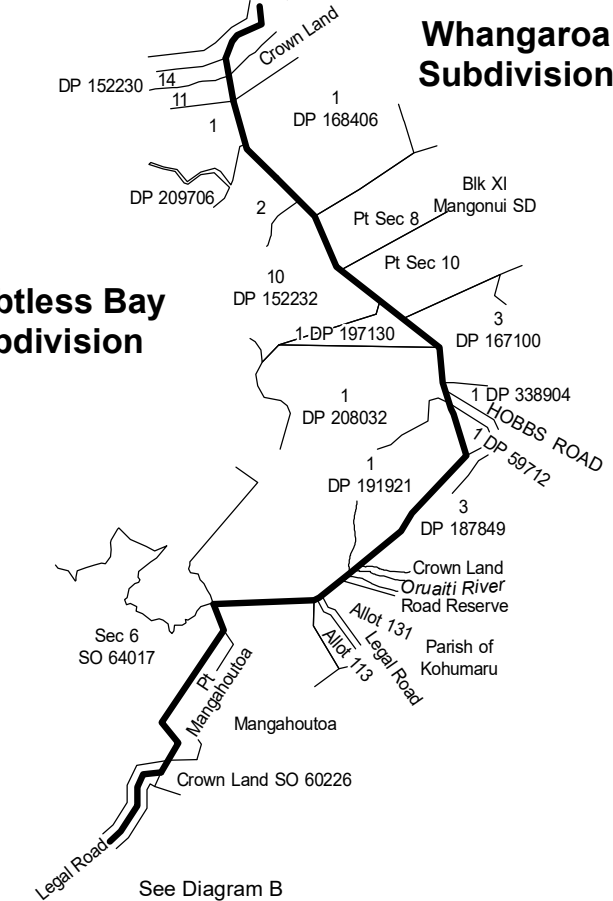

**Whangaroa Subdivision**

**North Hokianga Subdivision**

Land District: North Auckland

# FAR NORTH DISTRICT WHANGAROA SUBDIVISION

TERRITORIAL AUTHORITY: Far North District

Compiled by Jacobs New Zealand Limited

Not to scale

Date: August 2022

**LG-001-2022-S-5**  
Sheet 2 of 2