

- Notes:
1. Coordinates are in terms of New Zealand Transverse Mercator 2000 (NZTM).
 2. Where a boundary is shown along a river or road it follows the middle line of the physical river or legal road unless otherwise shown.
 3. Where a boundary is shown along a railway it follows the middle line of the cadastral railway unless otherwise shown.
 4. All seaward boundaries follow mean High Water mark but cross the mouths of all rivers, streams, inlets and estuaries unless otherwise shown.

**Paihia Subdivision
LG-001-2022-S-8**

**Kaikohe Subdivision
LG-001-2022-S-4**

**Russell-Ōpua
Subdivision
LG-001-2022-S-9**

**South Hokianga
Subdivision
LG-01-2022-S-3**

**KAWAKAWA-MOEREW
SUBDIVISION**

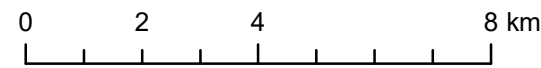
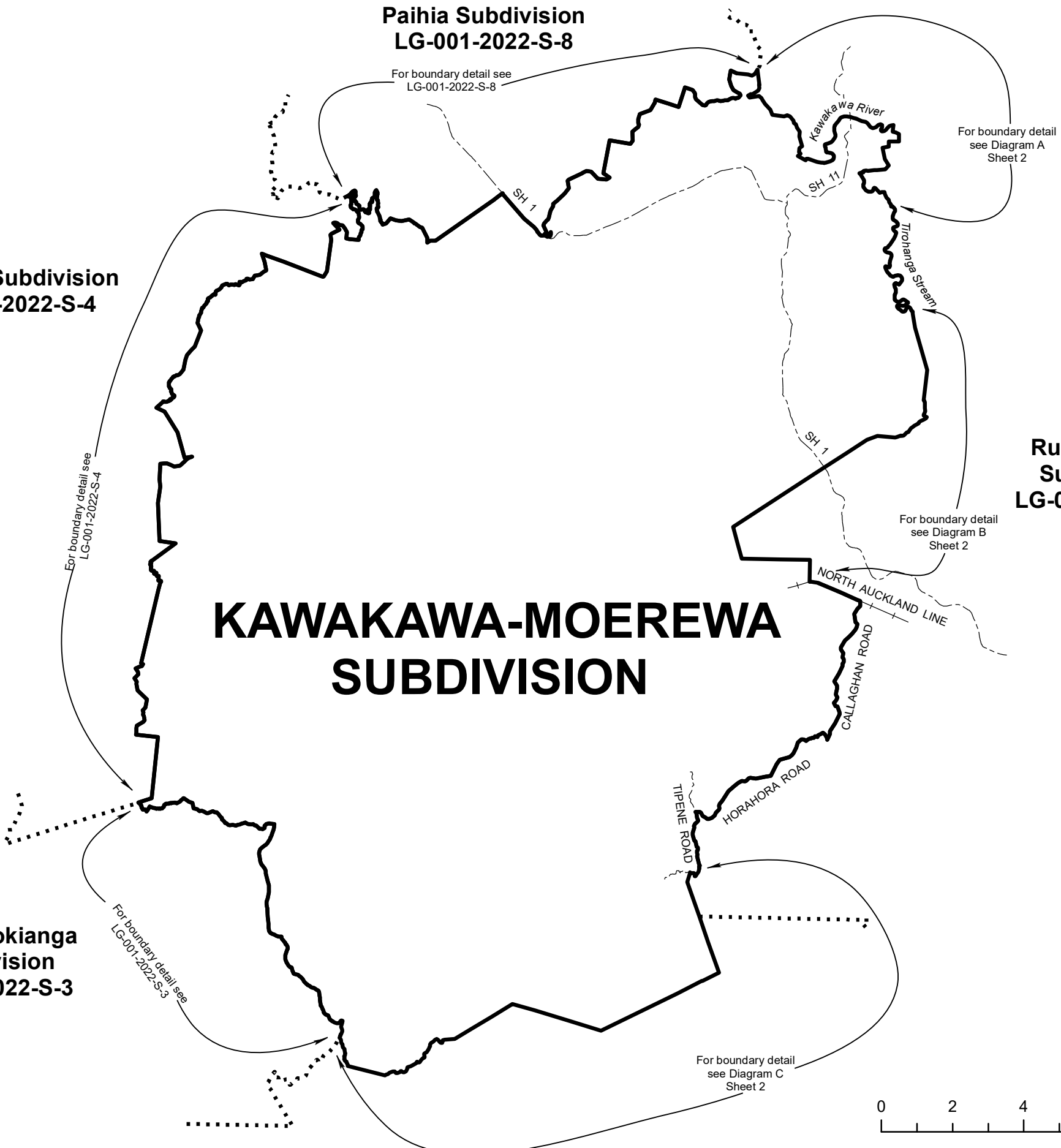

Land District: North Auckland

**FAR NORTH DISTRICT
KAWAKAWA-MOEREW
SUBDIVISION**

TERRITORIAL AUTHORITY: Far North District
Compiled by Jacobs New Zealand Limited
Scale 1:130,000 at A3 Date: August 2022

LG-001-2022-S-10
Sheet 1 of 2

Diagram A
Not to Scale

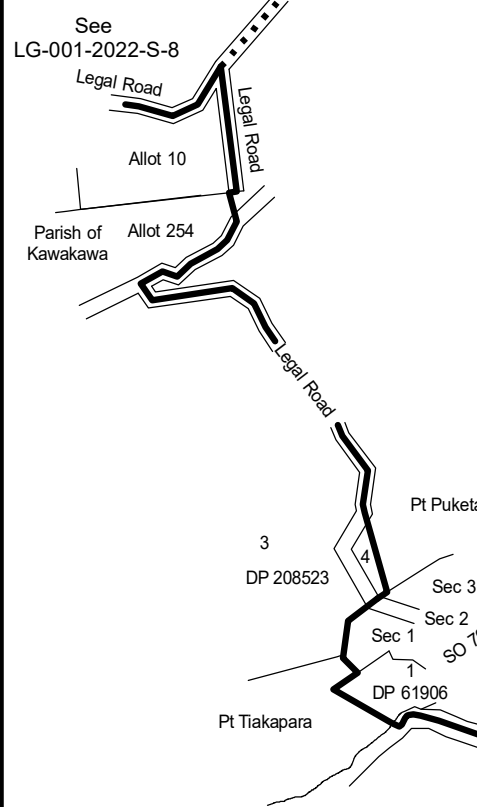

Russell-Ōpua Subdivision

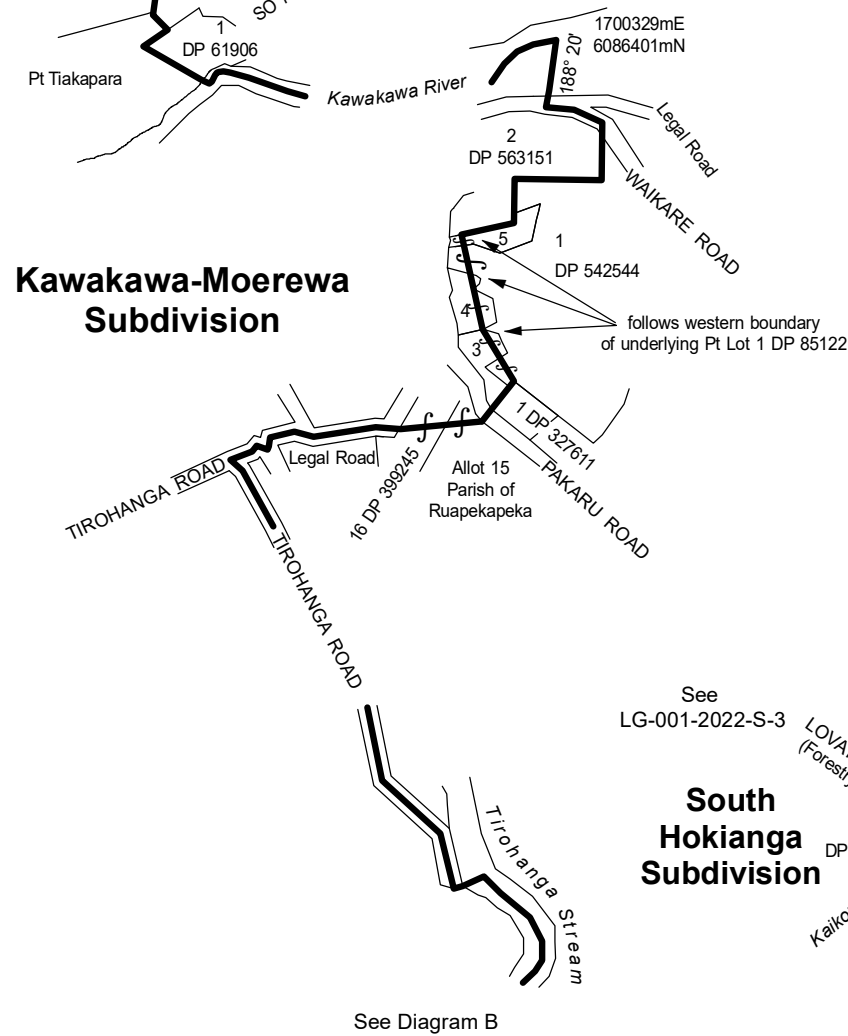

Kawakawa-Moerewa Subdivision

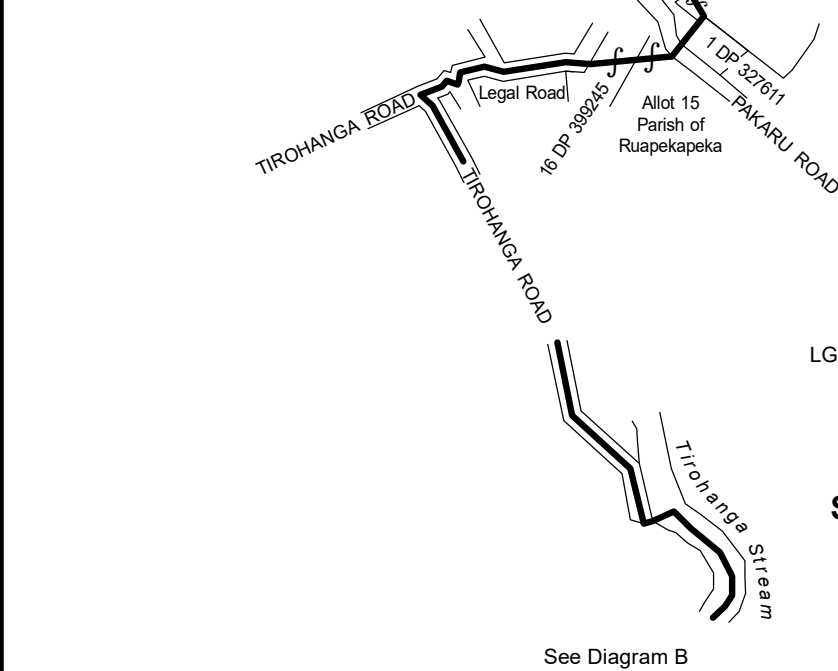
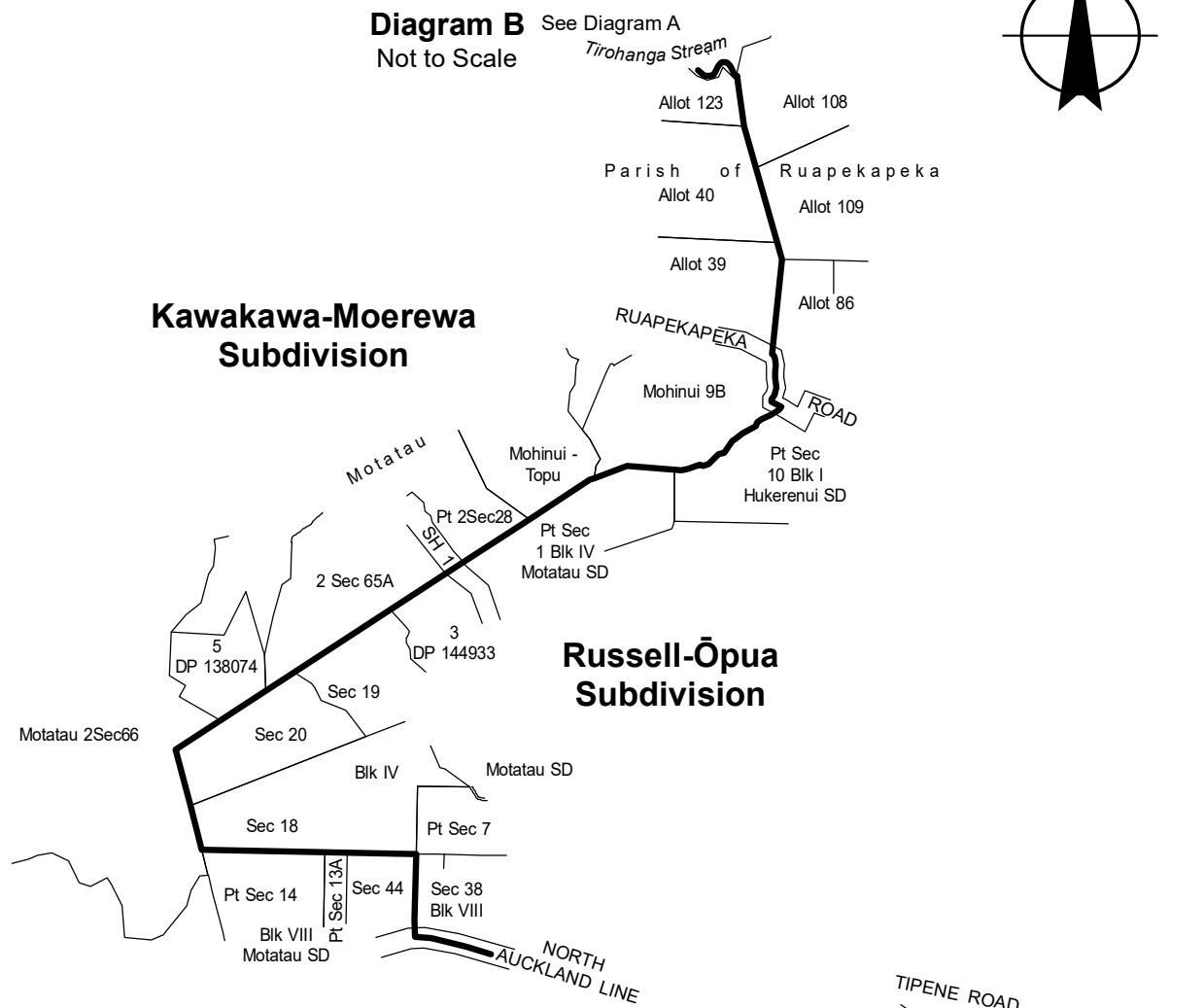
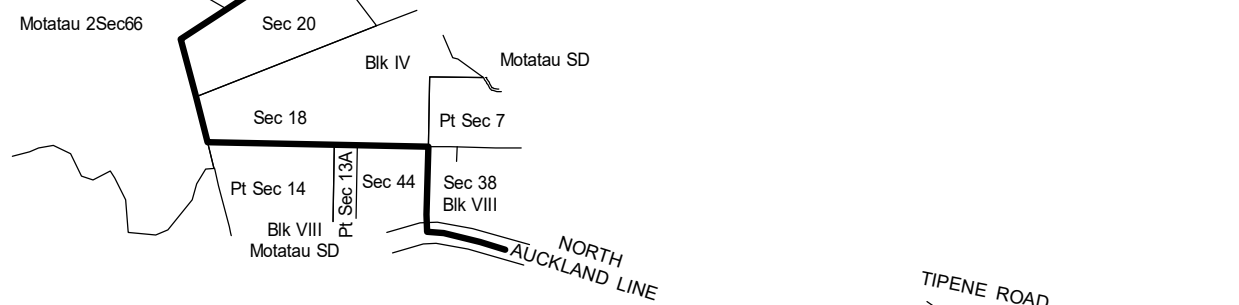

Diagram B
Not to Scale



Russell-Ōpua Subdivision



Kawakawa-Moerewa Subdivision

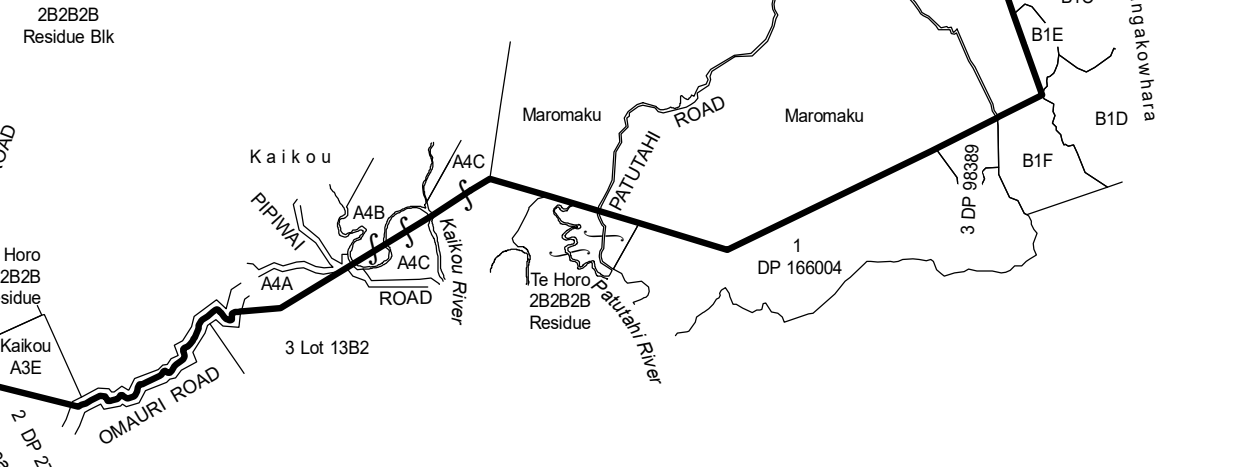

South Hokianga Subdivision

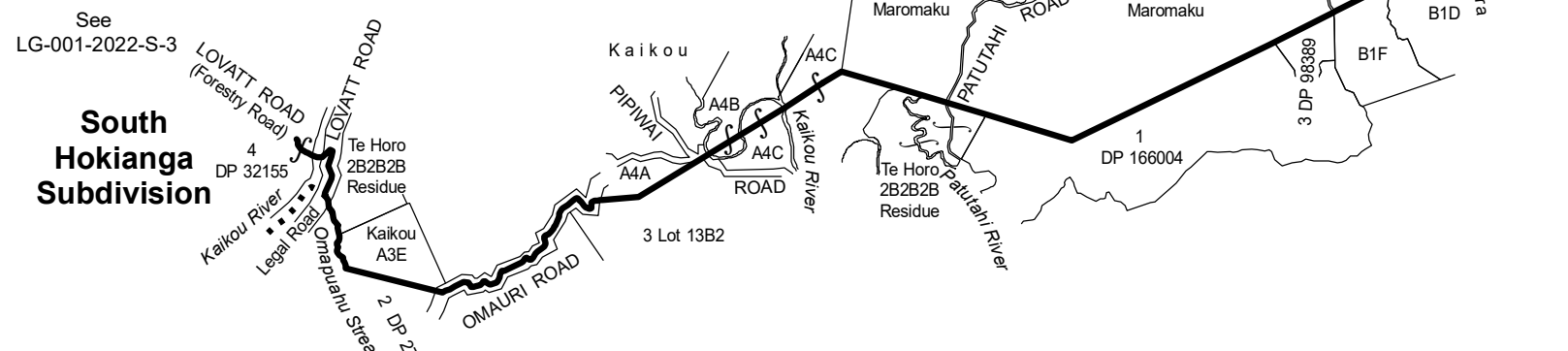
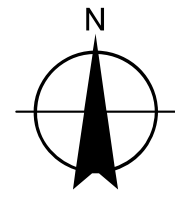

Diagram C
Not to Scale



Land District: North Auckland

FAR NORTH DISTRICT

KAWAKAWA-MOEREWASUBDIVISION

TERRITORIAL AUTHORITY: Far North District

Compiled by Jacobs New Zealand Limited

Not to scale

Date: August 2022

LG-001-2022-S-10

Sheet 2 of 2