

SO 36024 (Title Plan)

Copy - 01/01, Pgs - 001, 14/07/04, 09:09



DocID: 410125030

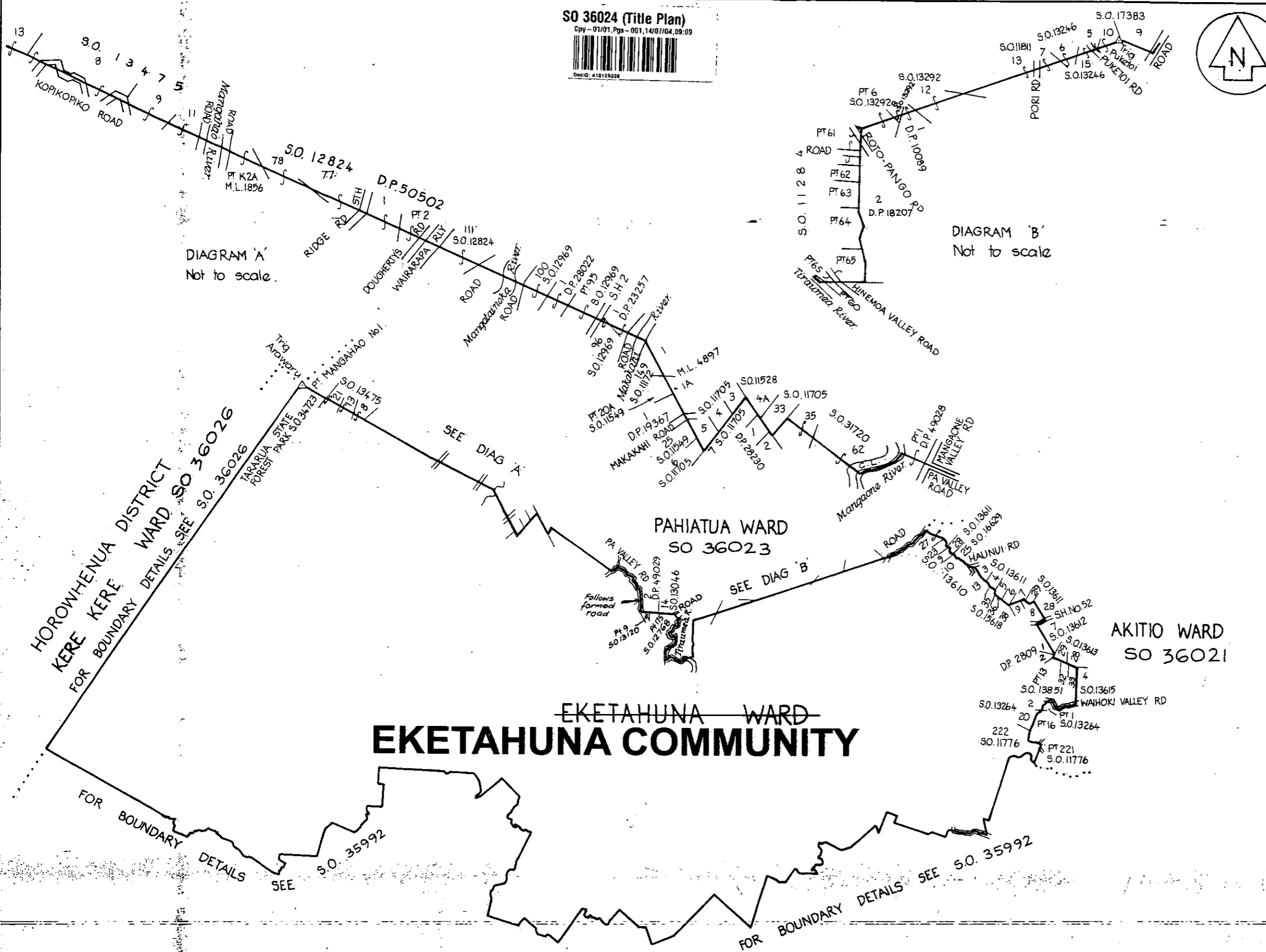
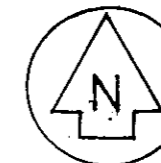

DIAGRAM 'A'  
Not to scale.

DIAGRAM 'B'  
Not to scale

# EKETAHUNA COMMUNITY

SO. 35992 RURAL WARD MASTERTON DISTRICT

## EKETAHUNA COMMUNITY EKETAHUNA WARD

Approvals  
**NOTE:**  
Where a Boundary is shown along a river or road it follows the middle line of the physical river or legal road unless shown otherwise

For full description of adjoining sections refer to plans shown

Amended as per the Local Government Commission determination dated 7/4/04 pursuant to section 19R(1)(b) Local Electoral Act 2001.

*Dienebos* 1/7/04  
Chief Executive  
Local Government Commission

I certify that this plan renders the boundary capable of identification under section 19Y(3)(b) Local Electoral Act 2001.

*[Signature]* 13/7/2004  
Approving Surveyor

Total Area .....

Comprised in .....

I, .....  
Registered Surveyor and holder of an annual practising certificate (or who may act as a registered surveyor pursuant to section 25 of the Survey Act 1986) hereby certify that this plan has been made from surveys executed by me or under my directions, that both plan and survey are correct and have been made in accordance with the Survey Regulations 1972 or any regulations made in substitution thereof.

Dated at ..... this ..... day  
of ..... 19..... Signature .....

Field Book ..... p. .... Traverse Book ..... p. ....

Reference Plans .....

Examined ..... Correct .....

Approved for Gazette Purposes

7/6/1989 *[Signature]* Chief Surveyor

Deposited this ..... day of ..... 19.....

District Land Registrar

File  
Received  
Instructions  
**S036024**

LAND DISTRICT Wellington  
Survey Blk. & Dist.  
525, 725, 24  
NZMS 261 Sheet U25 Record Map No.

TERRITORIAL AUTHORITY Tararua District  
Surveyed by Dept. of Survey & Land Information  
Scale 1:150000 Date June, 1989