

Notes:

1. Where a boundary is shown along a river or road it follows the middle line of the river or legal road unless otherwise shown.
2. All seaward boundaries follow Mean Low Water Springs but cross the mouths of all rivers, streams, inlets and estuaries except where shown otherwise.

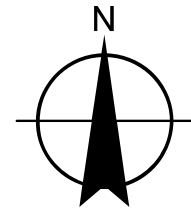

Diagram

Not to scale

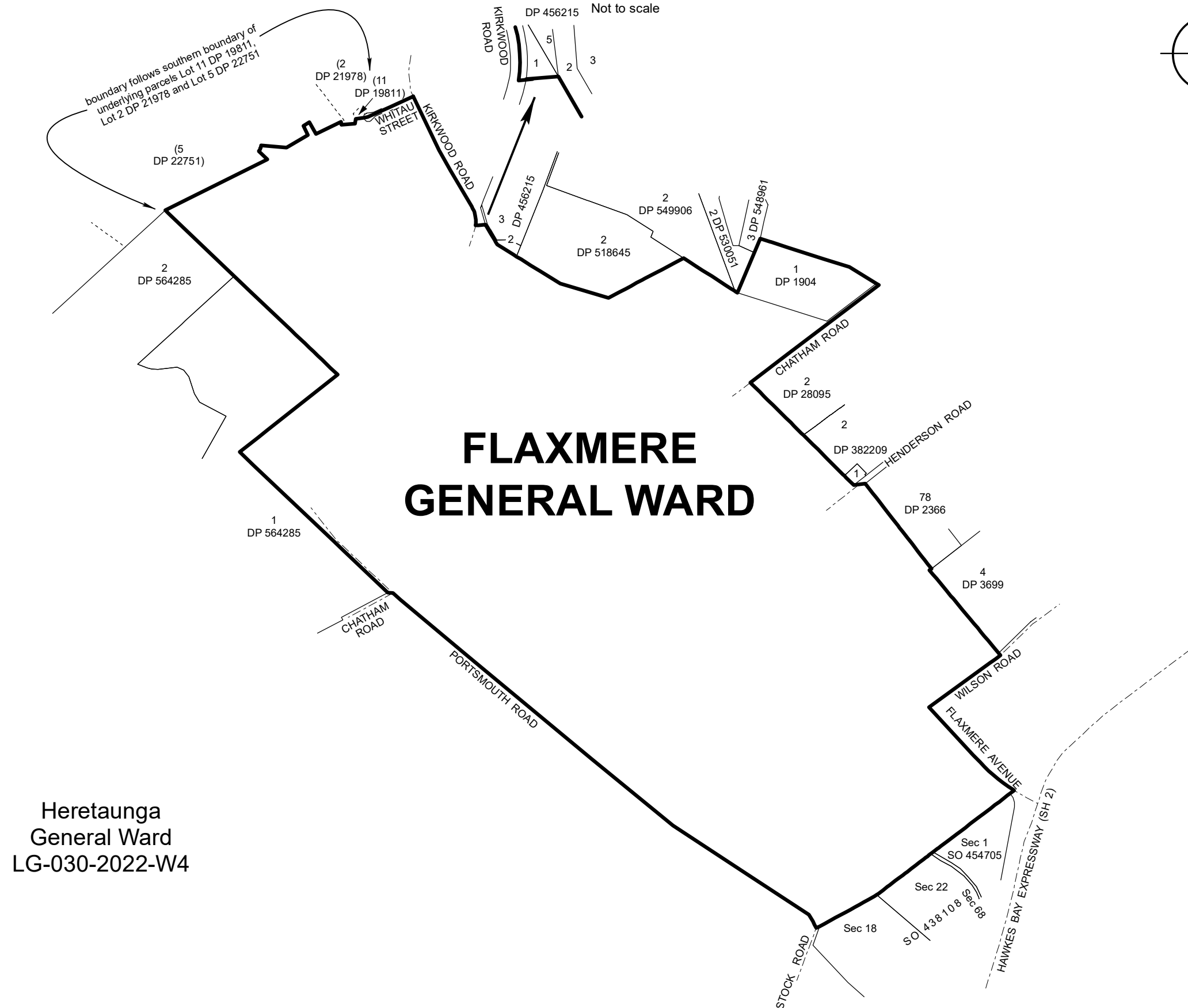

FLAXMERE GENERAL WARD

Heretaunga
General Ward
LG-030-2022-W4

Land District: Hawkes Bay

HASTINGS DISTRICT FLAXMERE GENERAL WARD

TERRITORIAL AUTHORITY: Hastings District
Compiled by Jacobs New Zealand Limited
Scale 1:15,000 at A3 Date May 2022

LG-030-2022-W-5