

Notes:

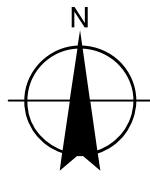
1. Coordinates are in terms of New Zealand Transverse Mercator 2000 (NZTM).
2. The seaward boundary follows Mean Low Water Springs but crosses the mouths of all rivers, streams, inlets and estuaries except where shown otherwise.
3. The area between the mean high water mark and the limit of the Territorial Sea is included within the jurisdiction of the Gisborne District Council for the purposes of the functions, duties and powers of a regional council. Refer to SO 8379 for region boundary.

Land District: Gisborne & Hawkes Bay

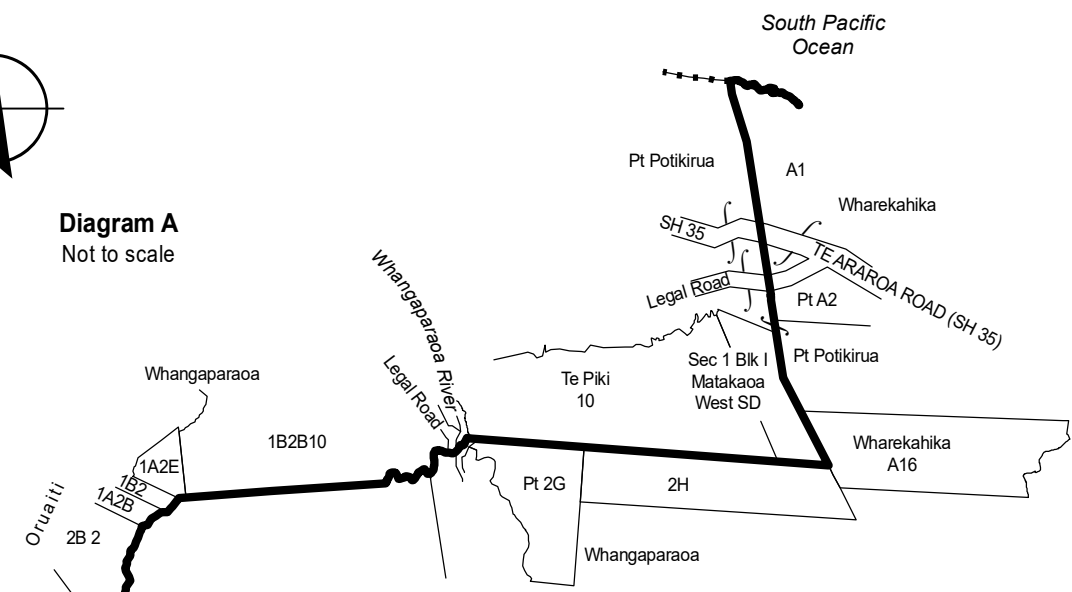
**GISBORNE DISTRICT**  
**TAIRĀWHITI GENERAL WARD**

TERRITORIAL AUTHORITY: Gisborne District  
Compiled by Jacobs New Zealand Limited  
Scale 1:700,000 at A3 Date: May 2022

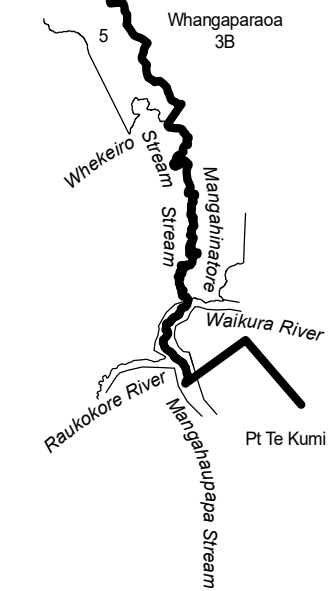
**LG-028-2022-W-2**  
Sheet 1 of 2



**Diagram A**  
Not to scale

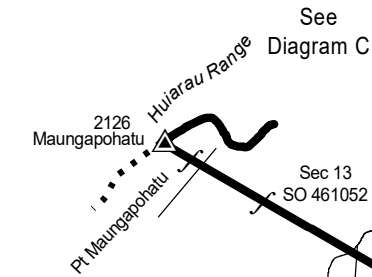


**TAIRĀWHITI GENERAL WARD**

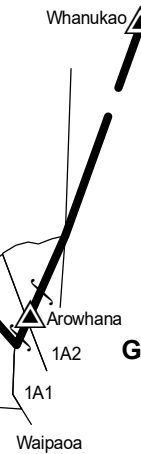


**Diagram B**  
Not to scale

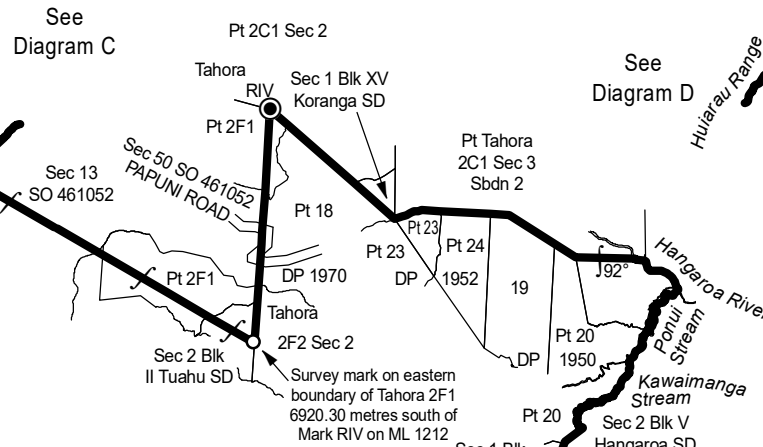
See Diagram C



**TAIRĀWHITI GENERAL WARD**



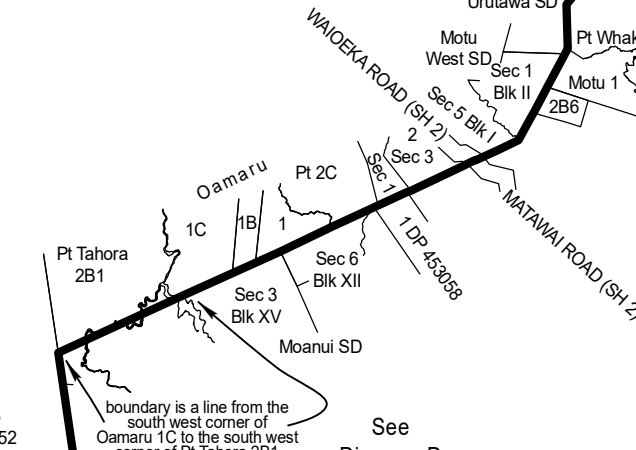
**Diagram D**  
Not to scale



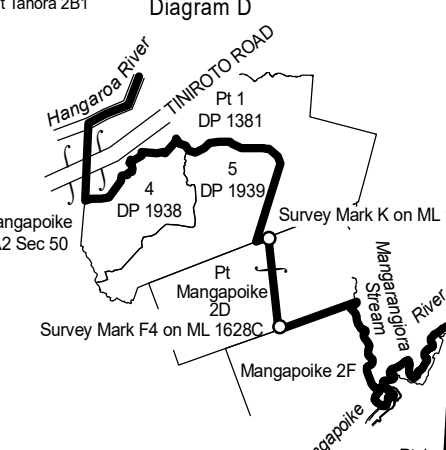
**TAIRĀWHITI GENERAL WARD**

See Diagram E

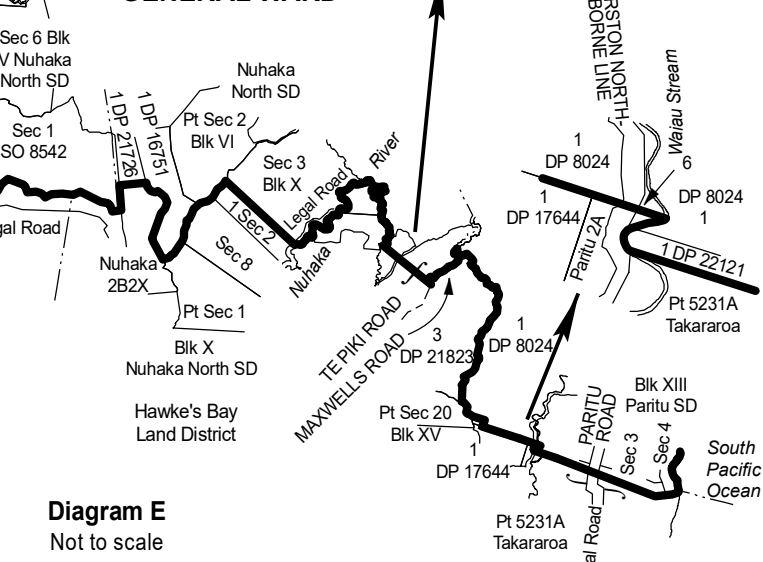
**Diagram C**  
Not to scale



**TAIRĀWHITI GENERAL WARD**

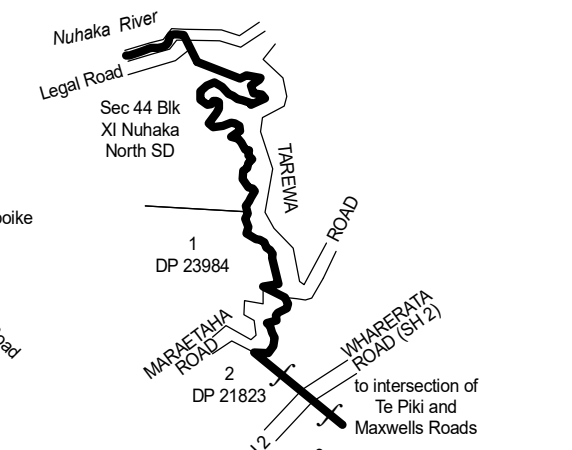


**TAIRĀWHITI GENERAL WARD**



**Diagram E**  
Not to scale

See Diagram B



Land District: Gisborne & Hawkes Bay

# **GISBORNE DISTRICT**

## **TAIRĀWHITI GENERAL WARD**

TERRITORIAL AUTHORITY: Gisborne District  
Compiled by Jacobs New Zealand Limited  
Not to scale Date: May 2022

**LG-028-2022-W-2**  
Sheet 2 of 2