

MALVERN WARD
LG-062-2022-W-2

HORNBY WARD
LG-060-2021-W-9

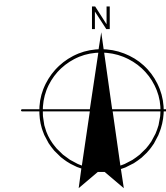

Notes:

1. Coordinates are in terms of New Zealand Transverse Mercator 2000 (NZTM).
2. Where a boundary is shown along a river or road it follows the middle line of the physical river or legal road unless otherwise shown.
3. Where a boundary is shown along a railway it follows the middle line of the cadastral railway unless otherwise shown.
4. All seaward boundaries follow the line of mean low water springs but cross the mouths of all rivers, streams, inlets and estuaries unless otherwise shown.

ROLLESTON WARD
LG-062-2022-W-3

HALSWELL WARD
LG-060-2021-W-10

SPRINGS WARD

BANKS PENINSULA WARD
LG-060-2016-W-17

ELLESMERE WARD
LG-062-2022-W-4

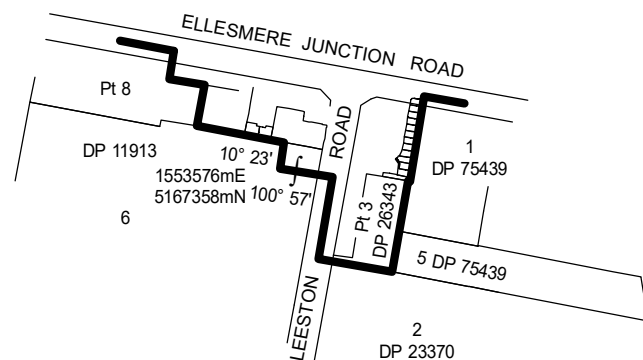

Diagram A
Not to Scale



Land District: Canterbury

SELWYN DISTRICT SPRINGS WARD

TERRITORIAL AUTHORITY: Selwyn District

Compiled by Jacobs New Zealand Limited

Scale 1:100,000 at A3

Date: August 2022

LG-062-2022-W-5