

Notes:

1. Coordinates are in terms of New Zealand Transverse Mercator 2000 (NZTM).
2. Where a boundary is shown along a river or road it follows the middle line of the physical river or legal road unless otherwise shown.
3. Where a boundary is shown along a railway it follows the middle line of the cadastral railway unless otherwise shown.
4. All seaward boundaries follow the line of mean low water springs but cross the mouths of all rivers, streams, inlets and estuaries unless otherwise shown.

Diagram A
Not to Scale

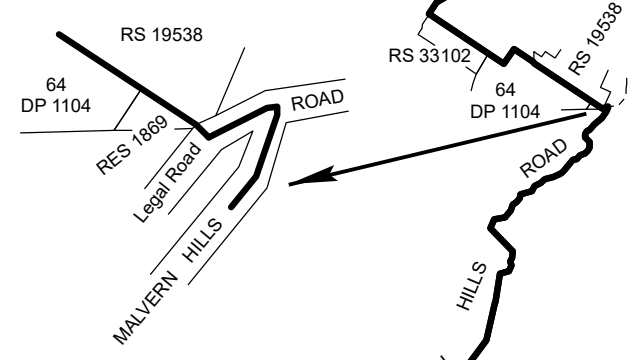

Diagram D
Not to Scale

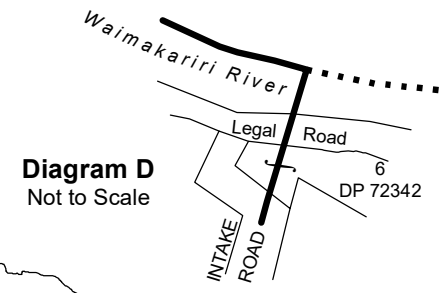

Diagram B
Not to Scale

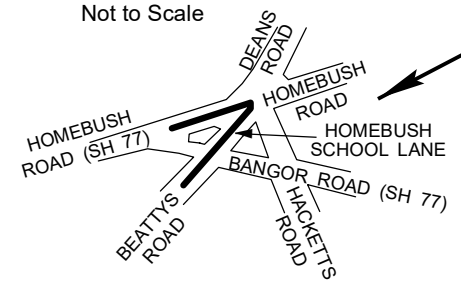
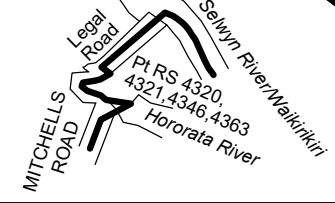

Diagram C
Not to Scale



HAWKINS SUBDIVISION

**WEST MELTON SUBDIVISION
LG-062-2022-S-3**

**TAWERA SUBDIVISION
LG-062-2022-S-1**



Land District: Canterbury

SELWYN DISTRICT HAWKINS SUBDIVISION

TERRITORIAL AUTHORITY: Selwyn District
 Compiled by Jacobs New Zealand Limited
 Scale 1:130,000 at A3 Date: August 2022

LG-062-2022-S-2