

WAIMAIRI WARD  
LG-060-2021-W-3

FENDALTON WARD  
LG-060-2021-W-5

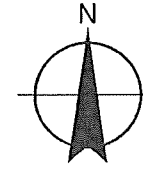

- Notes:
1. Coordinates are in terms of New Zealand Transverse Mercator 2000 (NZTM).
  2. Where a boundary is shown along a river or road it follows the middle line of the physical river or legal road unless otherwise shown.
  3. Where a boundary is shown along a railway it follows the middle line of the cadastral railway unless otherwise shown.
  4. All seaward boundaries follow the line of mean low water springs but cross the mouths of all rivers, streams, inlets and estuaries unless otherwise shown.

# RICCARTON WARD

CENTRAL WARD  
LG-060-2021-W-13

SPREYDON WARD  
LG-060-2021-W-12

HORNBY WARD  
LG-060-2021-W-9

HALSWELL WARD  
LG-060-2021-W-10

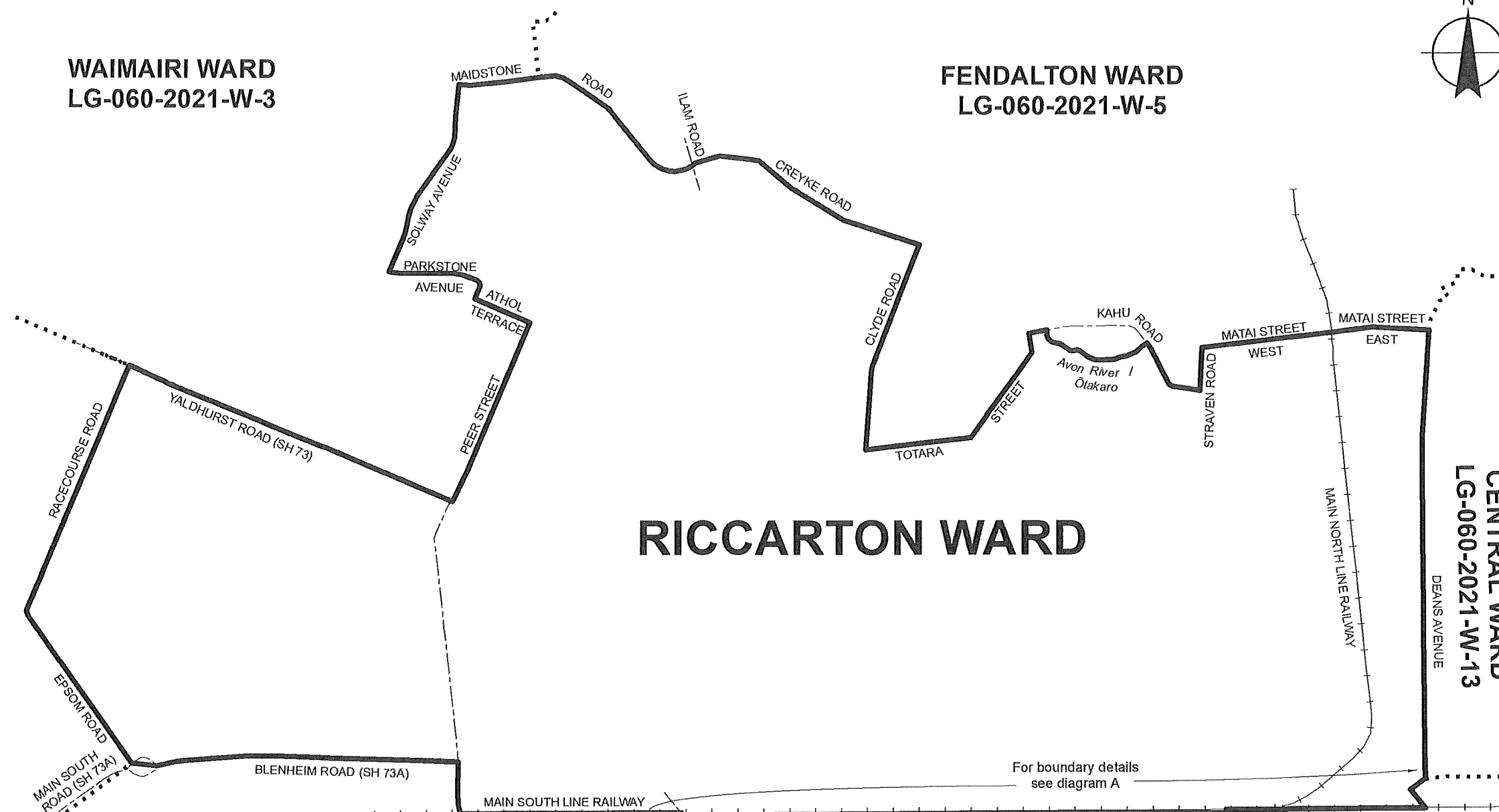

For boundary details see diagram A

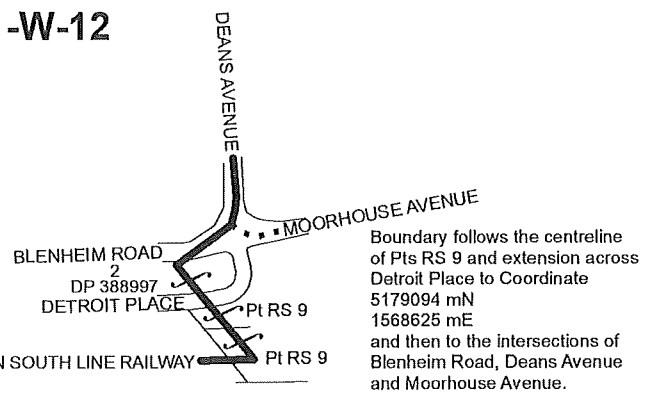
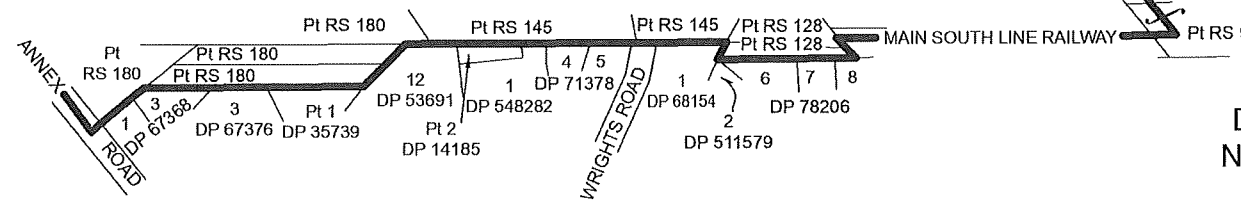

Boundary follows the centreline of Pts RS 9 and extension across Detroit Place to Coordinate 5179094 mN 1568625 mE and then to the intersections of Blenheim Road, Deans Avenue and Moorhouse Avenue.

Diagram A  
Not to Scale

Land District: Canterbury

## CHRISTCHURCH CITY RICCARTON WARD

TERRITORIAL AUTHORITY: Christchurch City  
Compiled by Jacobs New Zealand Limited

LG-060-2021-W-11

Scale 1:18,000 at A3 Date: May 2022