

SO 424034 (Title Pla

Cpy - 01/01, Pgs - 001, 03/12/09, 14

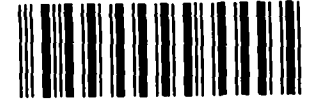

DocID: 212492146



Approvals  
Where a boundary is shown along a river or road it follows the middle line of the physical river or legal road unless otherwise shown.

Where a boundary is shown along a railway it follows the middle line of the cadastral railway unless otherwise shown.

All seaward boundaries follow the line of mean low water springs but cross the mouths of all rivers, inlets and estuaries except where otherwise shown.

All adjacent islands and islets are included in the Region.

Certified by the Local Government Commission that the boundary shown hereon is the same as the determination dated 24.11.09 pursuant to section 19R(1)(b) Local Electoral Act 2001.

*[Signature]* 24.11.09  
Chief Executive Officer  
Local Government Commission

I certify that this plan renders the boundary capable of identification under section 19Y(3)(b) Local Electoral Act 2001.

*[Signature]* 4.12.2009  
for Surveyor General

Total Area

Comprised in:

I, being a person entitled to practise as a licensed cadastral surveyor, certify that -

- (a) The Surveys to which this dataset relates are accurate, and were undertaken by me or under my direction in accordance with the Cadastral Survey Act 2002 and the Surveyor-General's Rules for Cadastral Survey 2002/2.
- (b) This dataset is accurate, and has been created in accordance with that Act and those Rules

Field Book - p. - Traverse Book - p. -  
Reference Plans

Examined ..... Correct .....

Approved as to Gazettal Purposes  
by Land Information NZ

.....

Deposited this... day of .....

..... for Registrar-General of Land

File AE03794  
Received  
Instructions: **SO 424034**

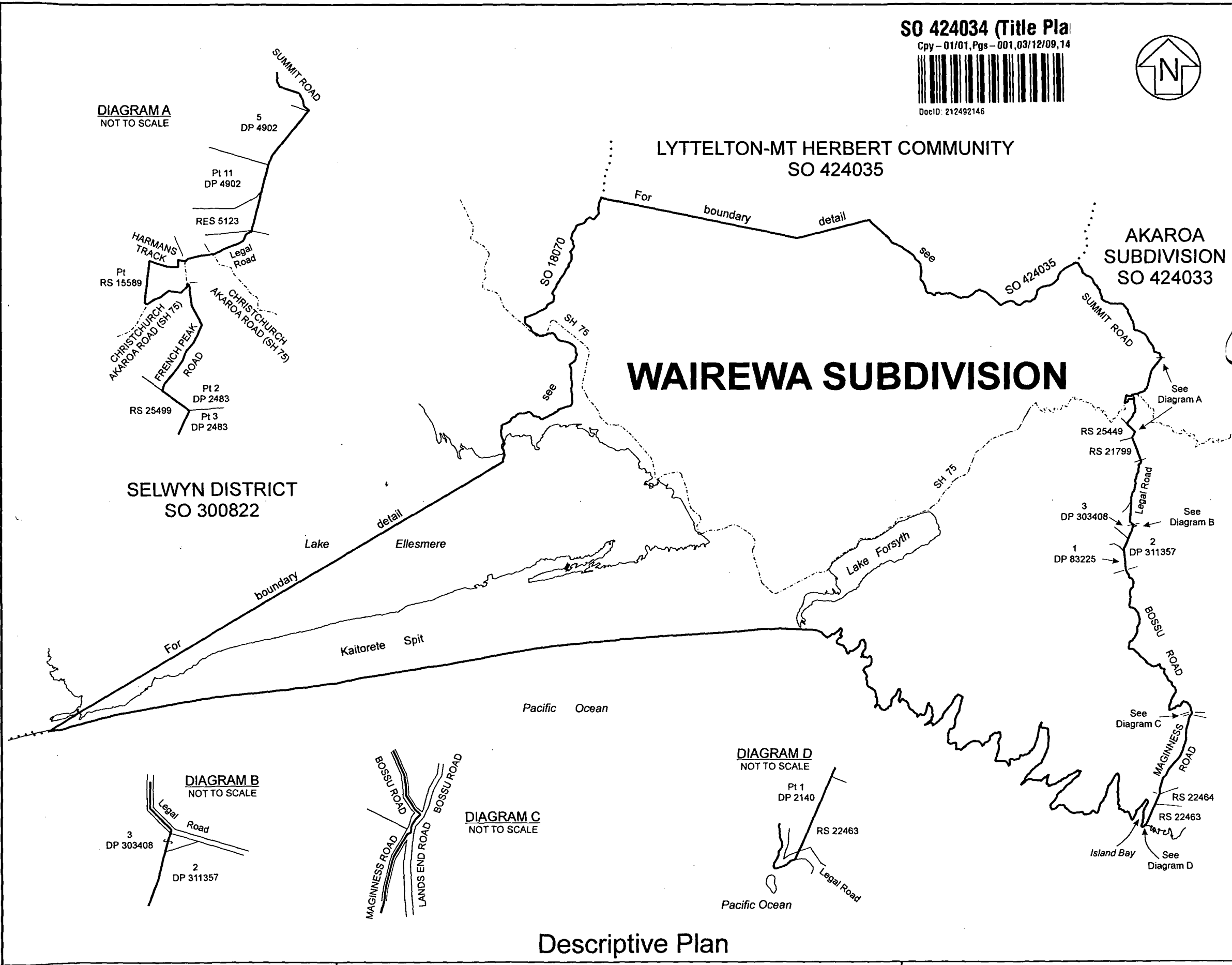
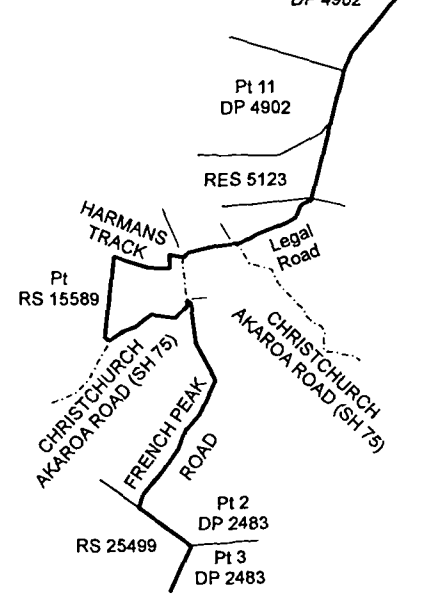

DIAGRAM A  
NOT TO SCALE



SELWYN DISTRICT  
SO 300822

DIAGRAM B  
NOT TO SCALE

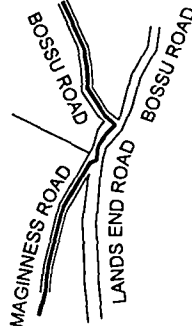
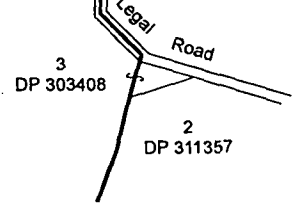
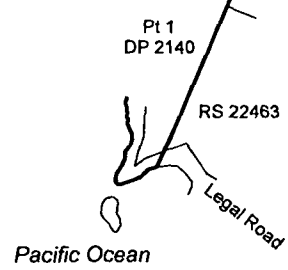

DIAGRAM C  
NOT TO SCALE

DIAGRAM D  
NOT TO SCALE



### Descriptive Plan

Land District : Canterbury

## WAIREWA SUBDIVISION

TERRITORIAL AUTHORITY: Christchurch City  
Compiled by Sinclair Knight Merz Ltd  
Scale 1:100000 Date September 2009