

- Notes:
1. Coordinates are in terms of New Zealand Transverse Mercator 2000 (NZTM).
  2. All seaward boundaries follow Mean Low Water Springs but cross the mouths of all rivers, streams, inlets and estuaries except where shown otherwise.
  3. Where a boundary is shown along a river or road it follows the middle line of the physical river or legal road unless otherwise shown.

Land District: South Auckland

**WESTERN BAY OF PLENTY DISTRICT**  
**KAIMAI WARD**

TERRITORIAL AUTHORITY: Western Bay of Plenty District  
 Compiled by Jacobs New Zealand Limited  
 Scale 1:200,000 at A3 Date: July 2019

**LG-022-2019-W-3**  
 Sheet 1 of 3

Notes:

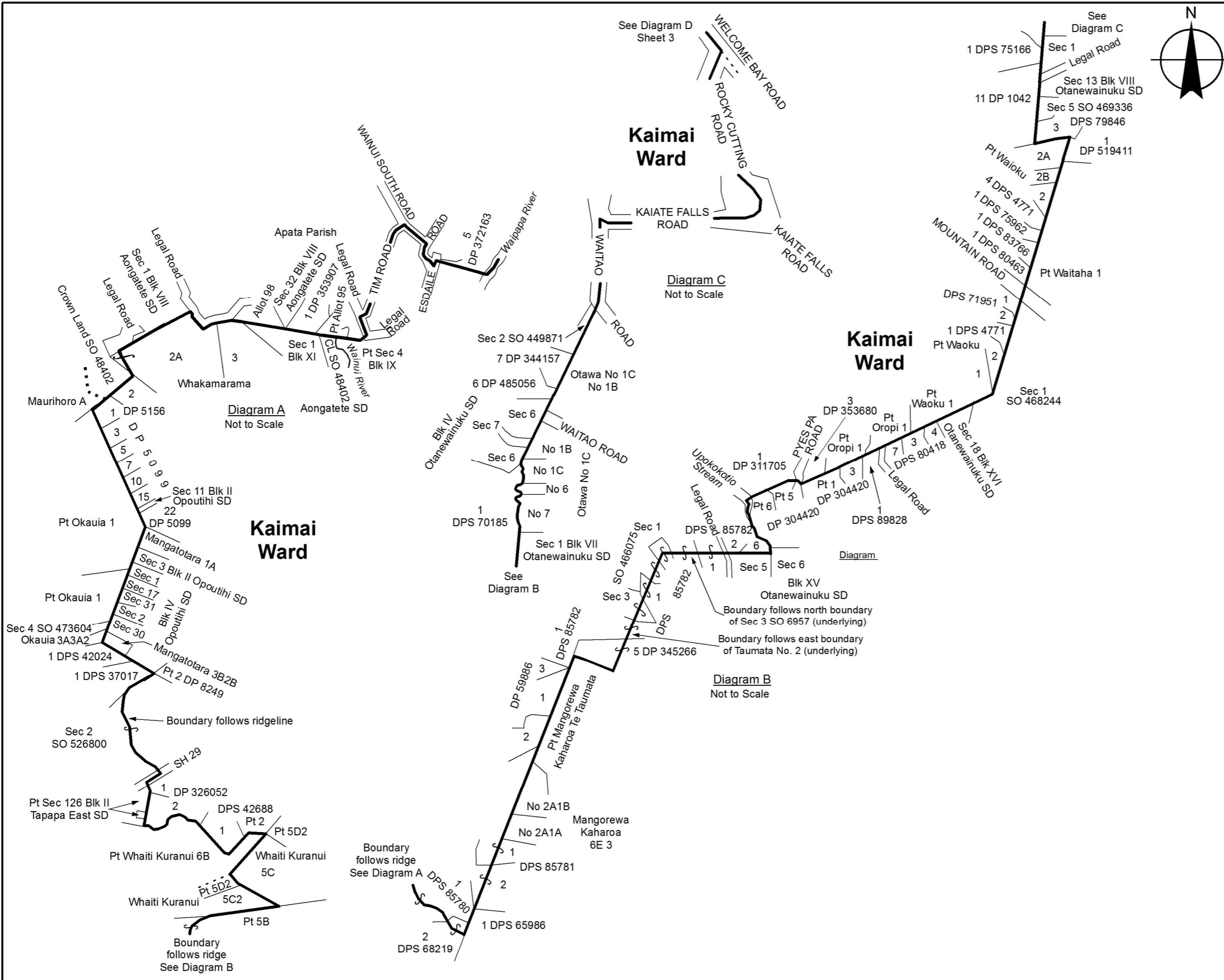

Land District: South Auckland

# WESTERN BAY OF PLENTY DISTRICT KAIMAI WARD

TERRITORIAL AUTHORITY: Western Bay of Plenty District  
Compiled by Jacobs New Zealand Limited  
Not to scale Date: July 2019

LG-022-2019-W-3

Sheet 2 of 3

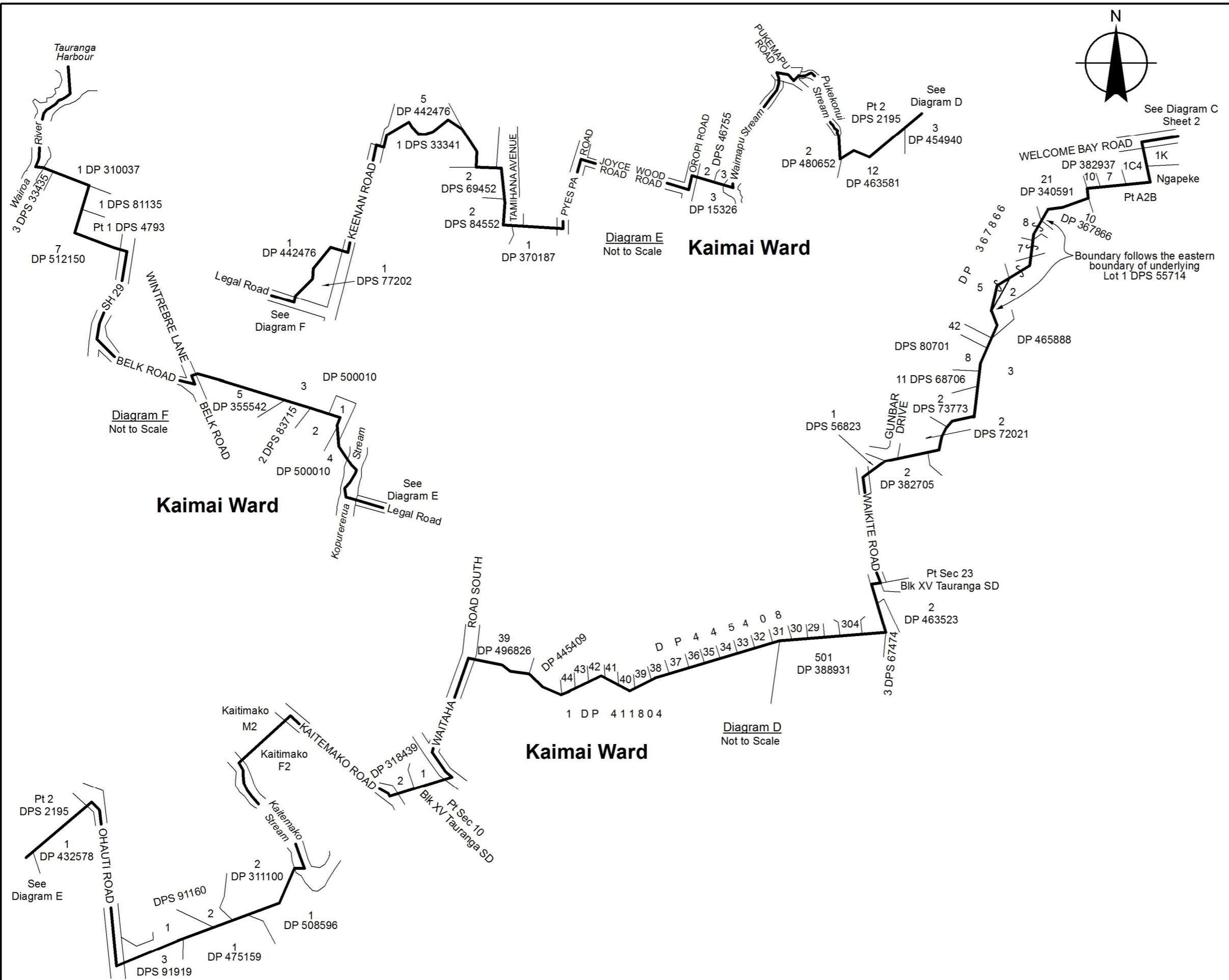

Notes:

Land District: South Auckland

## WESTERN BAY OF PLENTY DISTRICT KAIMAI WARD

TERRITORIAL AUTHORITY: Western Bay of Plenty District  
 Compiled by Jacobs New Zealand Limited  
 Not to Scale Date: July 2019

**LG-022-2019-W-3**  
 Sheet 3 of 3

File IZ049800