

Notes:

1. Coordinates are in terms of New Zealand Transverse Mercator 2000 (NZTM).
2. All seaward boundaries follow mean low water springs but cross the mouths of all rivers, streams, inlets and estuaries unless otherwise shown.
3. Where a boundary is shown along a river or road it follows the middle line of the physical river or legal road unless otherwise shown.
4. Where a boundary is shown along a railway it follows the middle line of the cadastral railway unless otherwise shown.

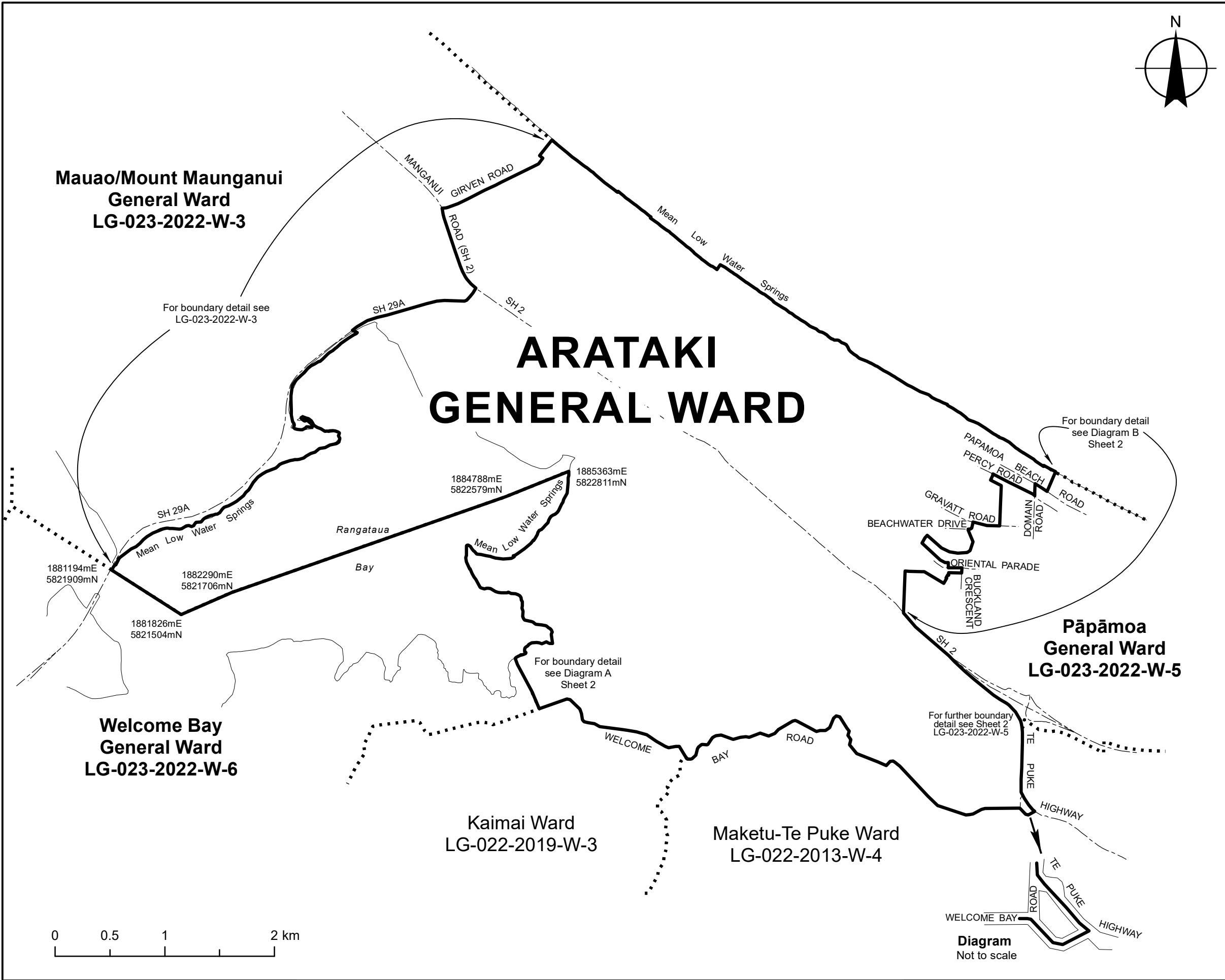

Land District: South Auckland

**TAURANGA CITY**  
**ARATAKI GENERAL WARD**

TERRITORIAL AUTHORITY: Tauranga City  
 Compiled by Jacobs New Zealand Limited  
 Scale 1:35,000 at A3 Date: August 2022

**LG-023-2022-W-4**  
 Sheet 1 of 2

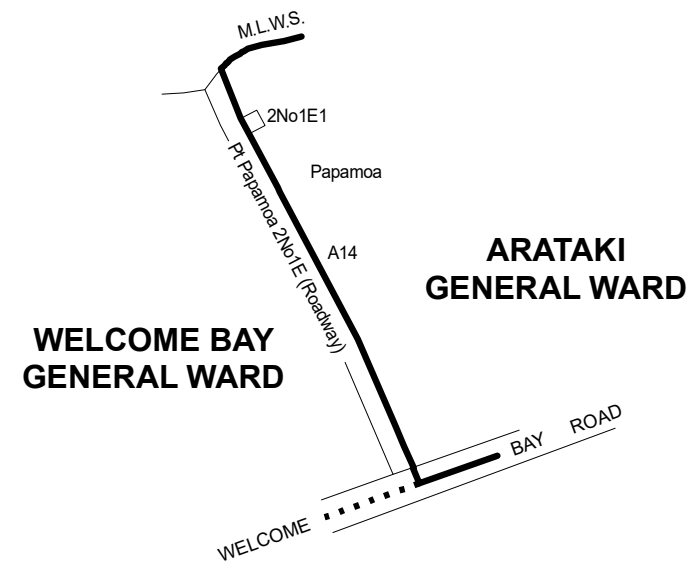
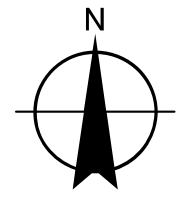

**Diagram A**  
Not to scale

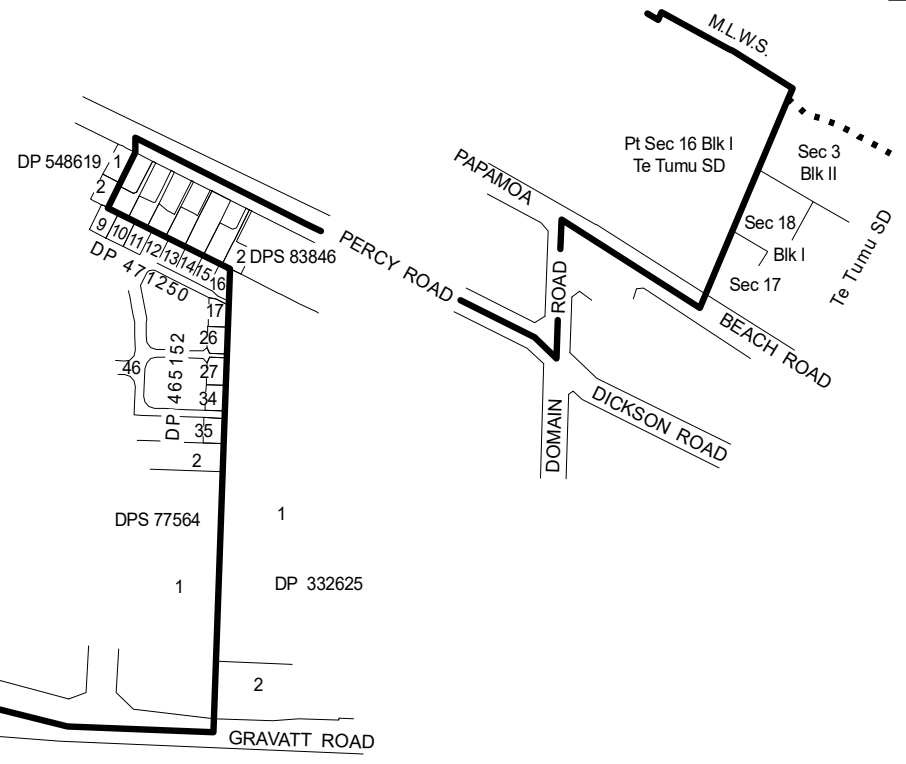

**Diagram B**  
Not to scale

Land District: South Auckland

# TAURANGA CITY ARATAKI GENERAL WARD

TERRITORIAL AUTHORITY: Tauranga City  
 Compiled by Jacobs New Zealand Limited  
 Not to scale Date: August 2022

**LG-023-2022-W-4**  
Sheet 2 of 2