

- Notes:
1. Coordinates are in terms of New Zealand Transverse Mercator 2000 (NZTM).
  2. All seaward boundaries follow mean low water springs but cross the mouths of all rivers, streams, inlets and estuaries unless otherwise shown.
  3. Where a boundary is shown along a river or road it follows the middle line of the physical river or legal road unless otherwise shown.
  4. Where a boundary is shown along a railway it follows the middle line of the cadastral railway unless otherwise shown.

Land District: South Auckland

**TAURANGA CITY**  
**TAURIKO GENERAL WARD**

TERRITORIAL AUTHORITY: Tauranga City  
Compiled by Jacobs New Zealand Limited  
Scale 1:35,000 at A3 Date: August 2022

**LG-023-2022-W-10**  
Sheet 1 of 2

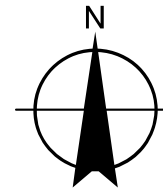

**Diagram C**  
Not to scale

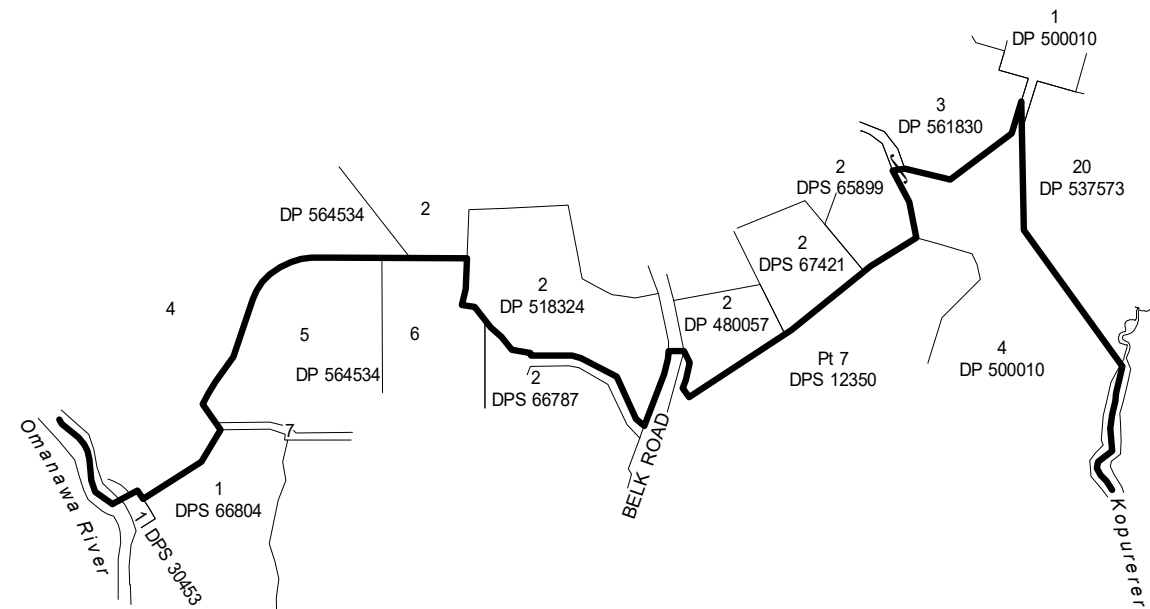

**TAURIKO  
GENERAL WARD**

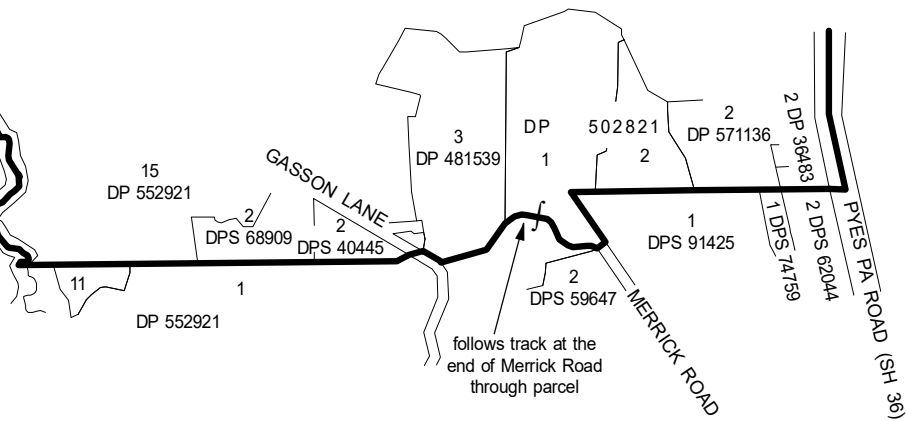

**TAURIKO  
GENERAL WARD**

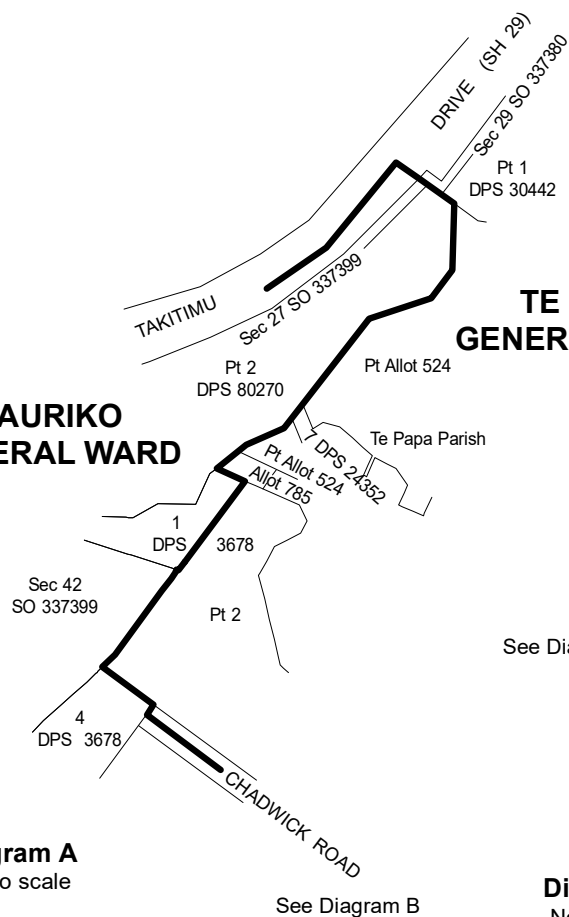

**TE PAPA  
GENERAL WARD**

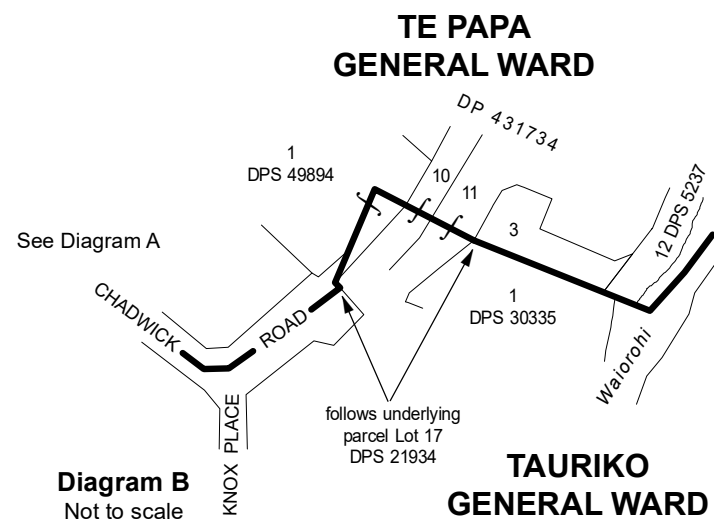

**TE PAPA  
GENERAL WARD**

**TAURIKO  
GENERAL WARD**

Land District: South Auckland

**TAURANGA CITY  
TAURIKO GENERAL WARD**

TERRITORIAL AUTHORITY: Tauranga City

Compiled by Jacobs New Zealand Limited

Not to scale

Date: August 2022

**LG-023-2022-W-10**

Sheet 2 of 2