

WAITĀKERE WARD
LGC-AK-W4

NORTH SHORE WARD
LGC-AK-W3

WAITEMATĀ AND GULF WARD
LG-076-2019-W-3

ŌRAKEI WARD
LG-076-2019-W-4

ALBERT-EDEN-
PUKETĀPAPA WARD

WHAU WARD
LGC-AK-W5

MAUNGAKIEKIE-
TĀMAKI WARD
LG-076-2019-W-5

WAITĀKERE WARD
LGC-AK-W4

MANUKAU WARD
LGC-AK-W10

FRANKLIN WARD
LGC-AK-W13

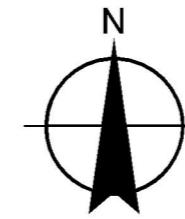

Notes:

1. Coordinates are in terms of New Zealand Transverse Mercator 2000 (NZTM).
2. Where a boundary is shown along a river or road it follows the middle line of the physical river or legal road unless otherwise shown.
3. Where a boundary is shown along a railway it follows the middle line of the cadastral railway unless otherwise shown.

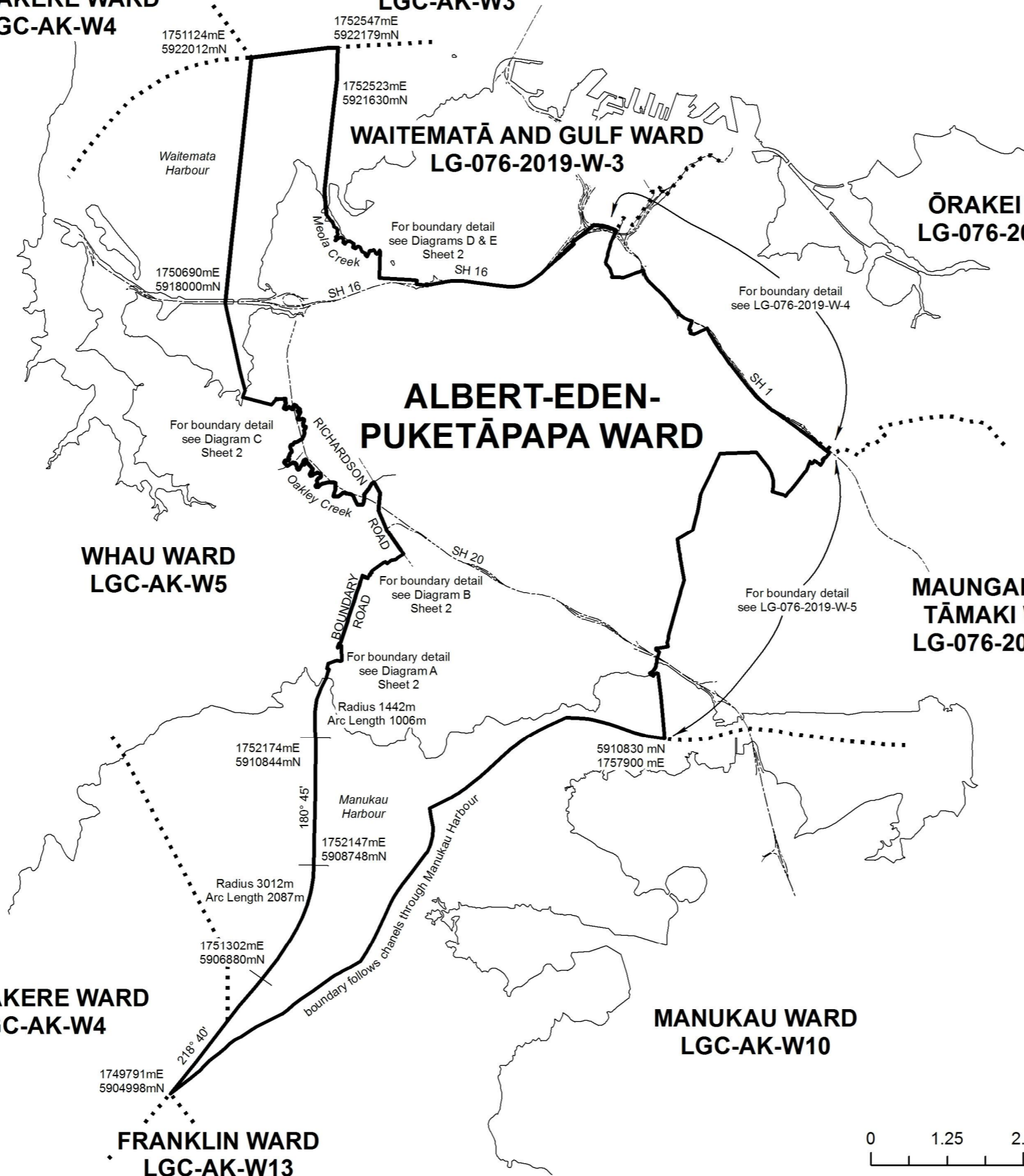

Land District: North Auckland

AUCKLAND ALBERT-EDEN-PUKETĀPAPA WARD

TERRITORIAL AUTHORITY: Auckland

Compiled by Jacobs New Zealand Limited

Scale 1:80,000 at A3

Date: August 2019

LG-076-2019-W-2
Sheet 1 of 2

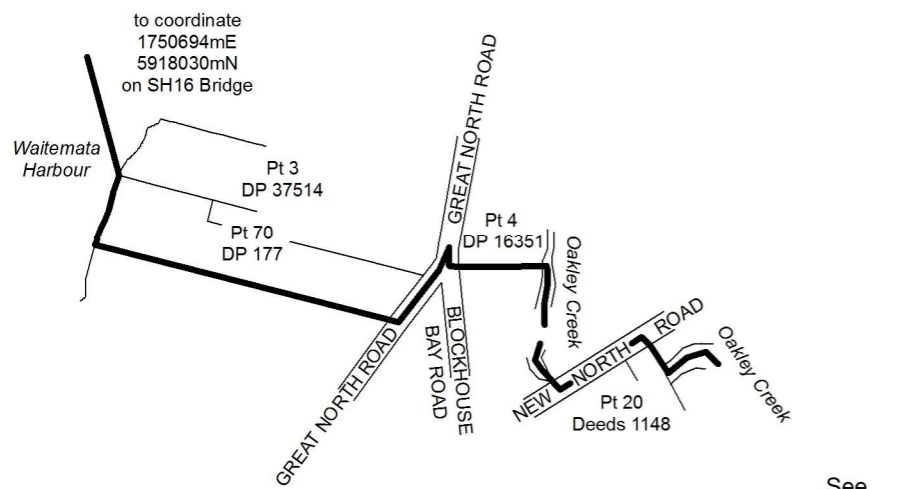

Diagram C
Not to Scale

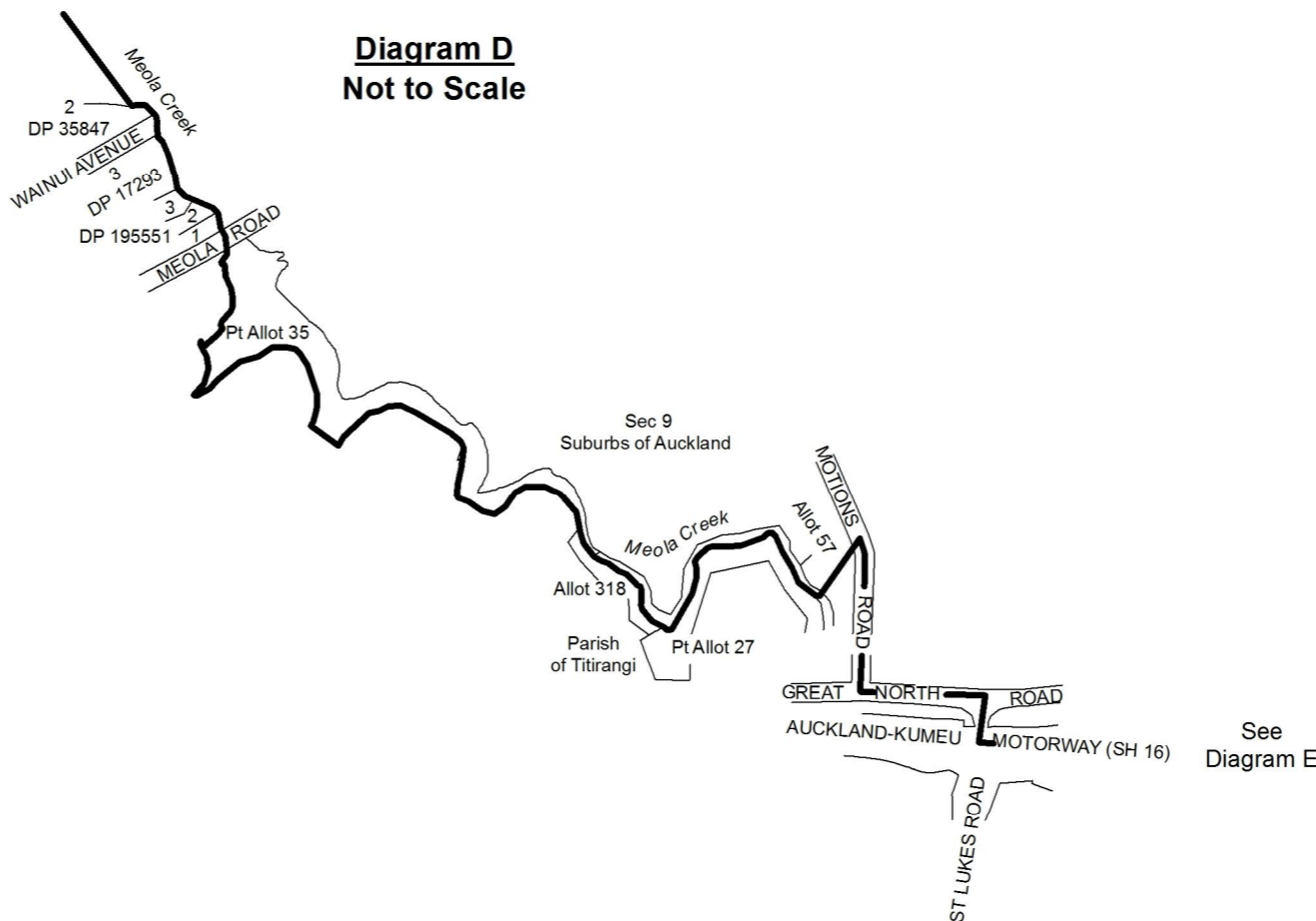
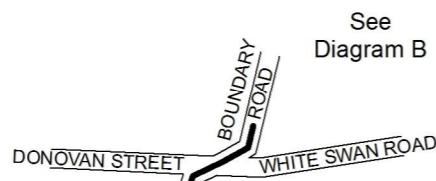

Diagram D
Not to Scale



See Diagram B

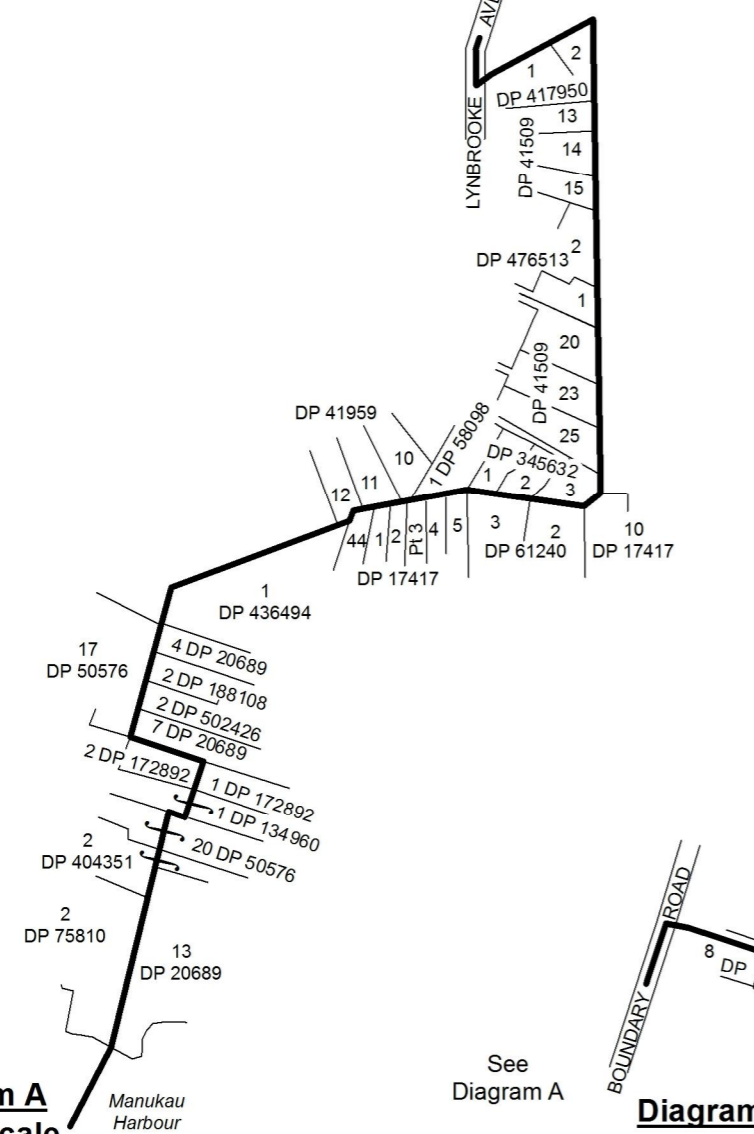

Diagram A
Not to Scale

See Diagram A

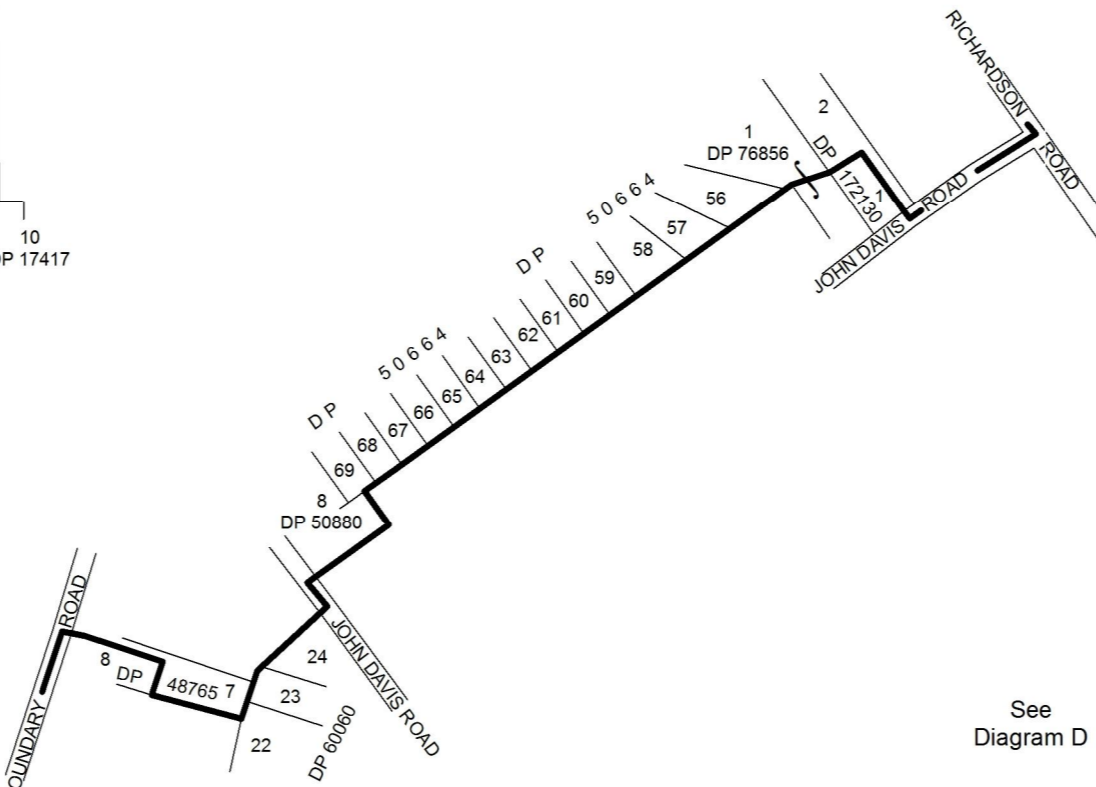
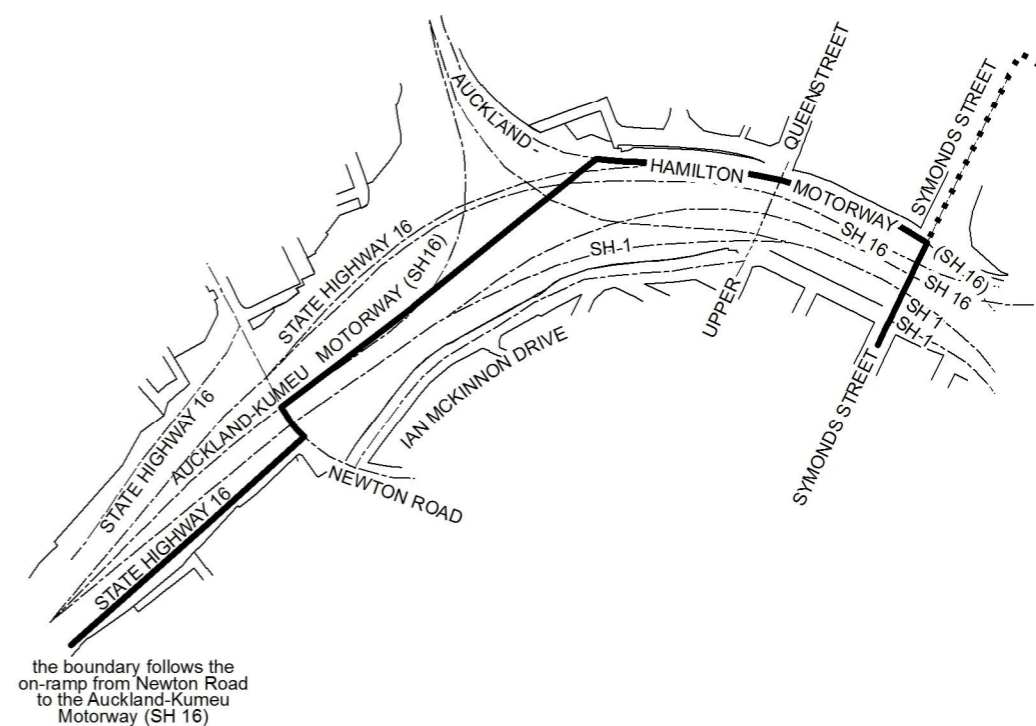

Diagram B
Not to Scale

See Diagram D

Diagram E
Not to Scale



the boundary follows the on-ramp from Newton Road to the Auckland-Kumeu Motorway (SH 16)

Land District: North Auckland

AUCKLAND ALBERT-EDEN-PUKETĀPAPA WARD

TERRITORIAL AUTHORITY: Auckland

Compiled by Jacobs New Zealand Limited

Not to scale

Date: August 2019

LG-076-2019-W-2
Sheet 2 of 2