

- Notes:
1. Coordinates are in terms of New Zealand Transverse Mercator 2000 (NZTM).
 2. Where a boundary is shown along a river or road it follows the middle line of the physical river or legal road unless otherwise shown.
 3. Where a boundary is shown along a railway it follows the middle line of the cadastral railway unless otherwise shown.
 4. The seaward boundary is the outer limits of the Territorial Sea as defined by Section 3 of the Territorial Sea and Exclusive Economic Zone Act 1977.

Land District: North Auckland

File IZ049800

AUCKLAND
WARKWORTH SUBDIVISION

TERRITORIAL AUTHORITY: Auckland
Compiled by Jacobs New Zealand Limited
Scale 1:200,000 at A3 Date: August 2019

LG-076-2019-S-2
Sheet 1 of 2

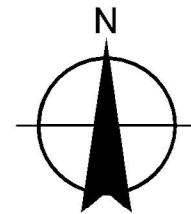

Diagram C
Not to Scale

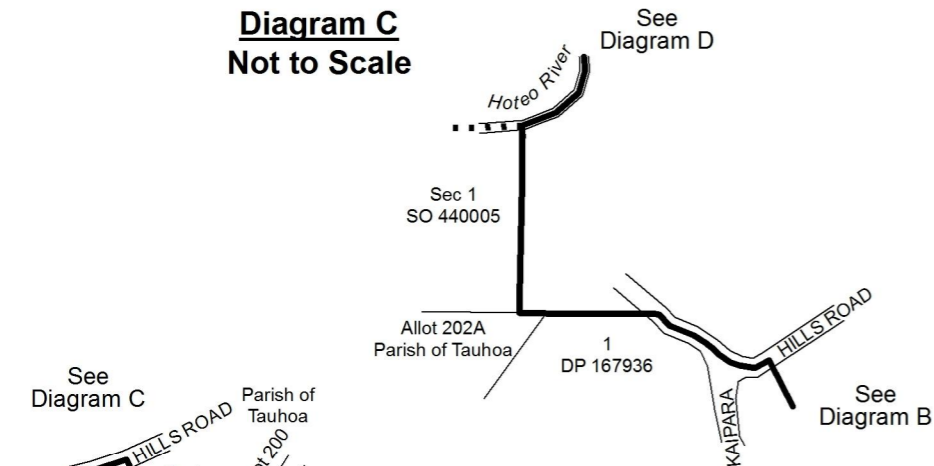

Diagram D
Not to Scale

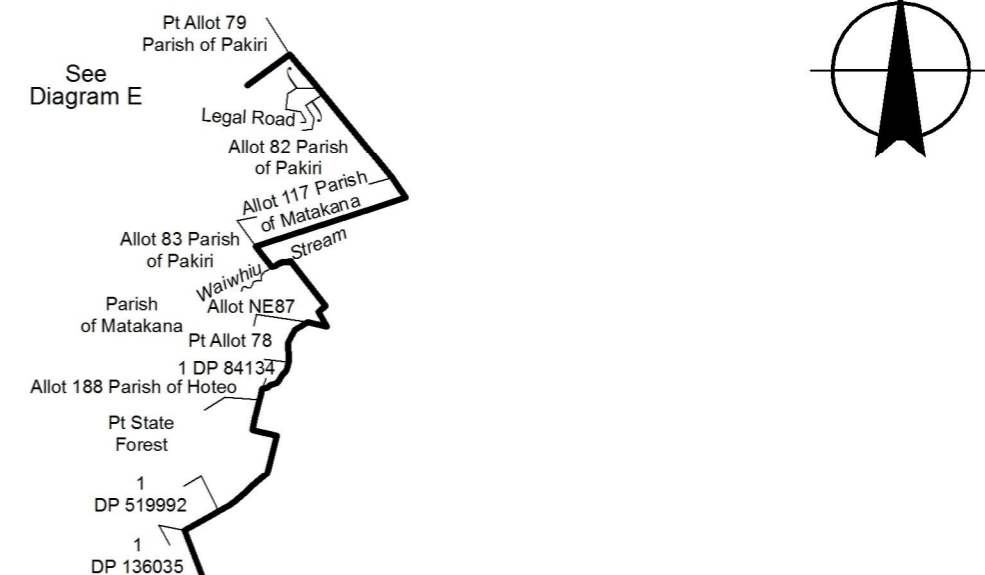

Diagram B
Not to Scale

Diagram A
Not to Scale

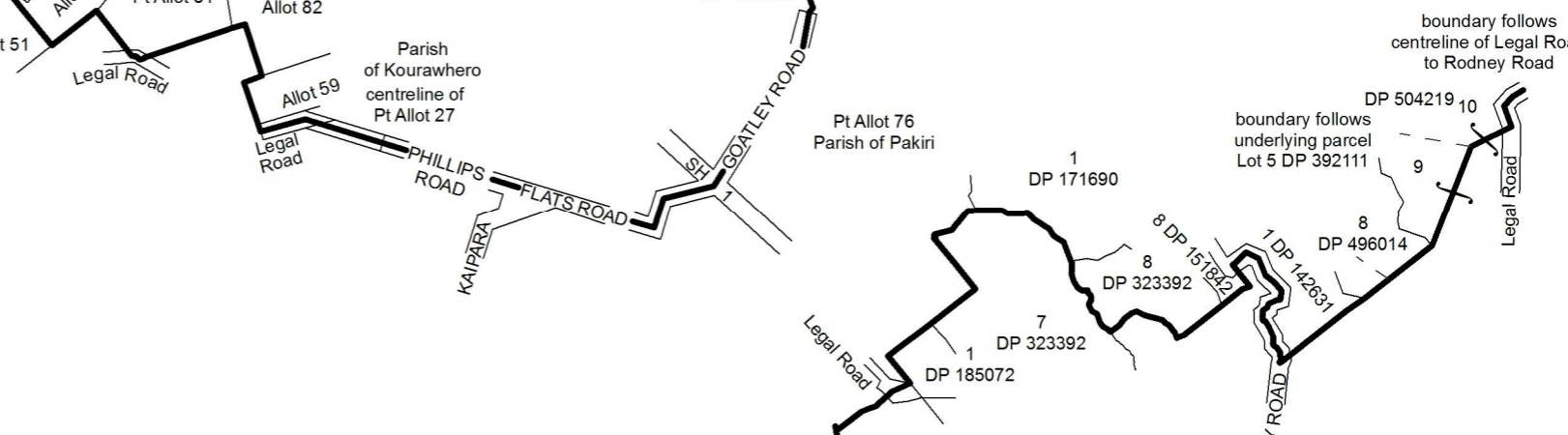
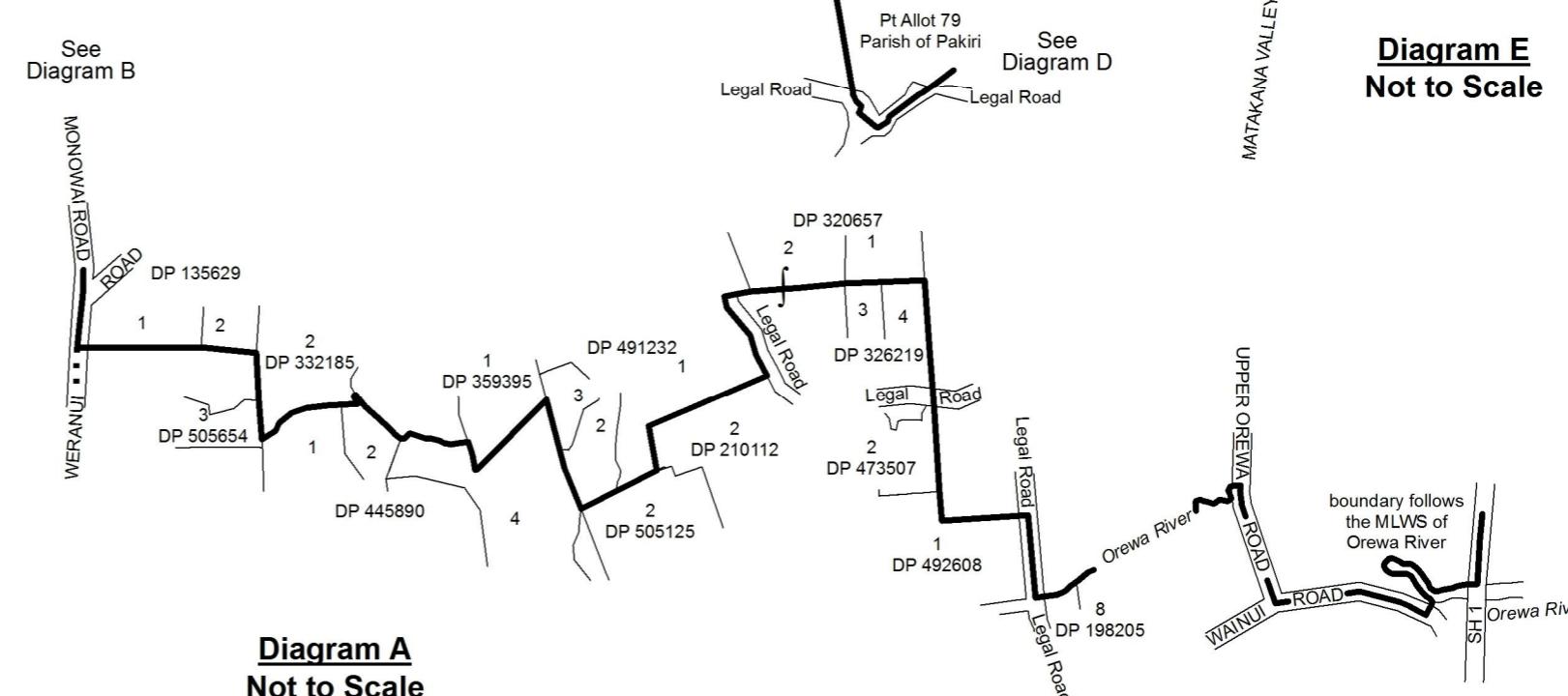

Diagram E
Not to Scale



Land District: North Auckland

AUCKLAND WARKWORTH SUBDIVISION

TERRITORIAL AUTHORITY: Auckland
Compiled by Jacobs New Zealand Limited
Not to Scale Date: August 2019

LG-076-2019-S-2
Sheet 2 of 2